

# CLARK COUNTY FOREST

## Firewood Permit Area 1-24

Pt. of NENW, NWNE, NENE, SWNE Section 20

Pt. of SWNW Section 21

Township 23N Range 1E (Sherwood)



Firewood Permit Area. May harvest trim, cull pieces, and non-merchantable logging debris. Do not cut any standing trees (alive or dead), pulpwood, logs, or downed timber 8 feet or longer.

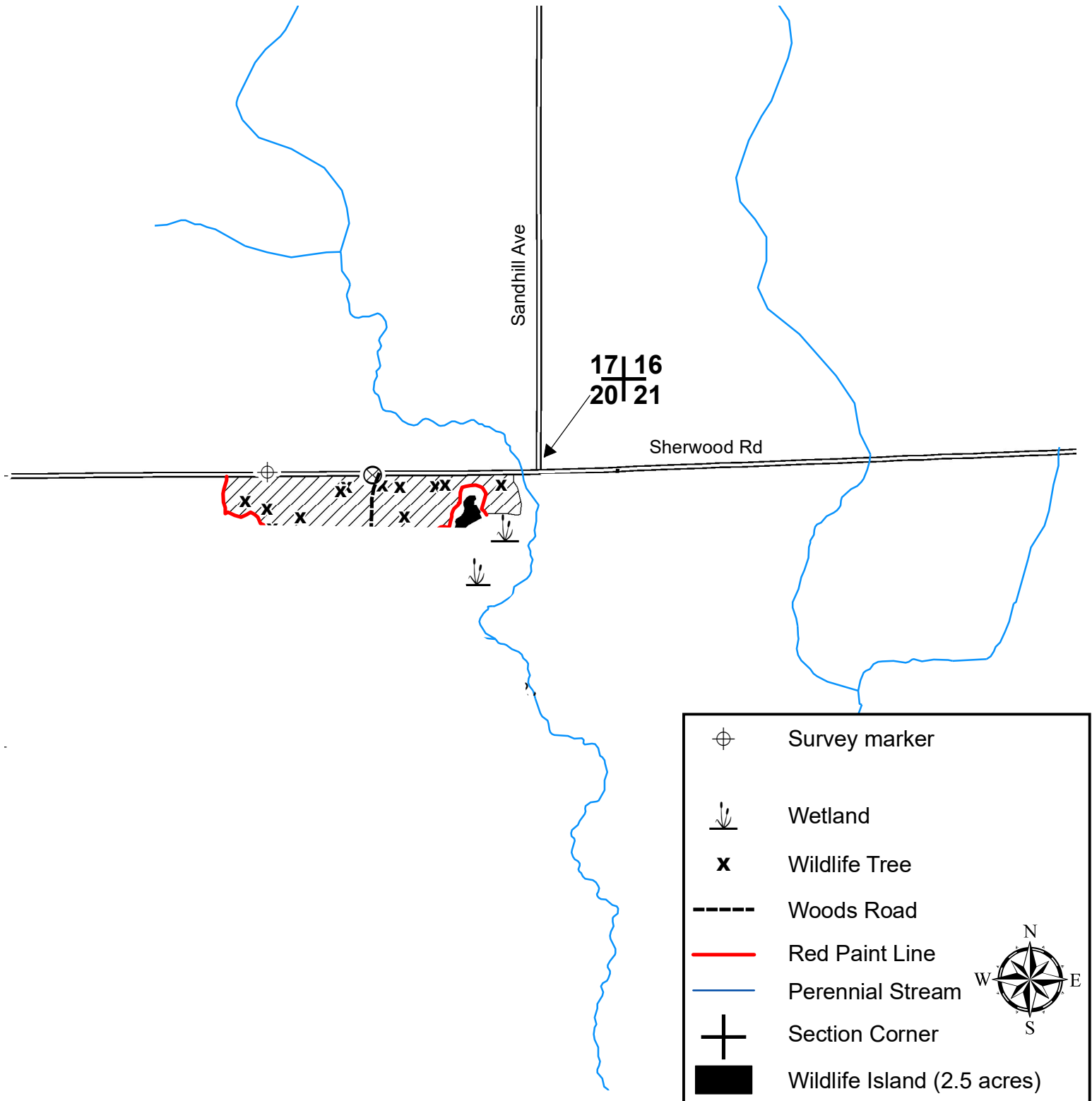

# CLARK COUNTY FOREST Firewood Permit Area 2-24

Pt. of SWNW, NWSE, Section 16

Pt. of NESE, SENE, Section 17

Township 25N Range 4W (South Foster)



Firewood Permit Area. May harvest trim, cull pieces, and non-merchantable logging debris. Do not cut any standing trees (alive or dead), pulpwood, logs, or downed timber 8 feet or longer.

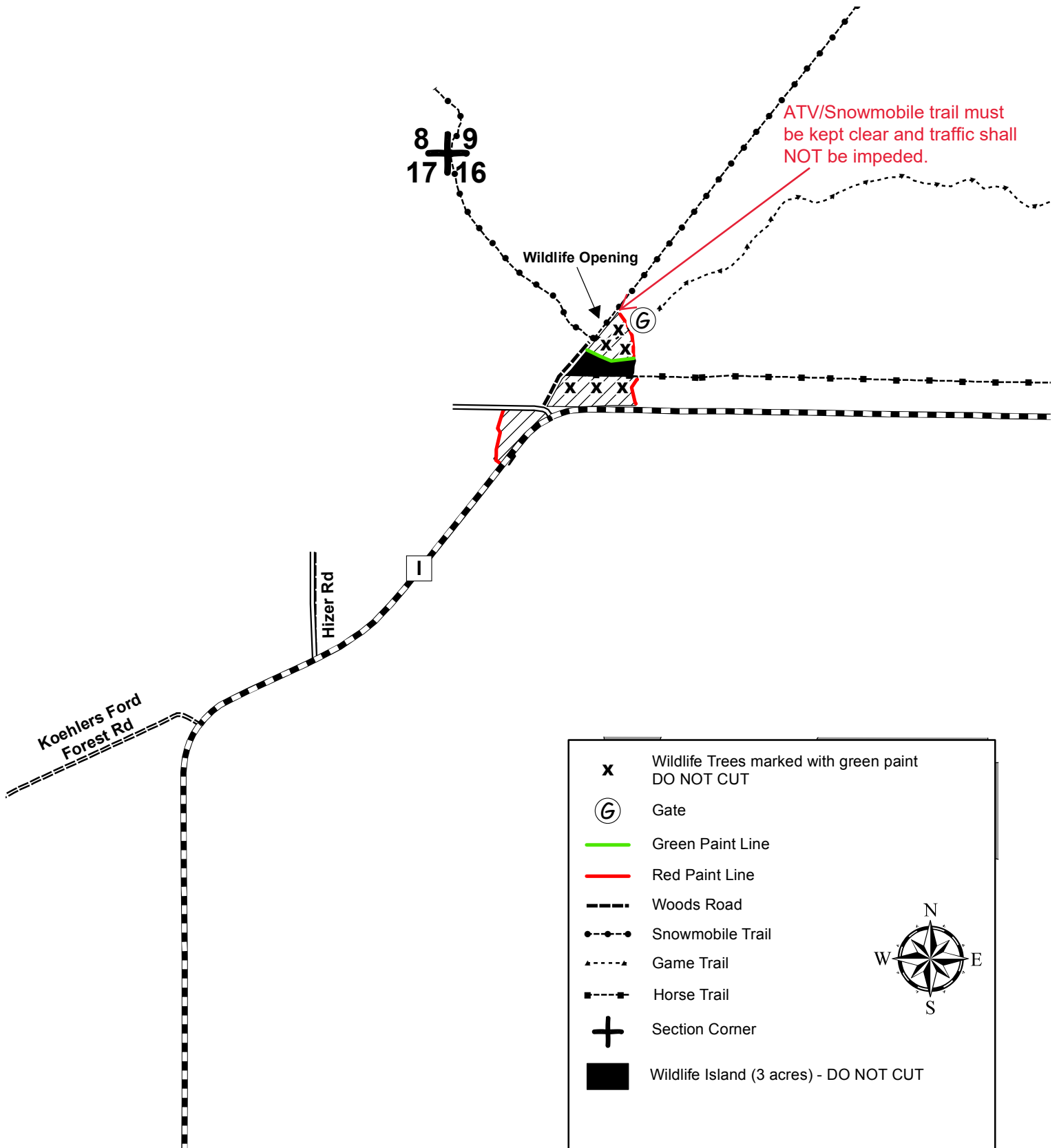

ATV/Snowmobile trail must be kept clear and traffic shall NOT be impeded.

8 + 9  
17 + 16

Wildlife Opening

G

Hizer Rd

Koehlers Ford Forest Rd

x	Wildlife Trees marked with green paint DO NOT CUT
G	Gate
—	Green Paint Line
—	Red Paint Line
---	Woods Road
.....	Snowmobile Trail
-.-.-.-	Game Trail
- - - - -	Horse Trail
+	Section Corner
■	Wildlife Island (3 acres) - DO NOT CUT

# CLARK COUNTY FOREST

## Firewood Permit Area 3-24

Pt. of NENW, NWNE, SENW, SWNE, NESE, SESE Section 21  
Township 23N Range 3W (Dewhurst)



Firewood Permit Area. May harvest trim, cull pieces, and non-merchantable logging debris. Do not cut any standing trees (alive or dead), pulpwood, logs, or downed timber 8 feet or longer.

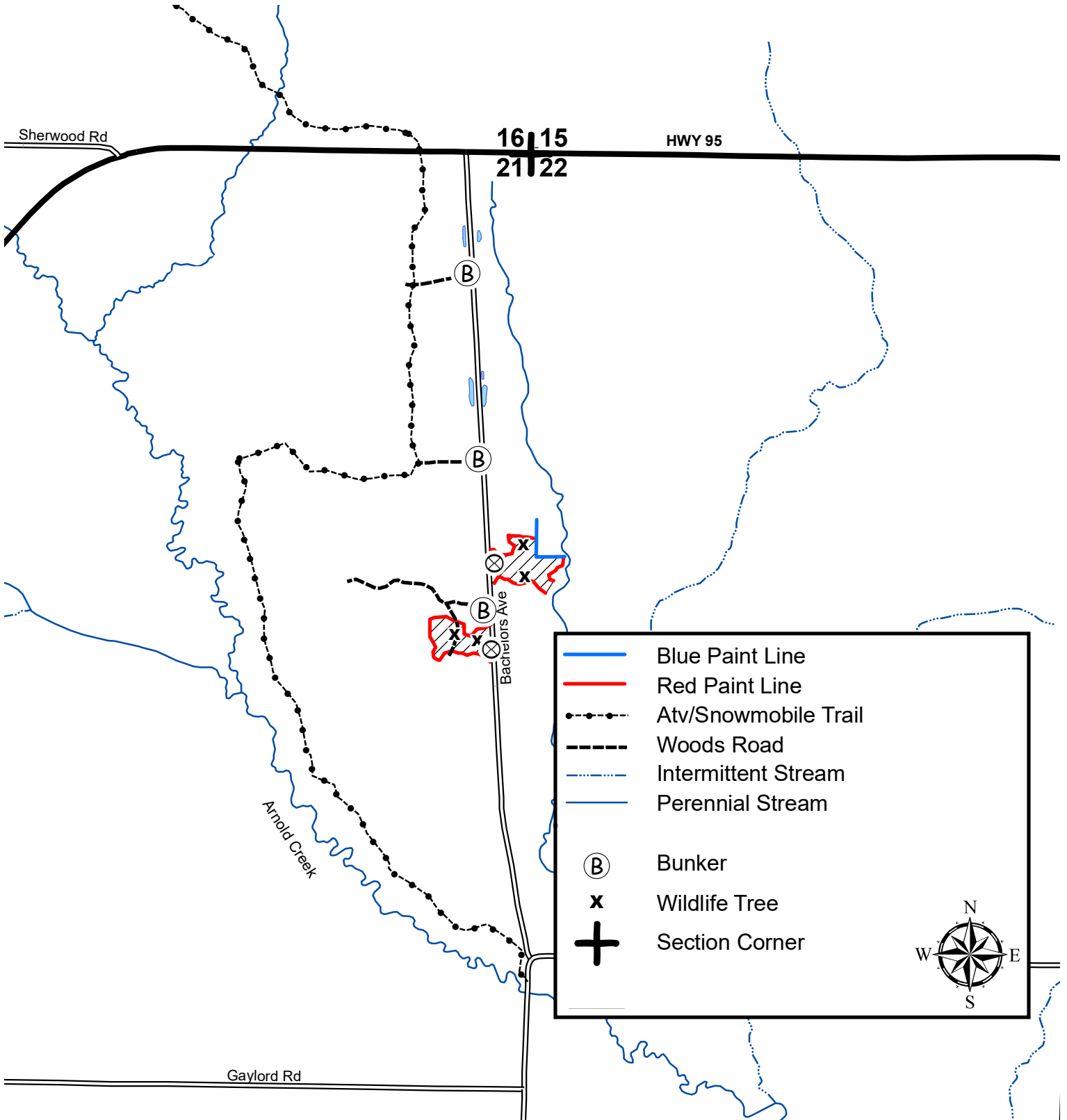

**CLARK COUNTY FOREST**  
**Firewood Permit Area 4-24**  
 Pt. of SE1/4 Section 35,  
 N1/2 SW1/4, NWSE Section 36  
 Township 25N Range 4W (South Foster)  
 NENW, N1/2 NE 1/4 Section 2  
 Township 24N Range 4W (Mentor)



Firewood Permit Area. May harvest trim, cull pieces, and non-merchantable logging debris. Do not cut any standing trees (alive or dead), pulpwood, logs, or downed timber 8 feet or longer.

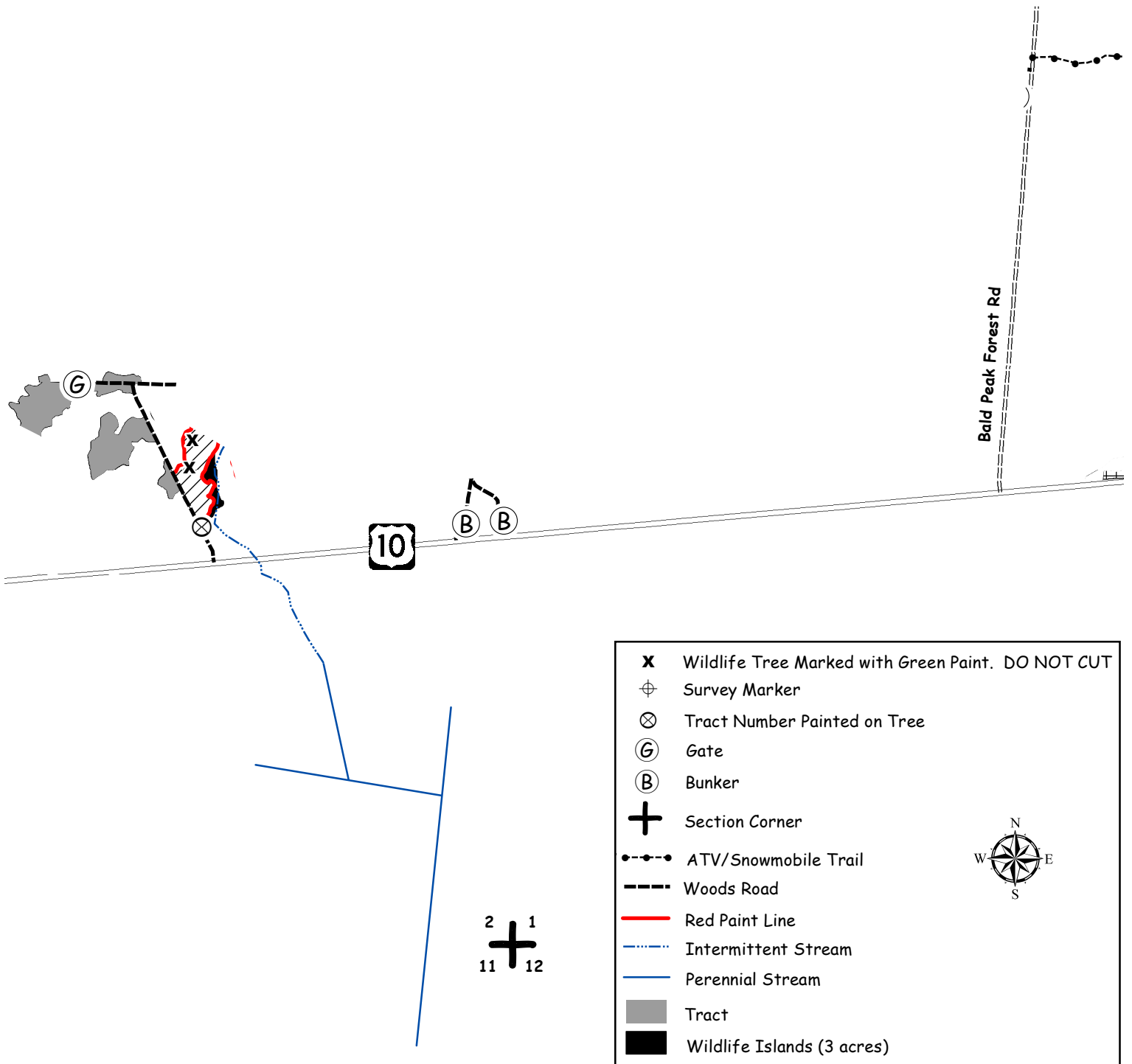

- |          |   |
|----------|---|
| <b>X</b> | Wildlife Tree Marked with Green Paint. DO NOT CUT |
| ⊕        | Survey Marker                                     |
| ⊗        | Tract Number Painted on Tree                      |
| ⓐ        | Gate  |
| ⓑ        | Bunker  |
| +        | Section Corner                                    |
| ⋯        | ATV/Snowmobile Trail                              |
| ---      | Woods Road  |
| —        | Red Paint Line                                    |
| ⋯        | Intermittent Stream                               |
| —        | Perennial Stream                                  |
| ■        | Tract   |
| ■        | Wildlife Islands (3 acres)                        |



**CLARK COUNTY FOREST**  
**Firewood Permit Area 5-24**  
**SESE Section 17**  
**S 1/2 SE 1/4, NESE Section 18**  
**N 1/2 NE 1/4 Section 19**  
**NWNW Section 20**  
**Township 25N Range 03W (Seif)**



Firewood Permit Area. May harvest trim, cull pieces, and non-merchantable logging debris. Do not cut any standing trees (alive or dead), pulpwood, logs, or downed timber 8 feet or longer.

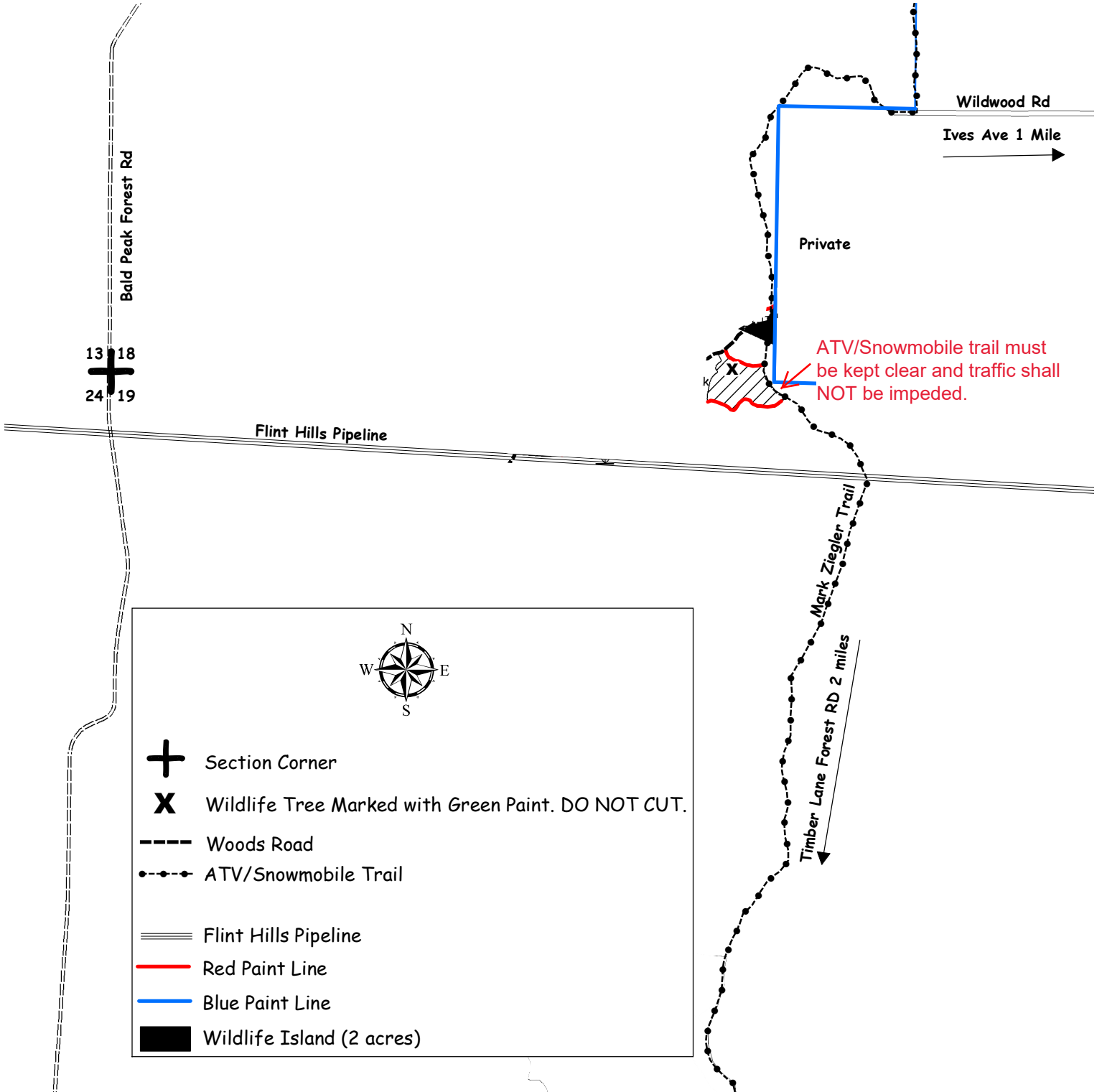

- +** Section Corner
- X** Wildlife Tree Marked with Green Paint. DO NOT CUT.
- Woods Road
- ATV/Snowmobile Trail
- === Flint Hills Pipeline
- Red Paint Line
- Blue Paint Line
- Wildlife Island (2 acres)

# CLARK COUNTY FOREST

## Firewood Permit Area 6-24

Pt. of NENE, SENE, NESE, SESE Section 8

Pt of NWNW, SWNW, NWSW Section 9

Township 26N Range 4W (N. Foster)



Firewood Permit Area. May harvest trim, cull pieces, and non-merchantable logging debris. Do not cut any standing trees (alive or dead), pulpwood, logs, or downed timber 8 feet or longer.

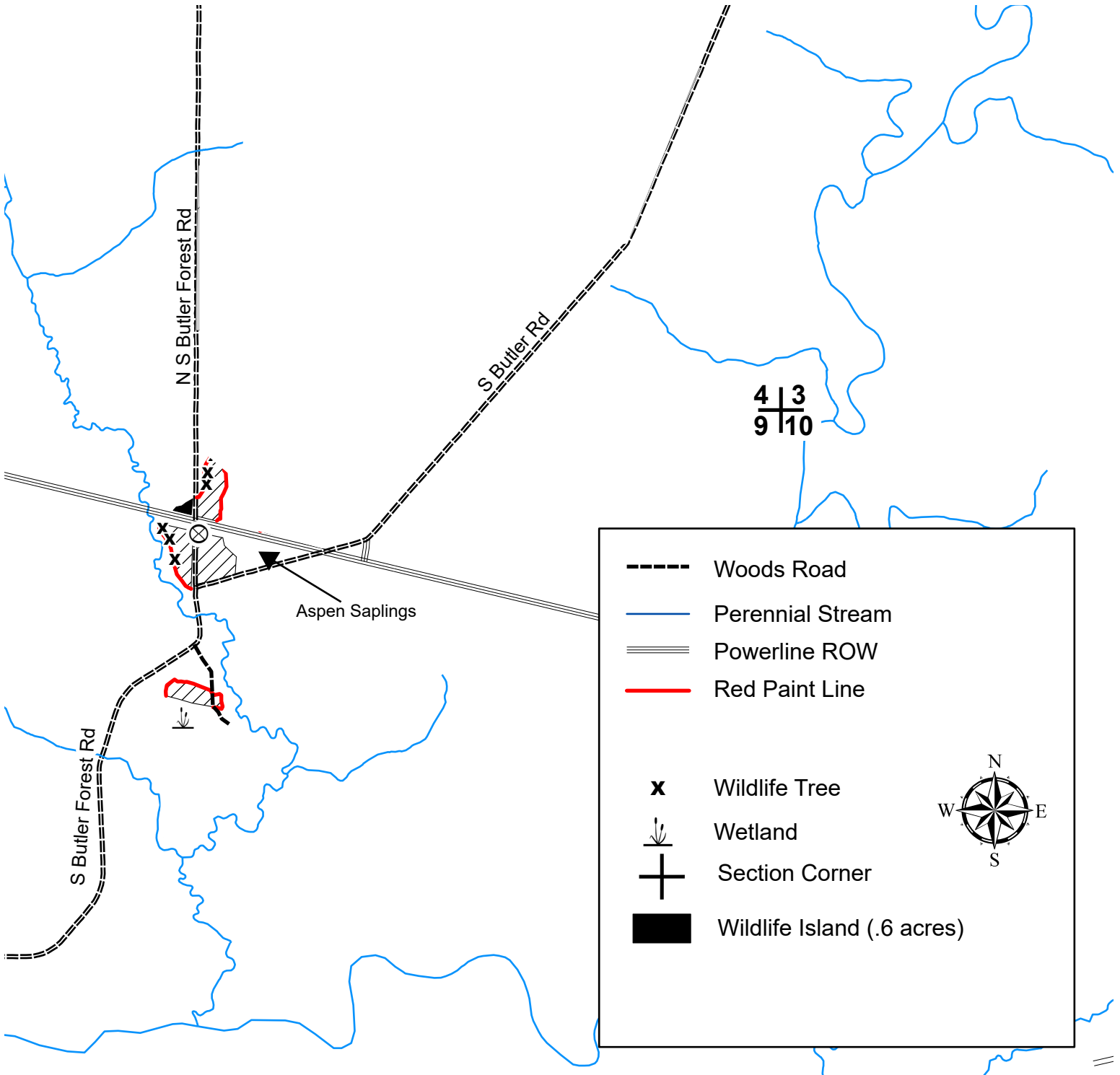

# CLARK COUNTY FOREST

Firewood Permit Area 7-24

S1/2 NE1/4, SE1/4 Section 32

Township 27N Range 4W (Butler)





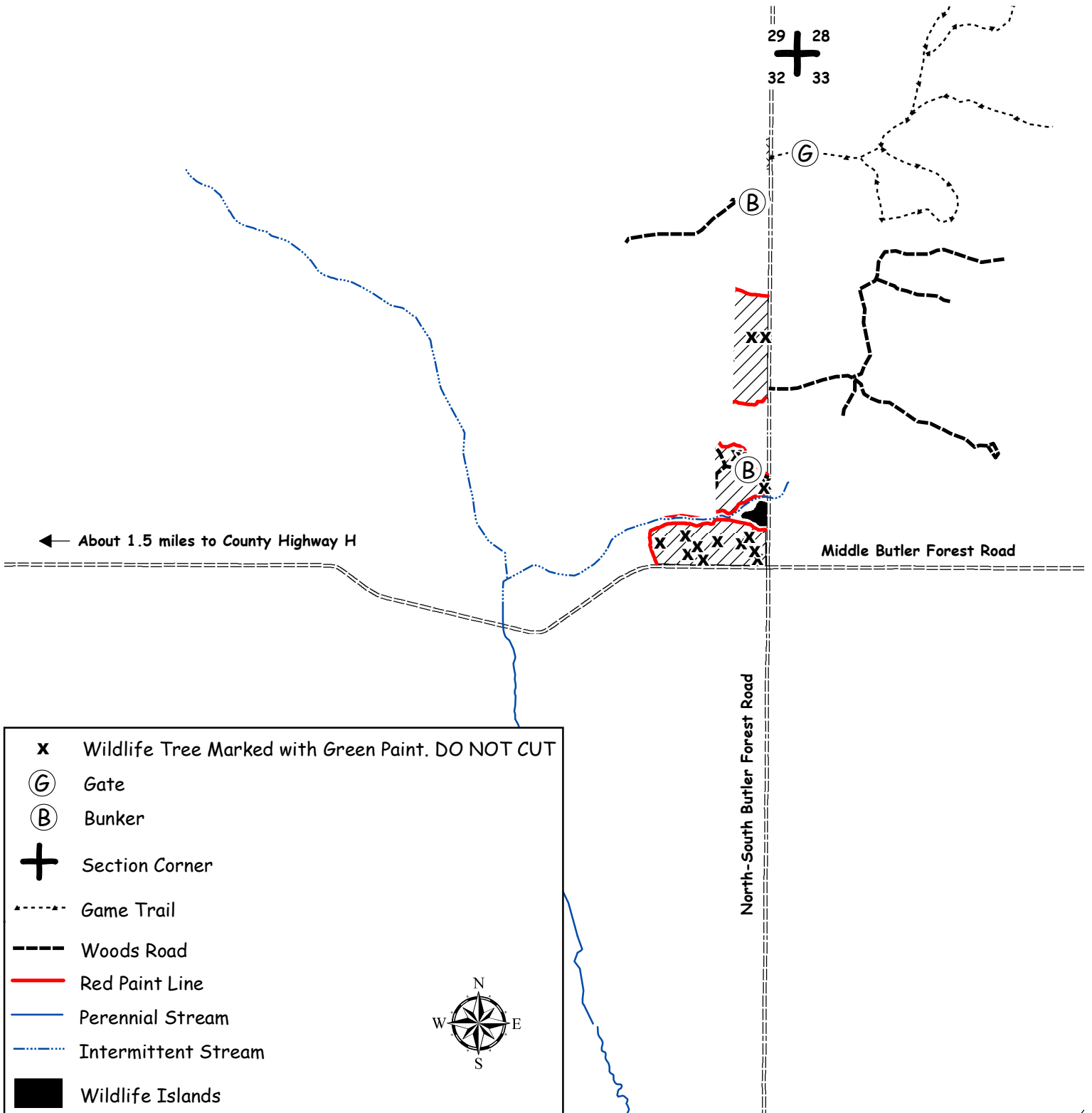





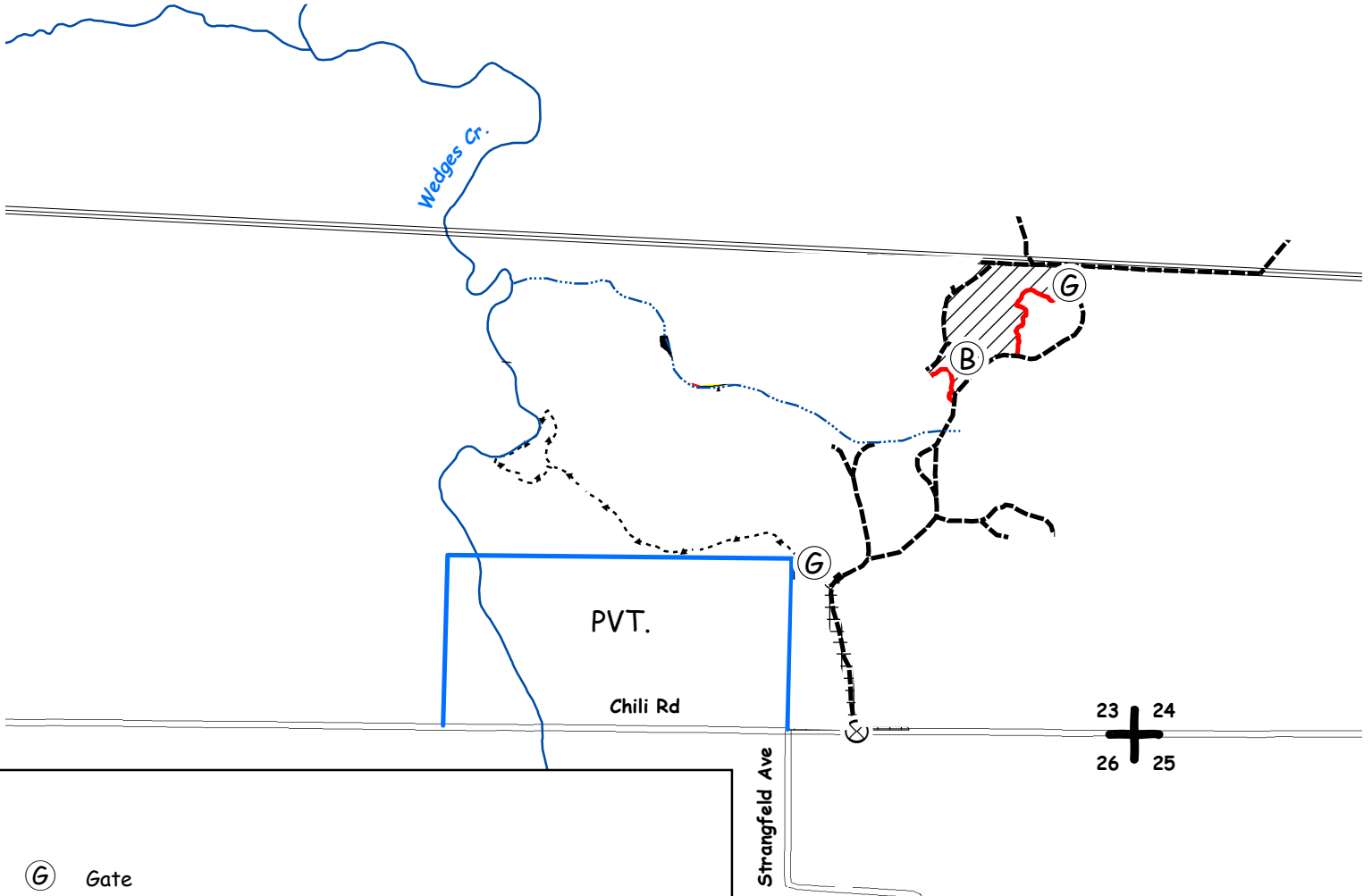

Firewood Permit Area. May harvest trim, cull pieces, and non-merchantable logging debris. Do not cut any standing trees (alive or dead), pulpwood, logs, or downed timber 8 feet or longer.



**CLARK COUNTY FOREST**  
**Firewood Permit Area 8-24**  
**S1/2 NE1/4, SENW, E1/2 SE1/4 Section 23**  
**Township 25N Range 3W (Seif)**

 Firewood Permit Area. May harvest trim, cull pieces, and non-merchantable logging debris. Do not cut any standing trees (alive or dead), pulpwood, logs, or downed timber 8 feet or longer.



	Gate
	Bunker
	Section Corner
	Woods Road
	Flint Hills Pipeline.
	Game Trail
	Red Paint Line
	Blue Paint Line
	Intermittent Stream
	Perennial Stream







**CLARK COUNTY FOREST**  
**Firewood Permit Area 9-24**  
**SWSW Section 25**  
**W1/2 NE1/4, NWSE, S1/2 NW1/4 Section 36**  
**Township 24N Range 04W (Mentor)**

 Firewood Permit Area. May harvest trim, cull pieces, and non-merchantable logging debris. Do not cut any standing trees (alive or dead), pulpwood, logs, or downed timber 8 feet or longer.





**x** Wildlife Tree Marked with Green Paint. DO NOT CUT

 Gate

 Section Corner

 Wildcat Campground

 Woods Road

 ATV/Snowmobile Trail

 Mineral Fire Break

 Red Paint Line

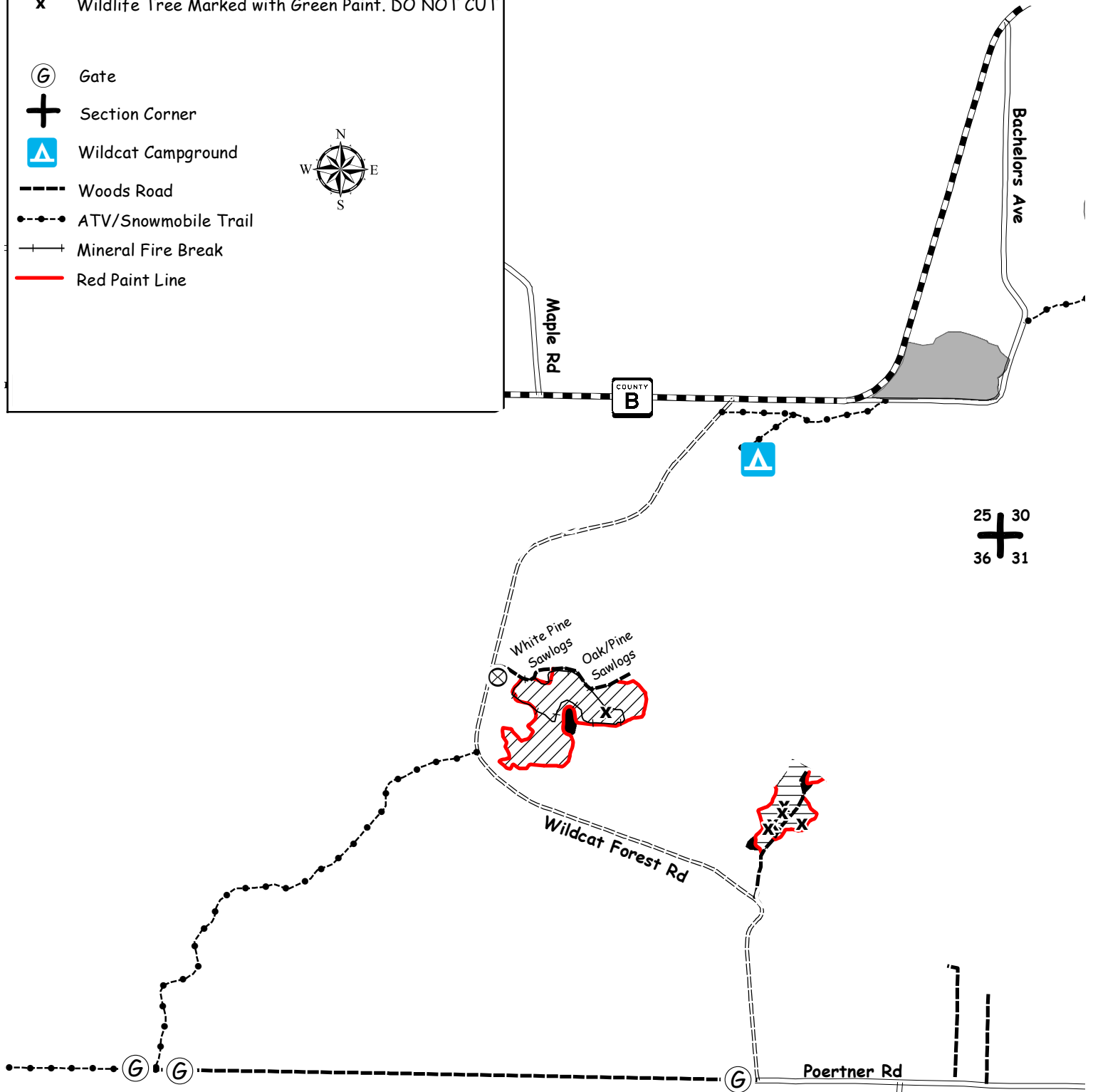
**CLARK COUNTY FOREST**  
**Firewood Permit Area 10-24**  
**SWNW Section 30**  
**Township 23N Range 3W (Dewhurst)**



Firewood Permit Area. May harvest trim, cull pieces, and non-merchantable logging debris. Do not cut any standing trees (alive or dead), pulpwood, logs, or downed timber 8 feet or longer.

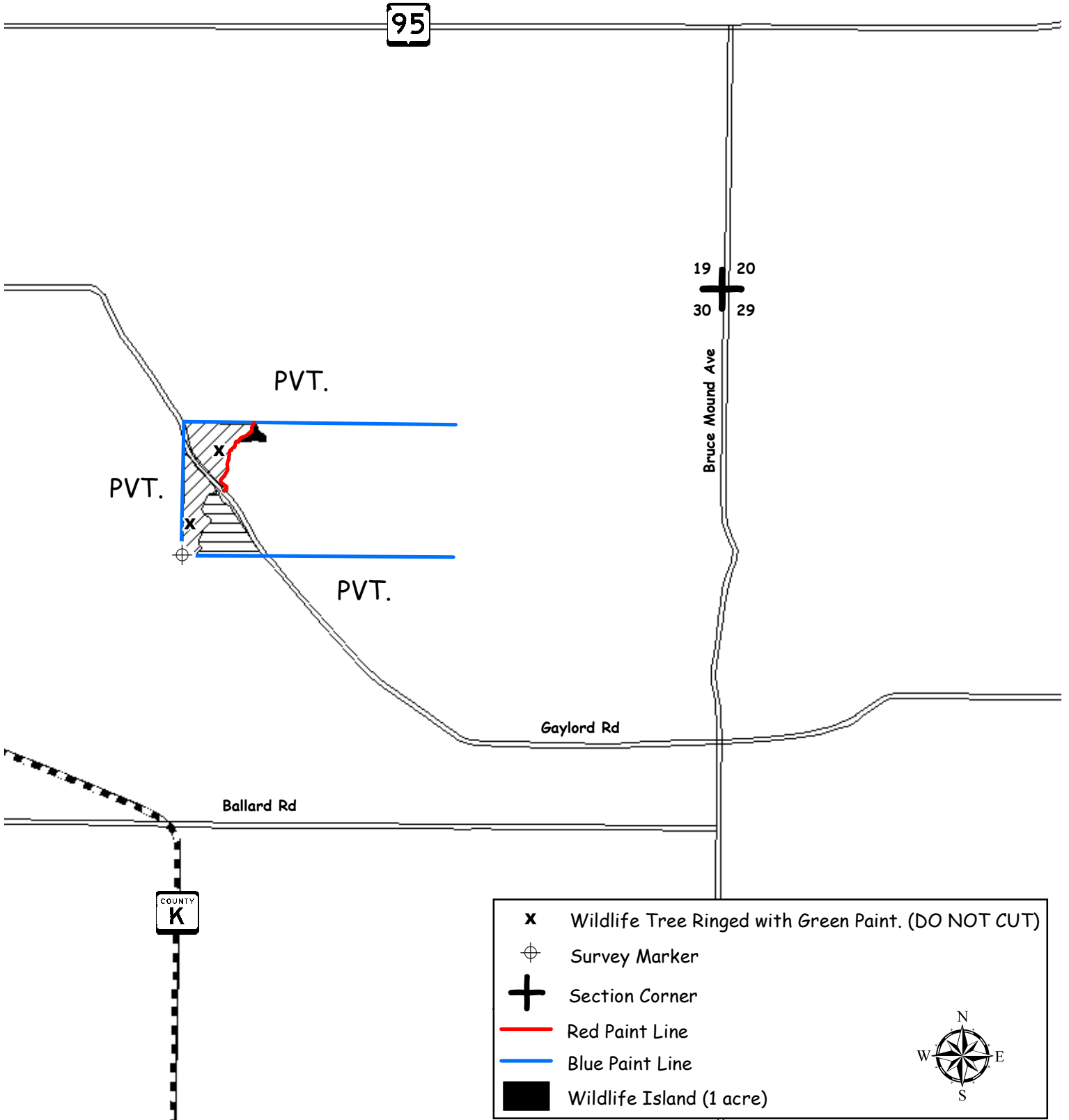

<b>x</b>	Wildlife Tree Ringed with Green Paint. (DO NOT CUT)
	Survey Marker
<b>+</b>	Section Corner
	Red Paint Line
	Blue Paint Line
	Wildlife Island (1 acre)



**CLARK COUNTY FOREST**  
**Firewood Permit Area 11-24**  
**S1/2 SW1/4, NESE, Section 27**  
**S1/2 NE1/4, NESE, Section 28**  
**Township 27N Range 03W (Mead)**



Firewood Permit Area. May harvest trim, cull pieces, and non-merchantable logging debris. Do not cut any standing trees (alive or dead), pulpwood, logs, or downed timber 8 feet or longer.

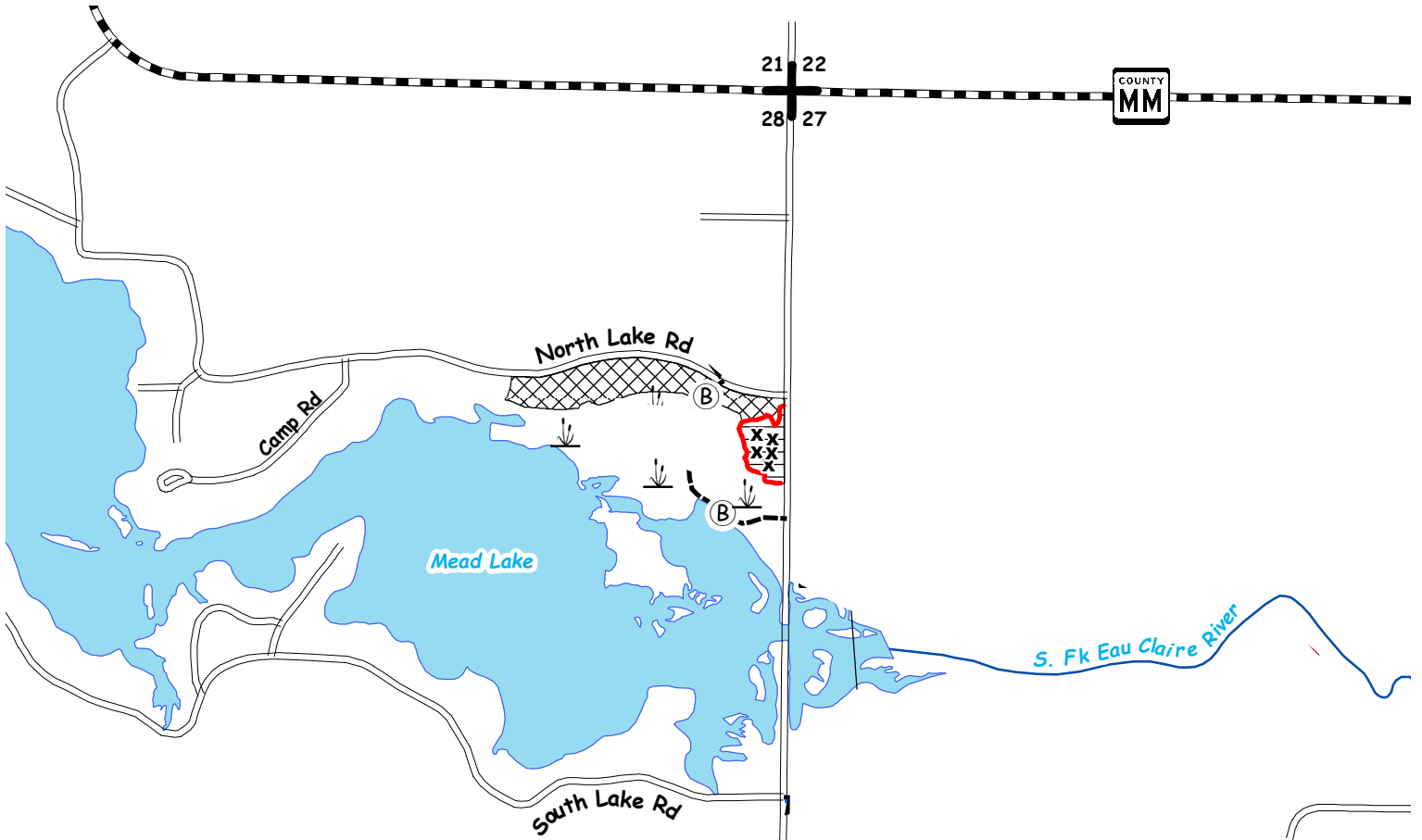

<b>x</b>	Wildlife Tree Marked with Green Paint. DO NOT CUT
<b>G</b>	Gate
<b>B</b>	Bunker
	Wetland
<b>+</b>	Section Corner
	Woods Road
	Perennial Stream
	Blue Paint Line
	Red Paint Line



Bachelors Ave



**CLARK COUNTY FOREST**  
**Firewood Permit Area 12-24**  
 SWNW, NWSW, NWSE, SWSE, Section 23,  
 Township 26N Range 4W (North Foster)

 Firewood Permit Area. May harvest trim, cull pieces, and non-merchantable logging debris. Do not cut any standing trees (alive or dead), pulpwood, logs, or downed timber 8 feet or longer.

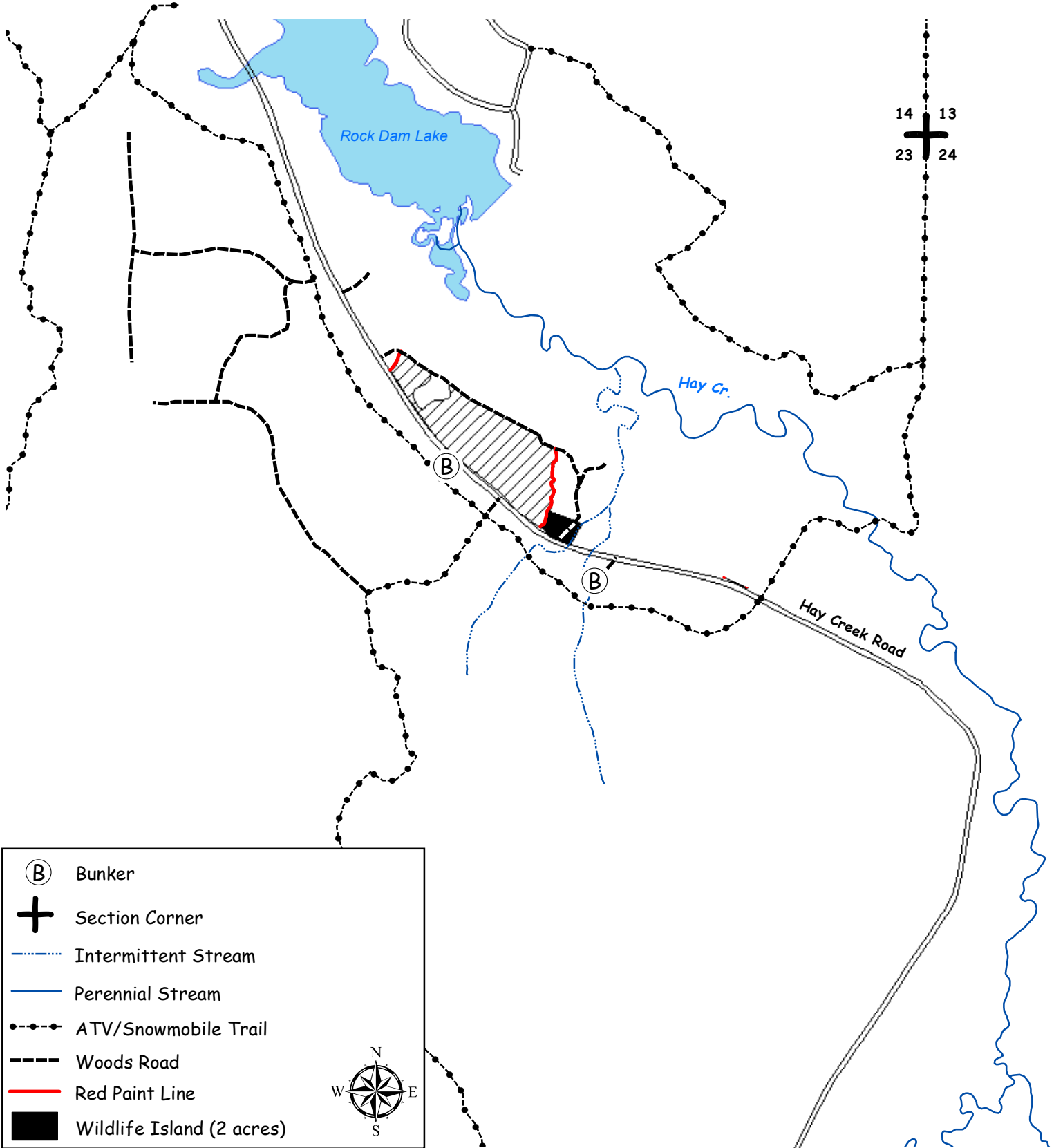

# CLARK COUNTY FOREST

## Firewood Permit Area 14-22

Pt. of NENW, NWNE, NENE Section 2  
Township 24N Range 3W (Hewett)



Firewood Permit Area. May harvest trim, cull pieces, and non-merchantable logging debris. Do not cut any standing trees (alive or dead), pulpwood, logs, or downed timber 8 feet or longer.

34 + 35  
3 | 2

ATV trail must be kept clear  
and traffic shall NOT be  
impeded.

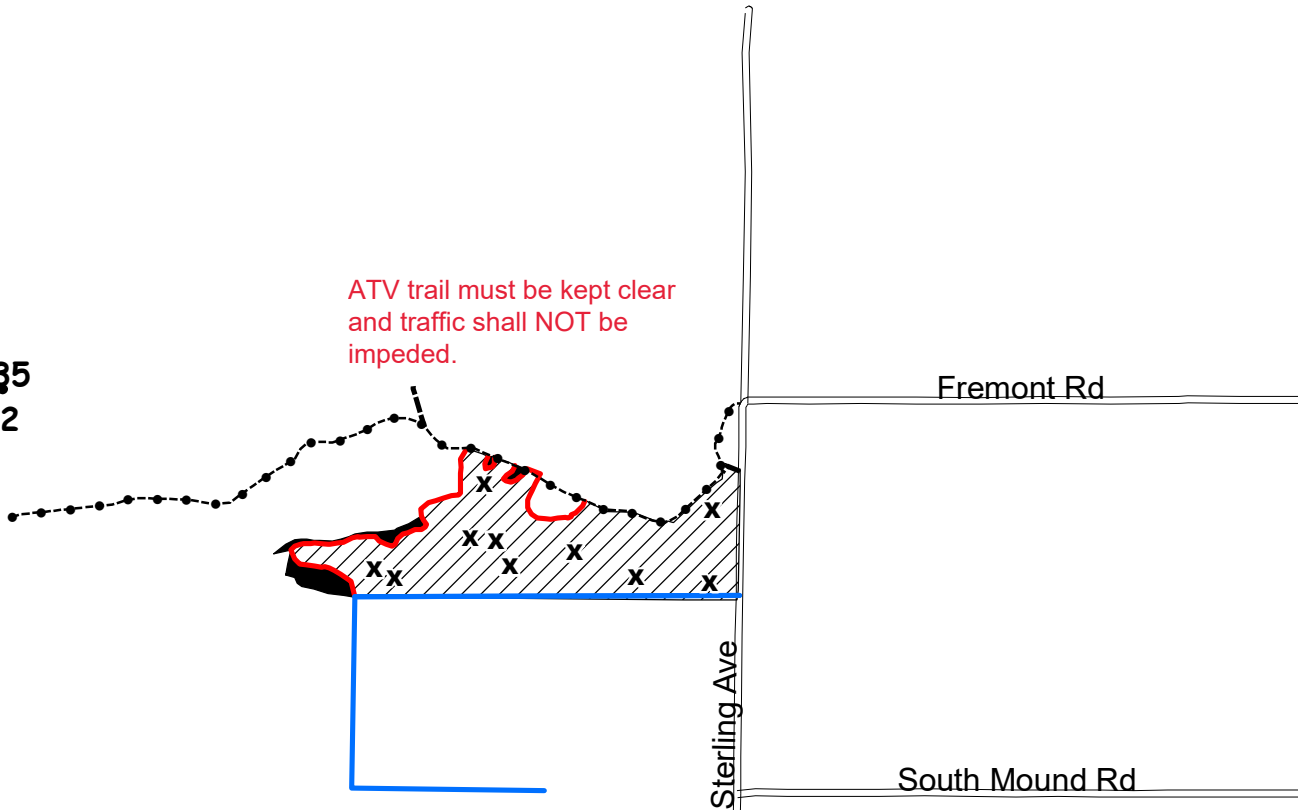

x	Wildlife Trees marked in green paint. DO NOT CUT
+	Section Corner
— (blue)	Blue Paint Line
— (red)	Red Paint Line
•••••	ATV, Trail
- - - - -	Woods Road
■	Wildlife Island (3 Acres)

**CLARK COUNTY FOREST**  
**Firewood Permit Area 1-23**  
**NWNE Section 8,**  
**SWNW Section 16**  
**Township 25N Range 4W (South Foster)**



Firewood Permit Area. May harvest trim, cull pieces, and non-merchantable logging debris. Do not cut any standing trees (alive or dead), pulpwood, logs, or downed timber 8 feet or longer.

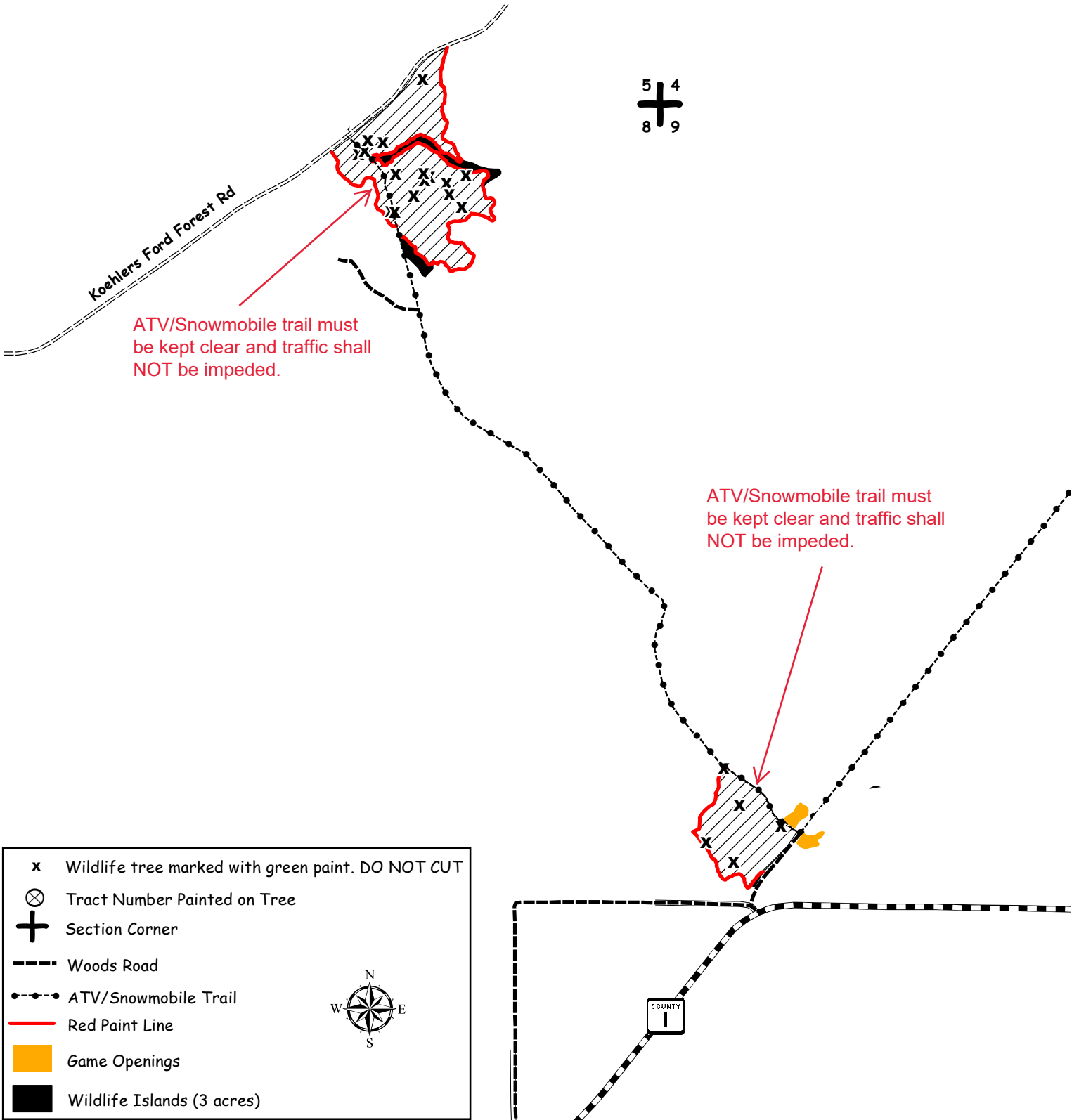

x	Wildlife tree marked with green paint. DO NOT CUT
⊗	Tract Number Painted on Tree
+	Section Corner
---	Woods Road
•-•-•	ATV/Snowmobile Trail
—	Red Paint Line
■	Game Openings
■	Wildlife Islands (3 acres)

# CLARK COUNTY FOREST

## Firewood Permit Area 2-23

Pt. of SWNE Section 18, Township 24N Range 3W (Hewett);



Firewood Permit Area. May harvest trim, cull pieces, and non-merchantable logging debris. Do not cut any standing trees (alive or dead), pulpwood, logs, or downed timber 8 feet or longer.

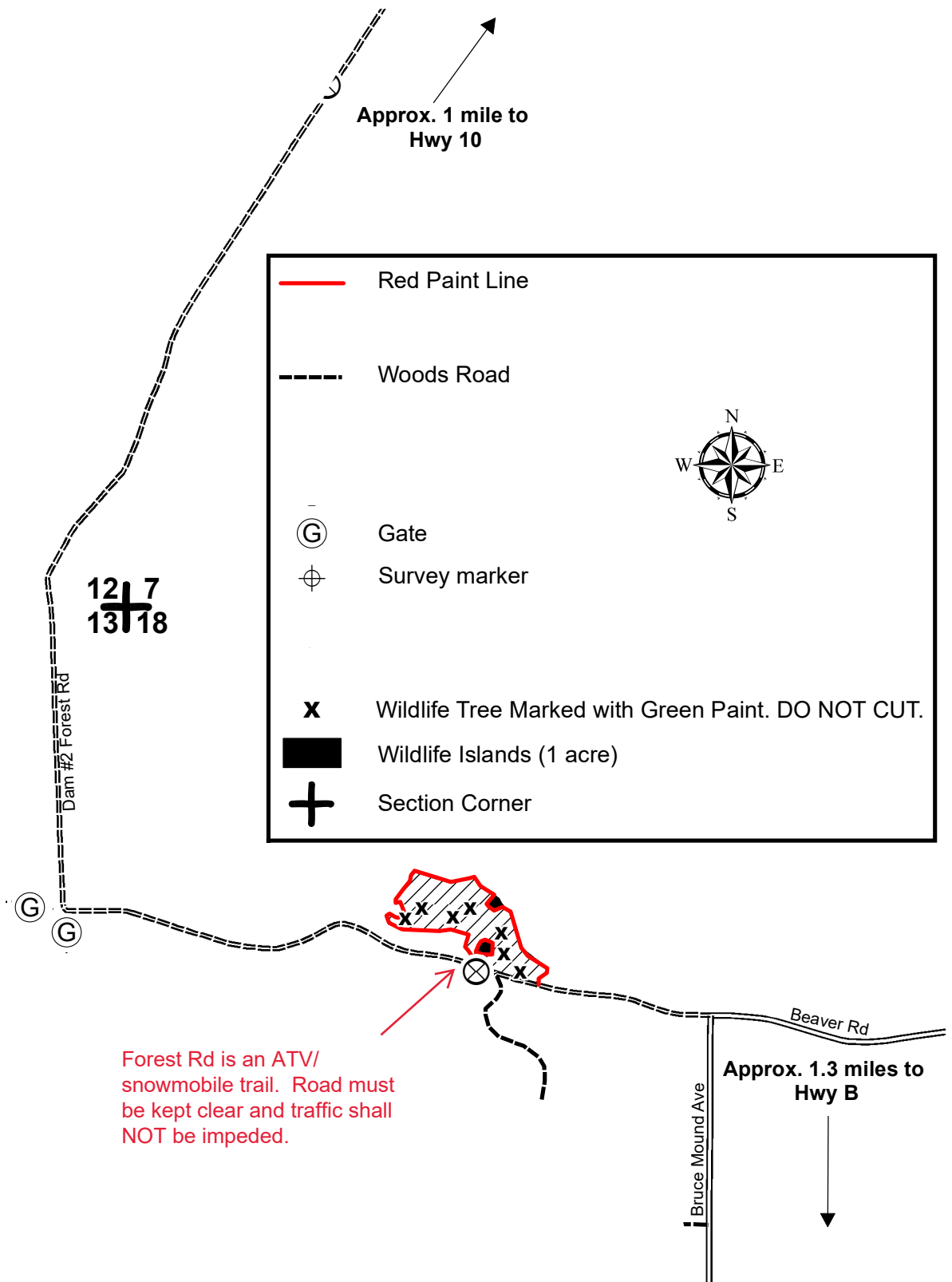

**CLARK COUNTY FOREST**  
**Firewood Permit Area 3-23**  
**SENE, E1/2 SE 1/4 Section 28**  
**Township 23N Range 1E (Sherwood)**

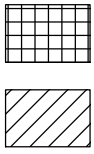

Firewood Permit Area. May harvest trim, cull pieces, and non-merchantable logging debris. Do not cut any standing trees (alive or dead), pulpwood, logs, or downed timber 8 feet or longer.

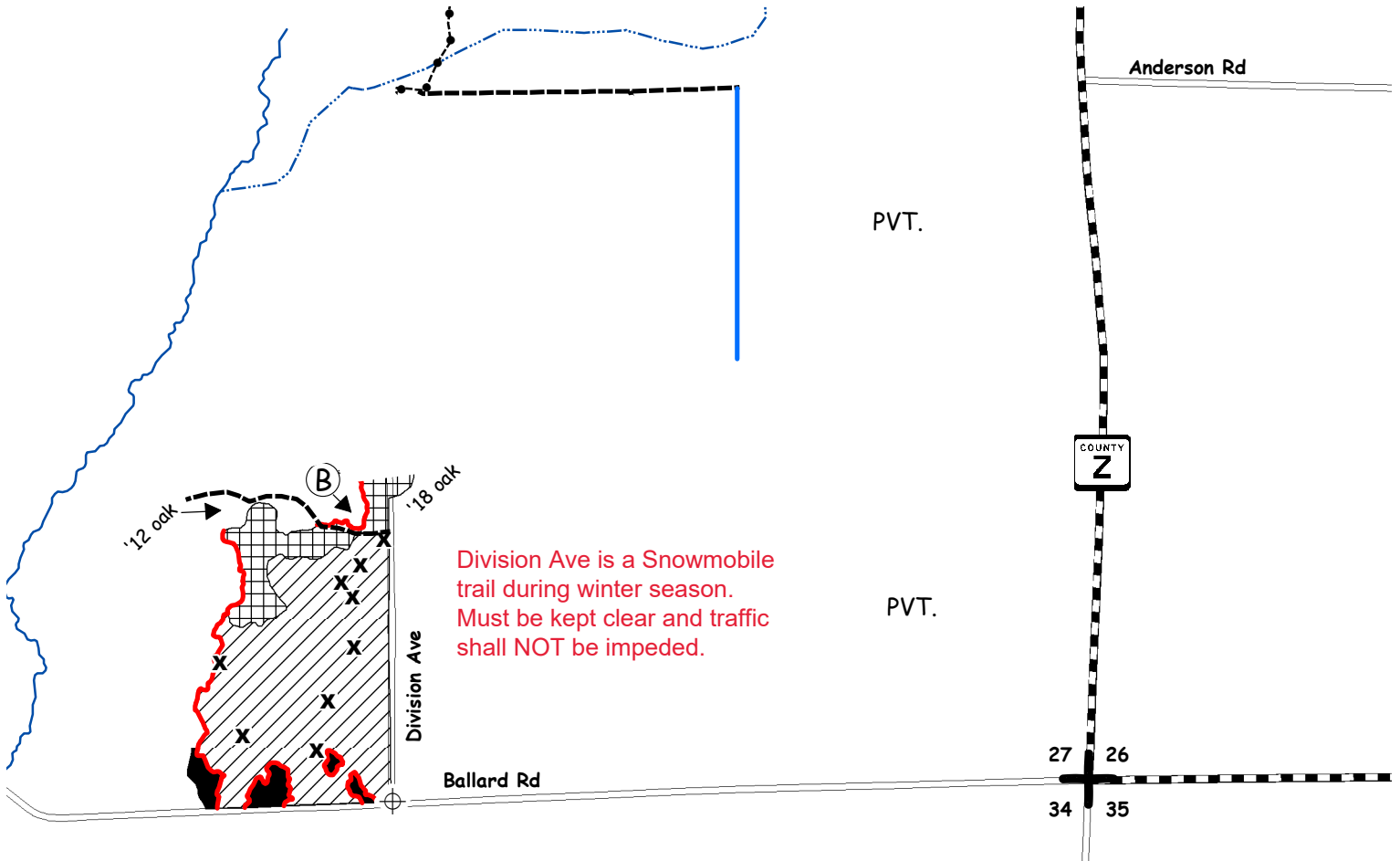

x	Wildlife Tree Marked with Green Paint. DO NOT CUT.
⊕	Survey Marker
ⓐ	Gate
ⓑ	Bunker
+	Section Corner
---	Woods Road
⋯	Intermittent Stream
—	Perennial Stream
—	Blue Paint Line
—	Red Paint Line
⚠	Sherwood Park Campground
■	Wildlife Islands (5 acres)





# CLARK COUNTY FOREST

## Firewood Permit Area 4-23

Pt. of NENW, SENW Section 25  
Township 24N Range 3W (Hewett)

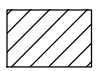

Firewood Permit Area. May harvest trim, cull pieces, and non-merchantable logging debris. Do not cut any standing trees (alive or dead), pulpwood, logs, or downed timber 8 feet or longer.

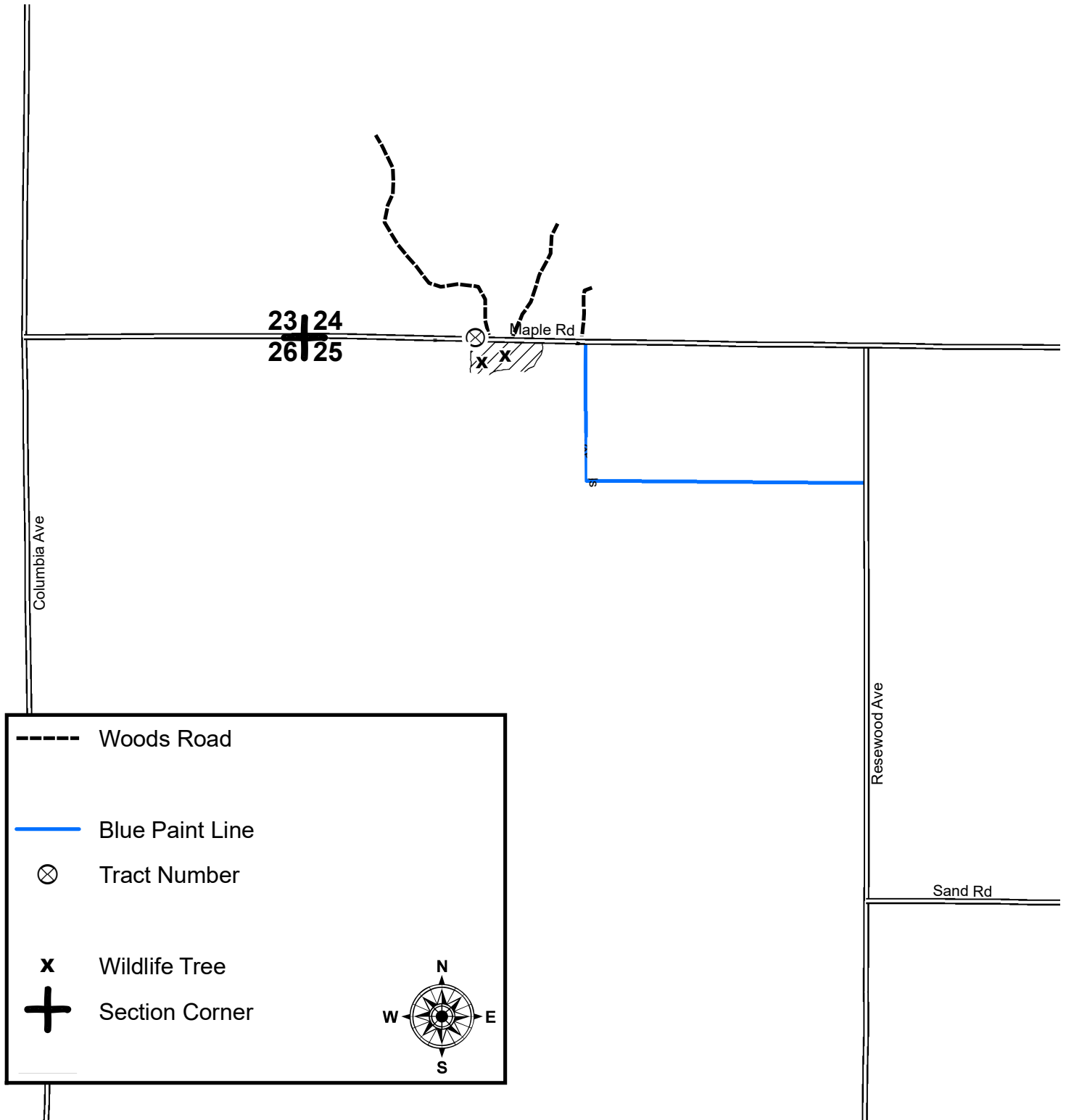

**CLARK COUNTY FOREST**  
**Firewood Permit Area 5-23**  
**SESW Section 35**  
**Township 25N Range 3W (Seif),**  
**N1/2 NW1/4 Section 2**  
**Township 24N Range 3W (Hewett)**



Firewood Permit Area. May harvest trim, cull pieces, and non-merchantable logging debris. Do not cut any standing trees (alive or dead), pulpwood, logs, or downed timber 8 feet or longer.



Access from Sterling Ave only. No vehicles past intersection.

ATV/Snowmobile trail must be kept clear and traffic shall NOT be impeded.

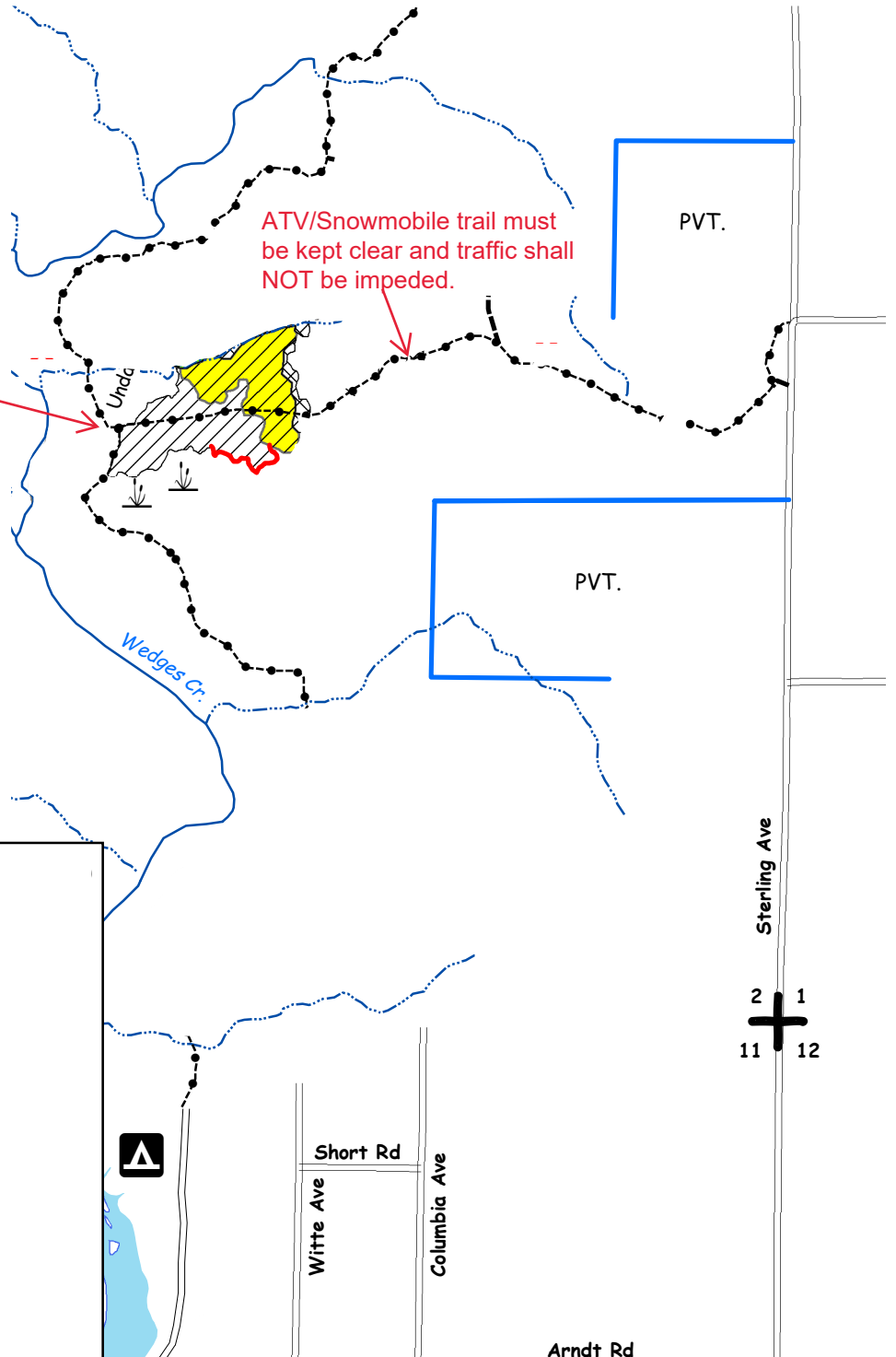

	Wetland
	Section Corner
	Snyder Park and Campground
	ATV/Snowmobile Trail
	Woods Road
	Intermittent Stream
	Perennial Stream
	Blue Paint Line
	Red Paint Line

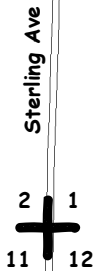

Arndt Rd

# CLARK COUNTY FOREST

## Firewood Permit Area 6-23

W 1/2 SE 1/4 Sec. 8

E 1/2 NW 1/4 Sec. 17

Township 27N Range 4W (Butler)



Firewood Permit Area. May harvest trim, cull pieces, and non-merchantable logging debris. Do not cut any standing trees (alive or dead), pulpwood, logs, or downed timber 8 feet or longer.

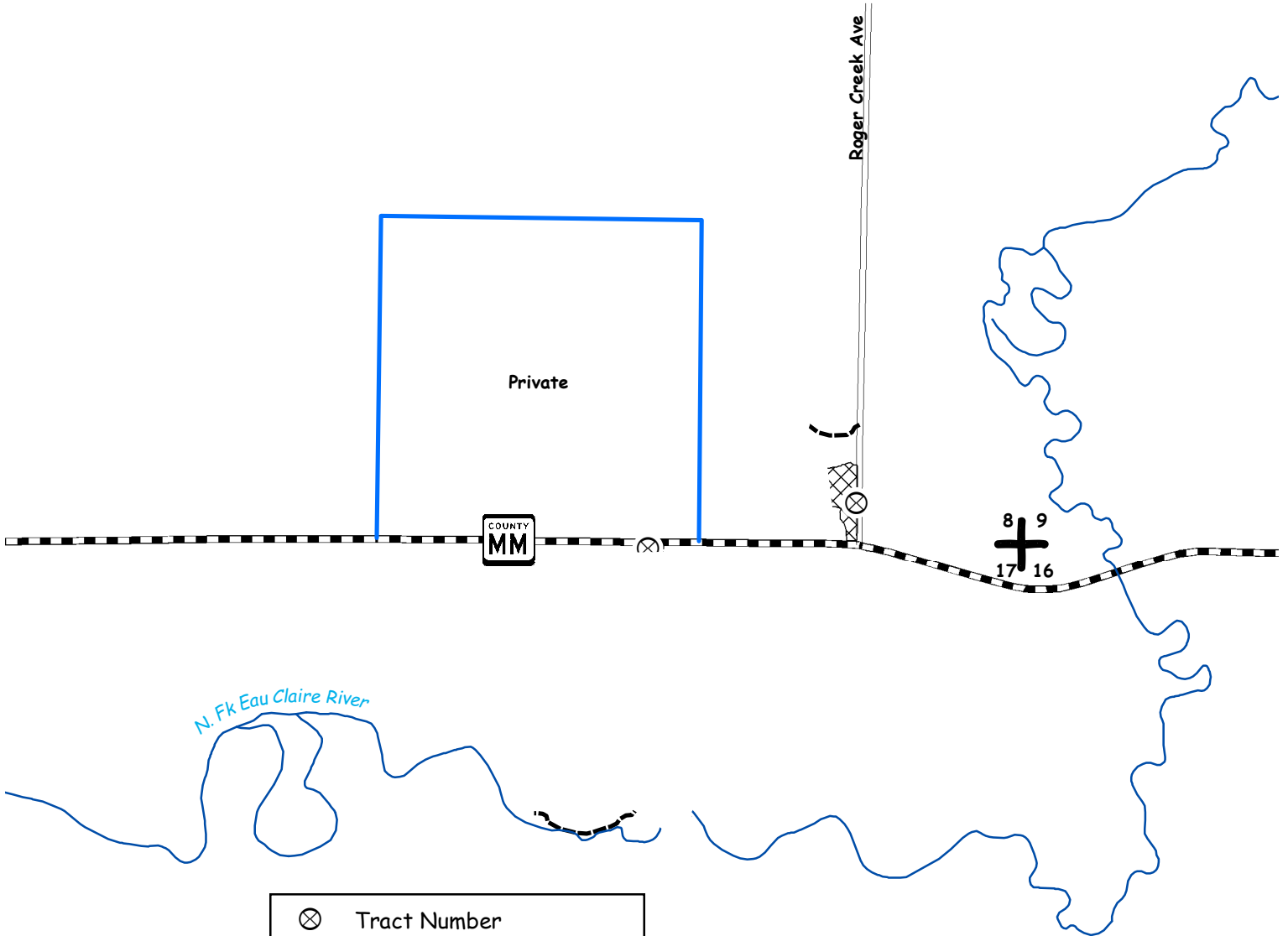

	Tract Number
	Section Corner
	Woods Road
	Perennial Stream
	Blue Paint Line

# CLARK COUNTY FOREST

## Firewood Permit Area 7-23

Pt. of S 1/2 Section 11  
Township 26N Range 4W (N. Foster)

Firewood Permit Area. May harvest trim, cull pieces, and non-merchantable logging debris.  
Do not cut any standing trees (alive or dead), pulpwood, logs, or downed timber 8 feet or longer.

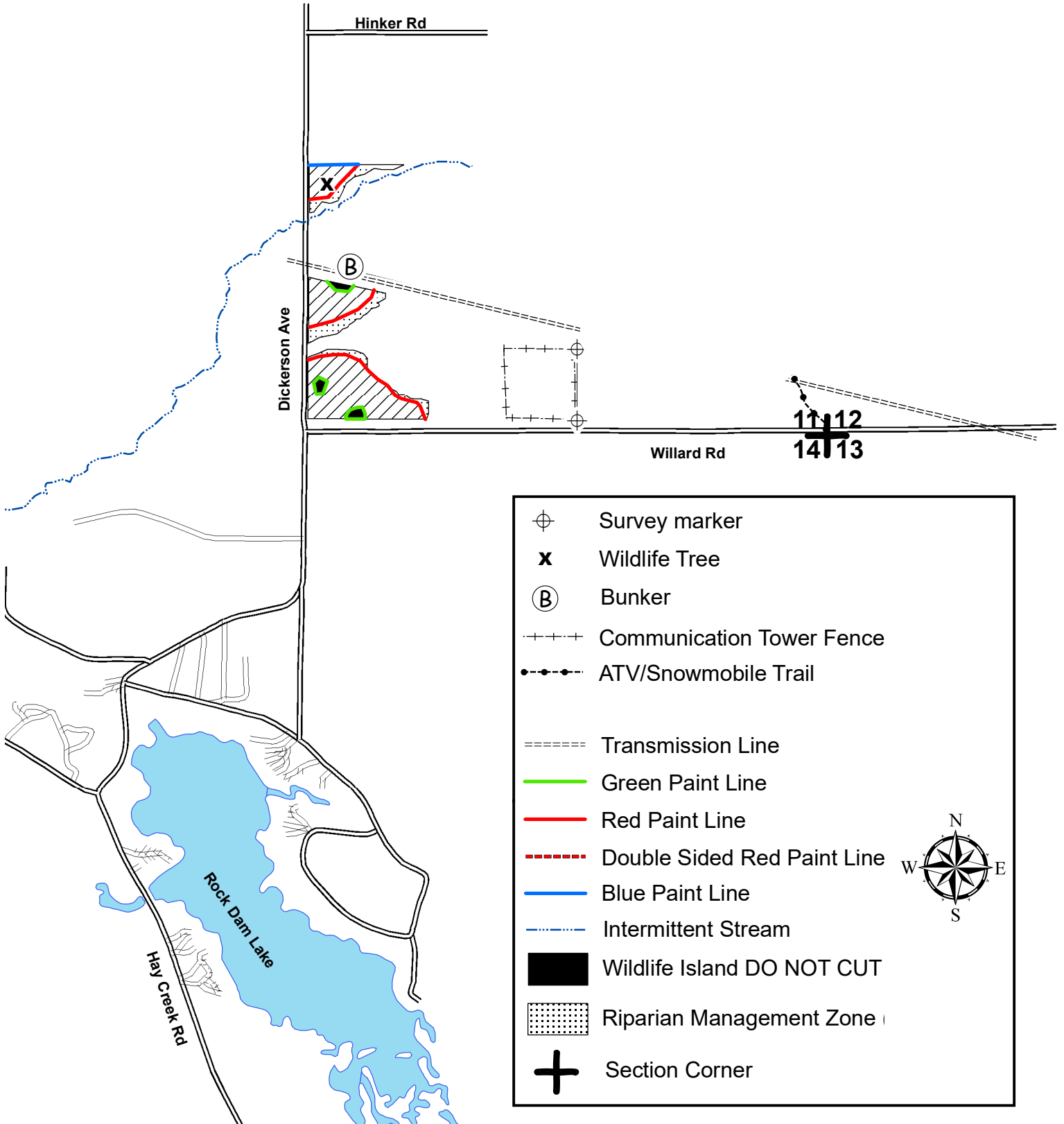

	Survey marker
	Wildlife Tree
	Bunker
	Communication Tower Fence
	ATV/Snowmobile Trail
	Transmission Line
	Green Paint Line
	Red Paint Line
	Double Sided Red Paint Line
	Blue Paint Line
	Intermittent Stream
	Wildlife Island DO NOT CUT
	Riparian Management Zone
	Section Corner



**CLARK COUNTY FOREST**  
**Firewood Permit Area 8-23**  
**Pt. of NW 1/4 Section 2**  
**Pt. of E 1/2 NE 1/4 Section 3**  
**Township 24N Range 4W (Mentor)**



Firewood Permit Area. May harvest trim, cull pieces, and non-merchantable logging debris. Do not cut any standing trees (alive or dead), pulpwood, logs, or downed timber 8 feet or longer.

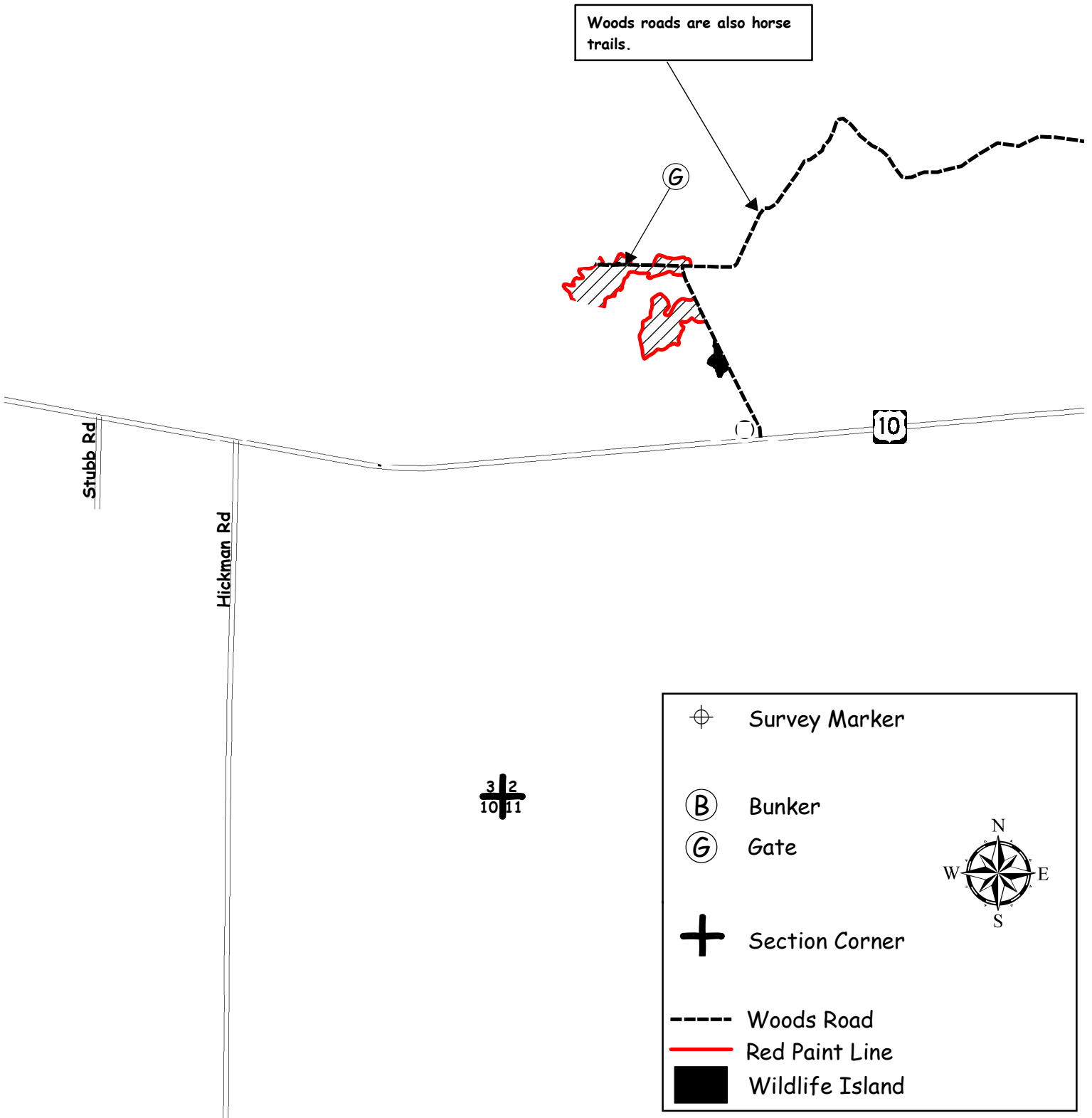

# CLARK COUNTY FOREST

Firewood Permit Area 9-23

Pt. of SESE Section 33

Township 25N Range 3W (Seif)



Firewood Permit Area. May harvest trim, cull pieces, and non-merchantable logging debris. Do not cut any standing trees (alive or dead), pulpwood, logs, or downed timber 8 feet or longer.



32 34  
+  
5 4

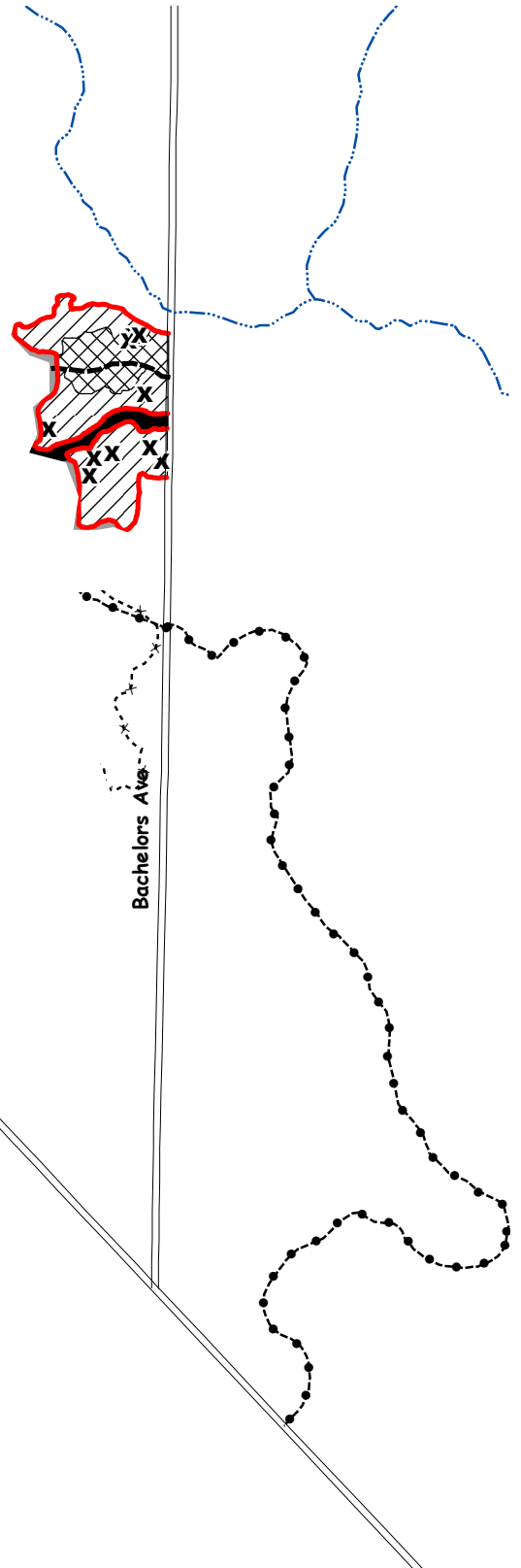

**X** Wildlife tree marked with green paint. DO NOT CUT

**+** Section Corner

--- Intermittent Stream

×---× Motorcycle Trail marked with two rings of green paint.

●---● ATV/Snowmobile Trail

--- Woods Road

— Red Paint Line



■ Wildlife Islands (9 acres)

# CLARK COUNTY FOREST

## Firewood Permit Area 10-23

Pt. of SWNW, SWSW, SESW Section 14  
Pt. of NENW, SWNE, SENE, NESE, SESE Section 23  
Township 26N Range 4W (N. Foster)

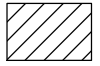

Firewood Permit Area. May harvest trim, cull pieces, and non-merchantable logging debris. Do not cut any standing trees (alive or dead), pulpwood, logs, or downed timber 8 feet or longer.

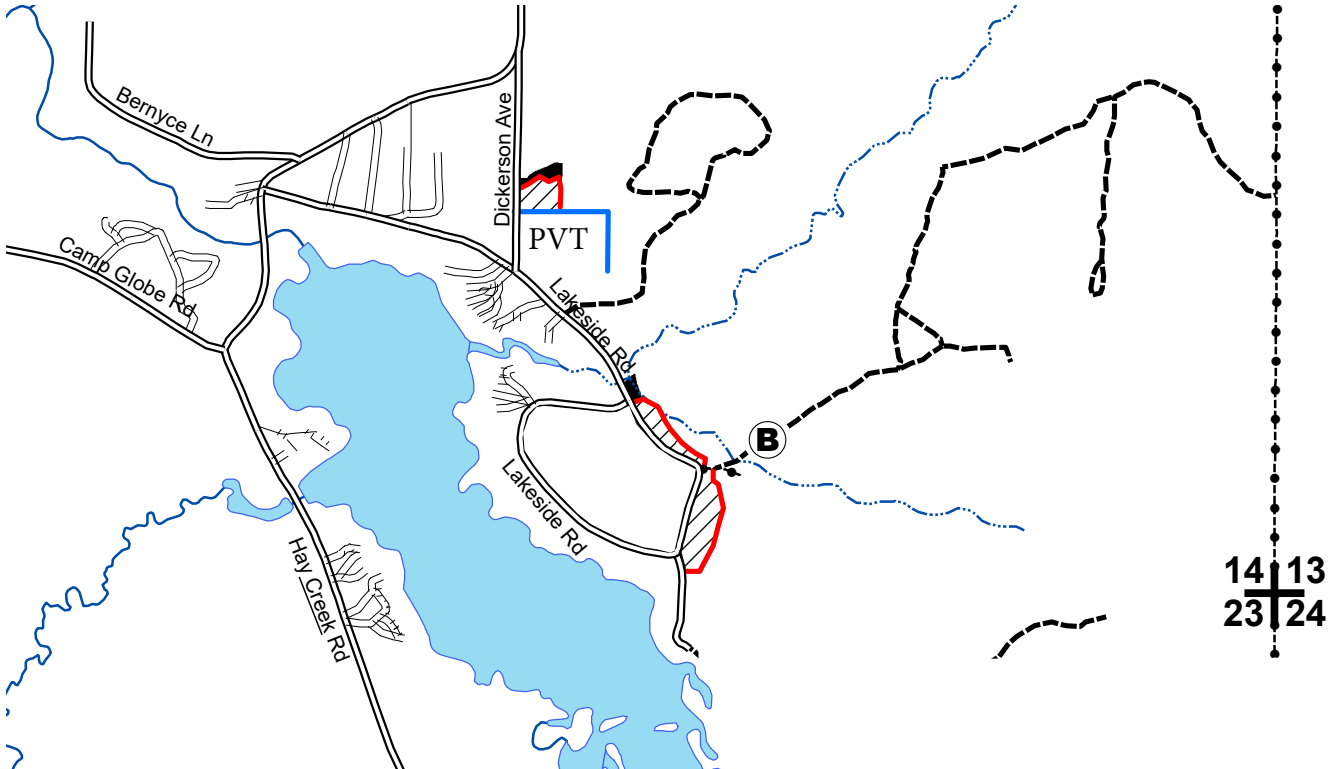

- Atv/Snowmobile Trail
- Woods Road
- Intermittent Stream
- Perennial Stream
- Red Paint Line
- Blue Paint Line
- Bunker
- Wildlife Island
- Section Corner



# CLARK COUNTY FOREST

## Firewood Permit Area 2-22

N 1/2 NW 1/4, SENW, SWSW Section 13,  
Township 26N Range 4W (North Foster)

 Firewood Permit Area. May harvest trim, cull pieces, and non-merchantable logging debris. Do not cut any standing trees (alive or dead), pulpwood, logs, or downed timber 8 feet or longer.

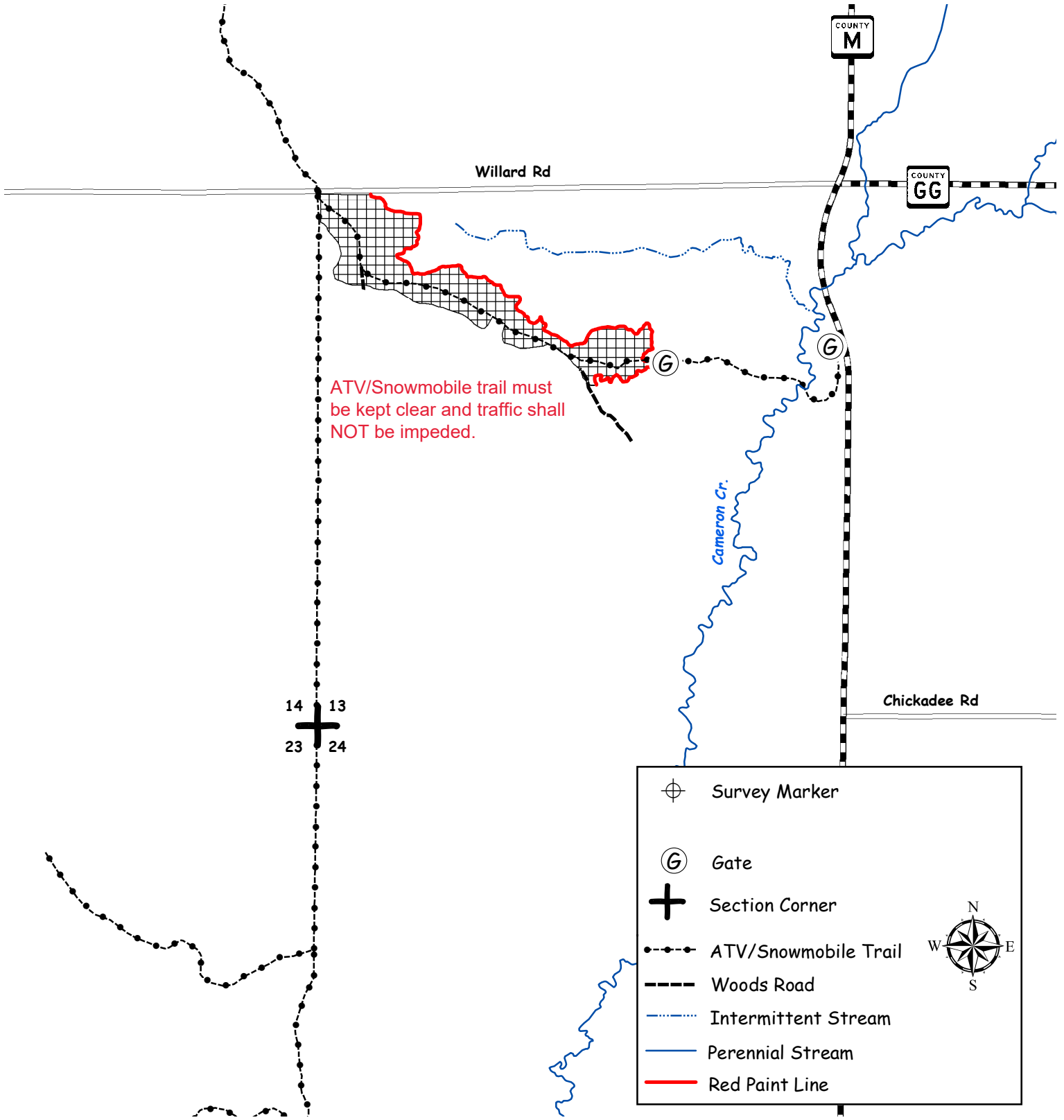

ATV/Snowmobile trail must be kept clear and traffic shall NOT be impeded.



**CLARK COUNTY FOREST**  
**Firewood Permit Area 4-22**  
**W1/2 NW1/4 Section 29,**  
**E1/2 NE1/4 Section 30**  
**Township 25N Range 3W (Seif)**



Firewood Permit Area. May harvest trim, cull pieces, and non-merchantable logging debris. Do not cut any standing trees (alive or dead), pulpwood, logs, or downed timber 8 feet or longer.

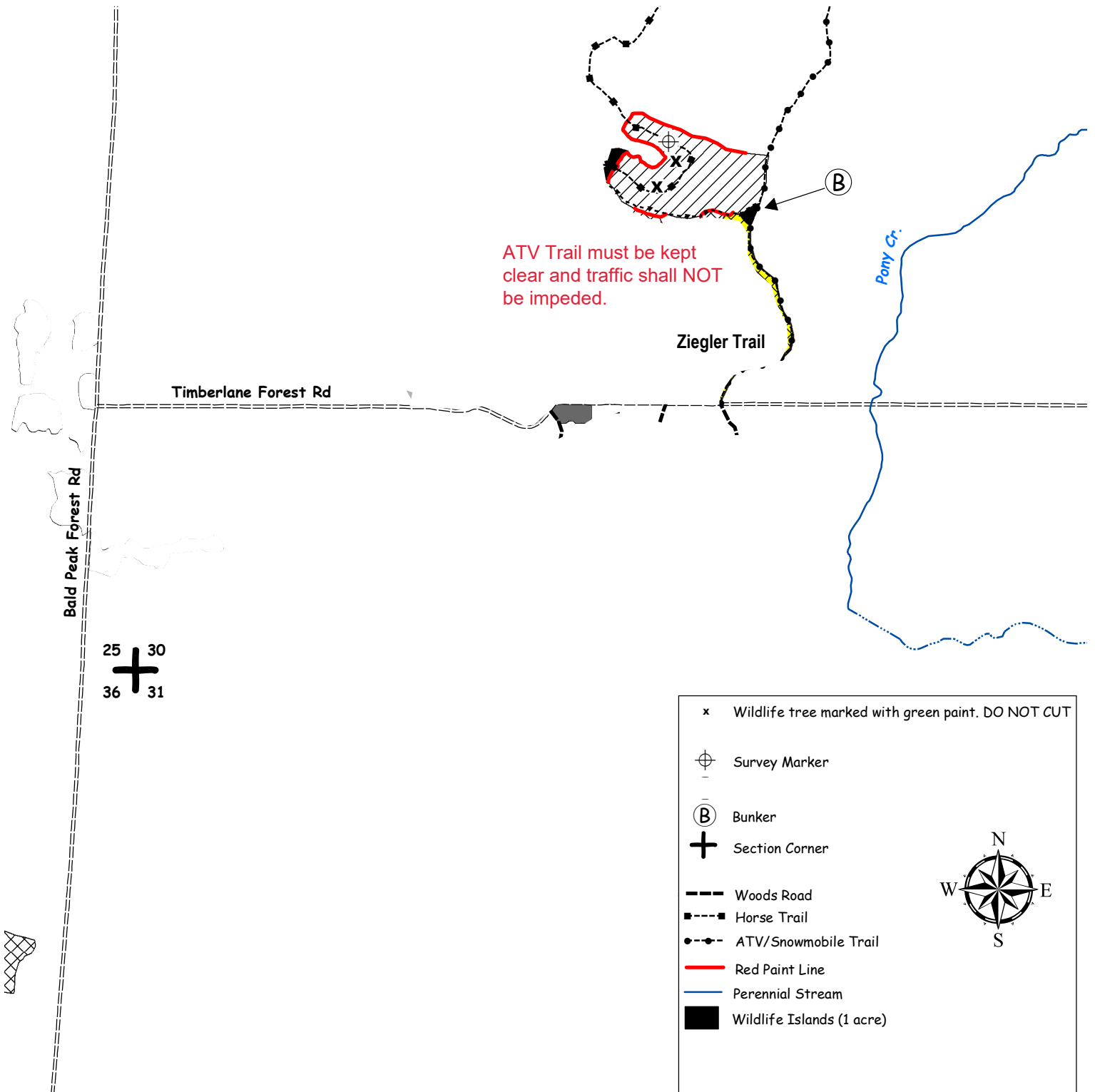

25 30  
 36 31

- x Wildlife tree marked with green paint. DO NOT CUT
- ⊕ Survey Marker
- Ⓟ Bunker
- ⊕ Section Corner
- Woods Road
- - - - Horse Trail
- - - - - ATV/Snowmobile Trail
- Red Paint Line
- Perennial Stream
- Wildlife Islands (1 acre)

**CLARK COUNTY FOREST**  
**Firewood Permit Area 6-22**  
**Pt. of SESE Section 23**  
**Pt of S 1/2 SW 1/4 Section 24**  
**Township 23N Range 01W (Washburn)**

 Firewood Permit Area. May harvest trim, cull pieces, and non-merchantable logging debris. Do not cut any standing trees (alive or dead), pulpwood, logs, or downed timber 8 feet or longer.

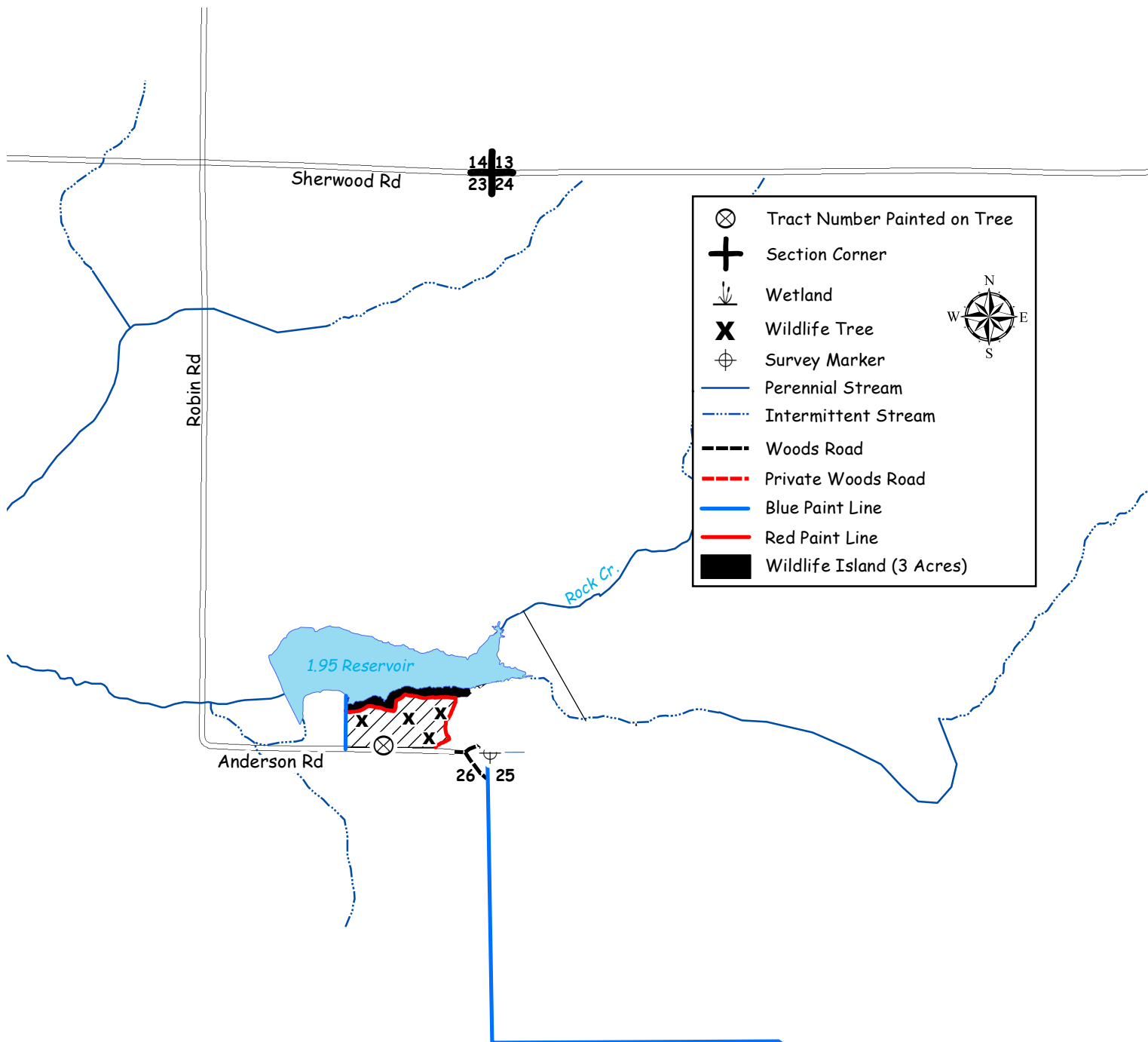

**CLARK COUNTY FOREST**  
**Firewood Permit Area 9-22**  
 SESW, SWSE, SESE, NESE Sec. 10  
 SWNW, NWSW, NWSE, NESE Sec. 11  
 N1/2 SENE Sec. 15  
 Township 23N, Range 3W (Dewhurst)



Firewood Permit Area. May harvest trim, cull pieces, and non-merchantable logging debris. Do not cut any standing trees (alive or dead), pulpwood, logs, or downed timber 8 feet or longer.

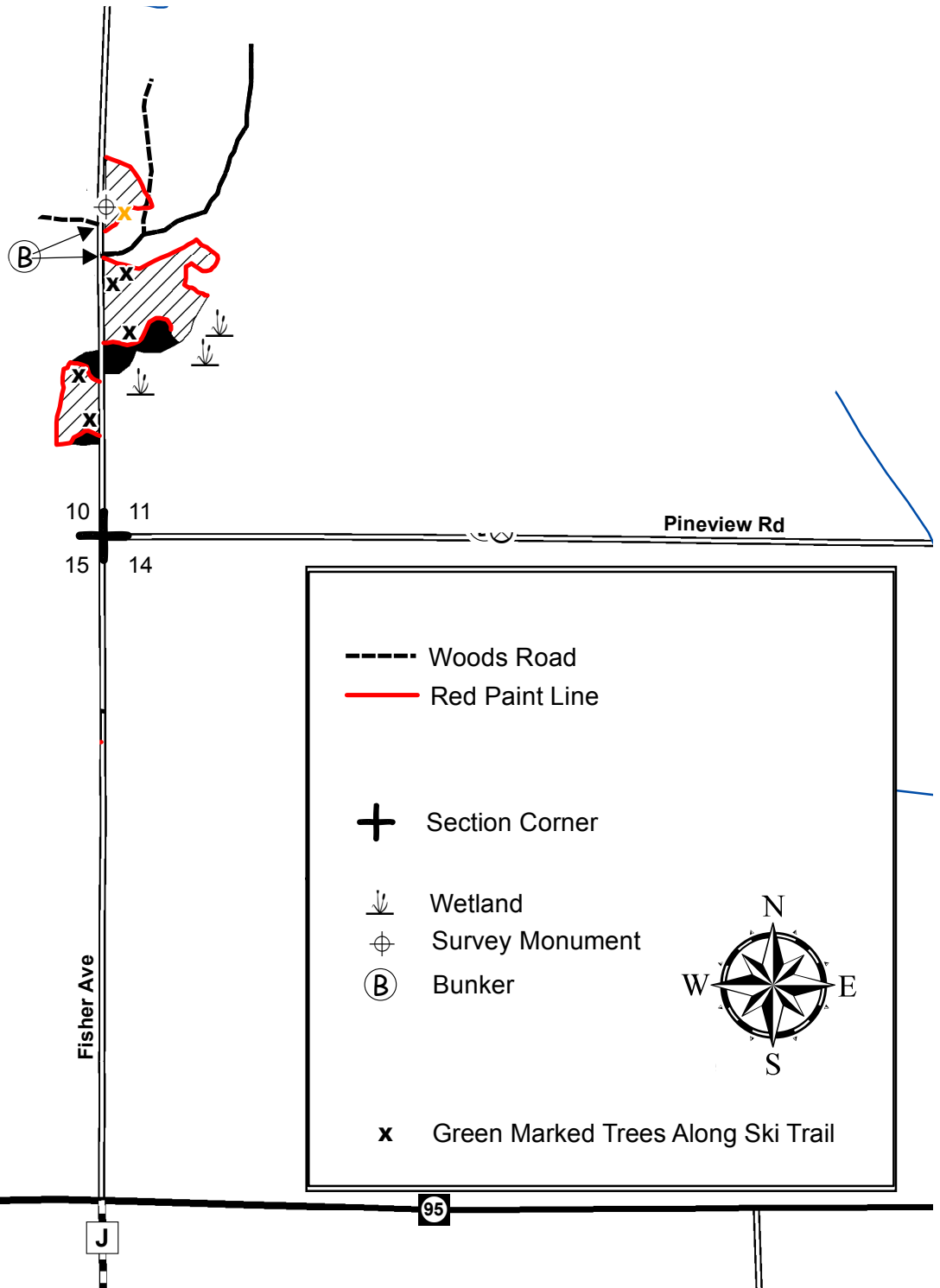

**CLARK COUNTY FOREST**  
**Firewood Permit Area 17-22**  
**Pt. of S 1/2 N 1/2 Section 3**  
**Township 24N Range 3W (Hewett)**



Firewood Permit Area. May harvest trim, cull pieces, and non-merchantable logging debris. Do not cut any standing trees (alive or dead), pulpwood, logs, or downed timber 8 feet or longer.

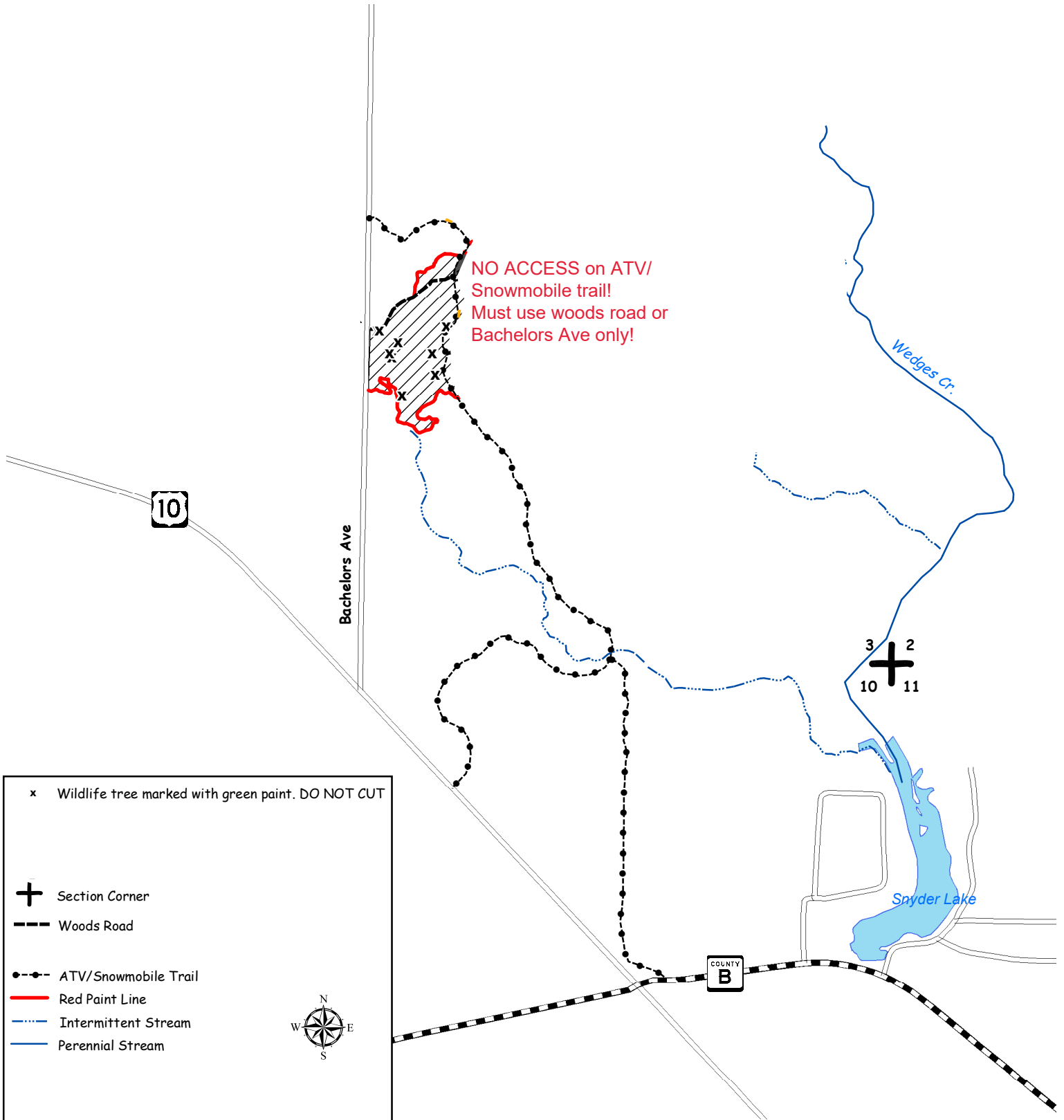

# CLARK COUNTY FOREST

## Firewood Permit Area 18-22

Pt. of SESW Section 4

Pt. of NENW Section 9

Township 23N Range 3W (Dewhurst)



Firewood Permit Area. May harvest trim, cull pieces, and non-merchantable logging debris. Do not cut any standing trees (alive or dead), pulpwood, logs, or downed timber 8 feet or longer.

