

CLARK COUNTY FOREST

Firewood Permit Area 1-24

Pt. of NENW, NWNE, NENE, SWNE Section 20

Pt. of SWNW Section 21

Township 23N Range 1E (Sherwood)



Firewood Permit Area. May harvest trim, cull pieces, and non-merchantable logging debris. Do not cut any standing trees (alive or dead), pulpwood, logs, or downed timber 8 feet or longer.

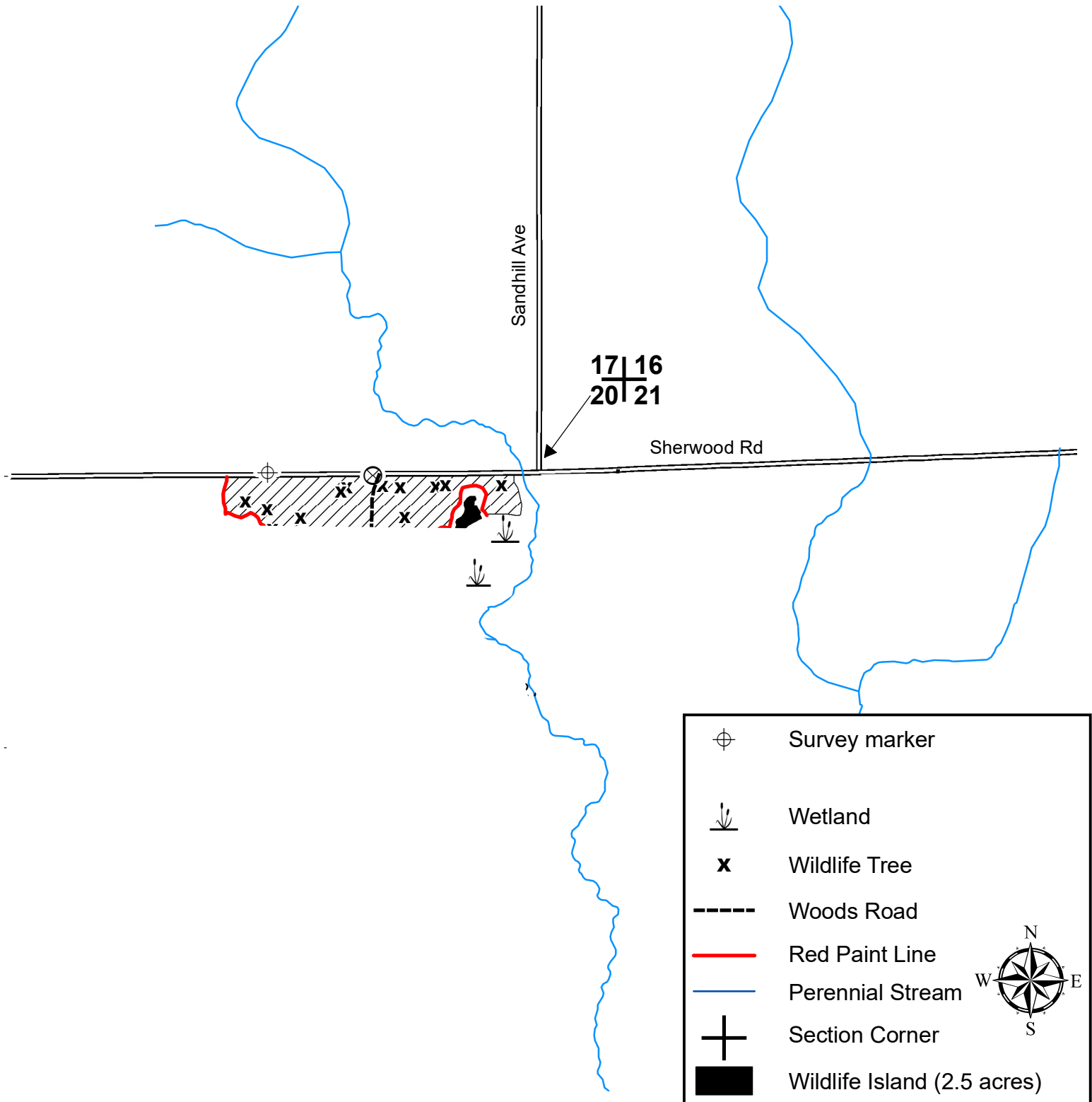

17 | 16
20 | 21

Sandhill Ave

Sherwood Rd



CLARK COUNTY FOREST Firewood Permit Area 2-24

Pt. of SWNW, NWSE, Section 16

Pt. of NESE, SENE, Section 17

Township 25N Range 4W (South Foster)



Firewood Permit Area. May harvest trim, cull pieces, and non-merchantable logging debris. Do not cut any standing trees (alive or dead), pulpwood, logs, or downed timber 8 feet or longer.

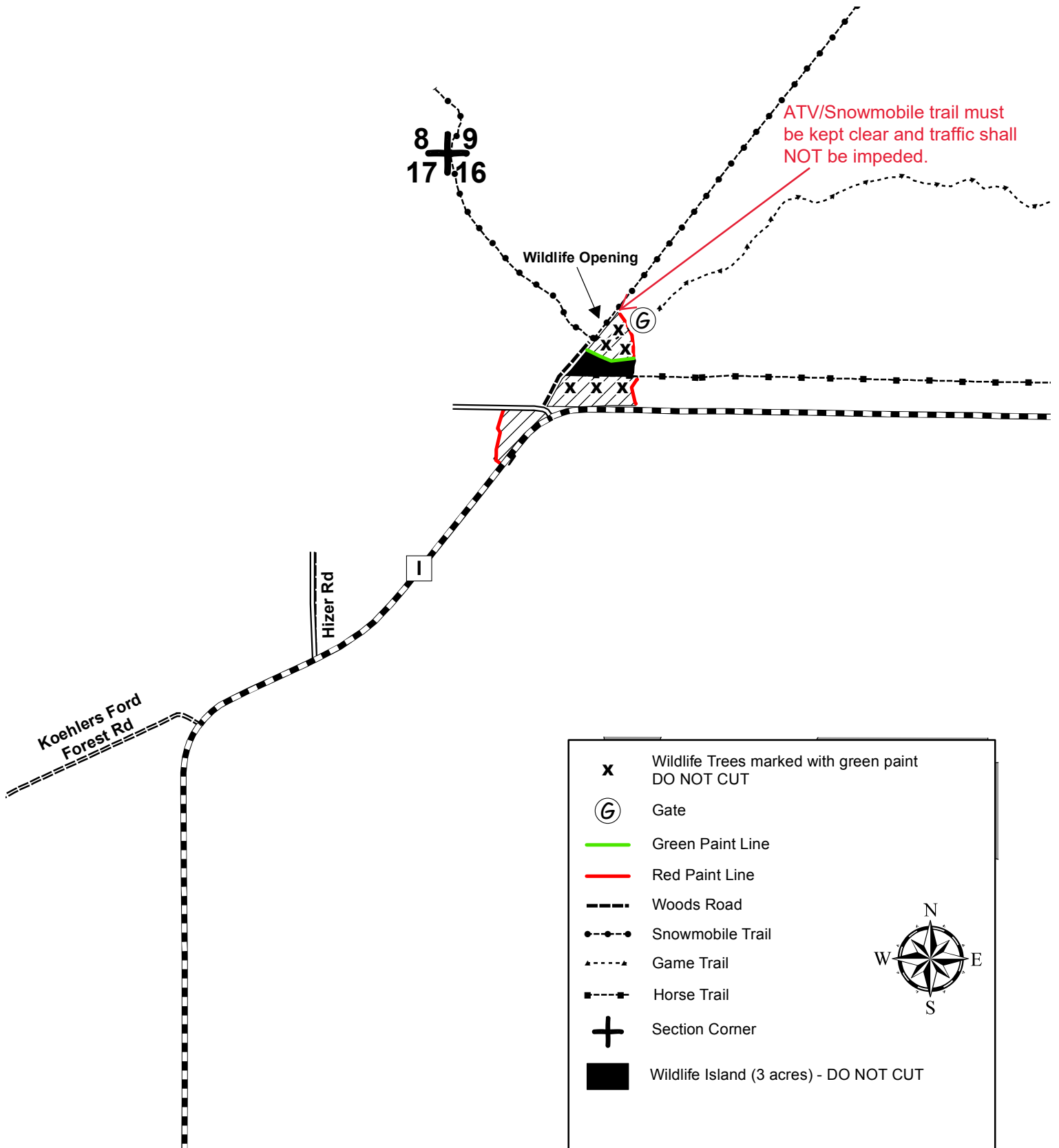

ATV/Snowmobile trail must be kept clear and traffic shall NOT be impeded.

8 + 9
17 + 16

Wildlife Opening

G

Hizer Rd

Koehlers Ford Forest Rd

x	Wildlife Trees marked with green paint DO NOT CUT
G	Gate
—	Green Paint Line
—	Red Paint Line
---	Woods Road
.....	Snowmobile Trail
-▲-	Game Trail
-■-	Horse Trail
+	Section Corner
■	Wildlife Island (3 acres) - DO NOT CUT

CLARK COUNTY FOREST

Firewood Permit Area 3-24

Pt. of NENW, NWNE, SENW, SWNE, NESE, SESE Section 21
Township 23N Range 3W (Dewhurst)



Firewood Permit Area. May harvest trim, cull pieces, and non-merchantable logging debris. Do not cut any standing trees (alive or dead), pulpwood, logs, or downed timber 8 feet or longer.

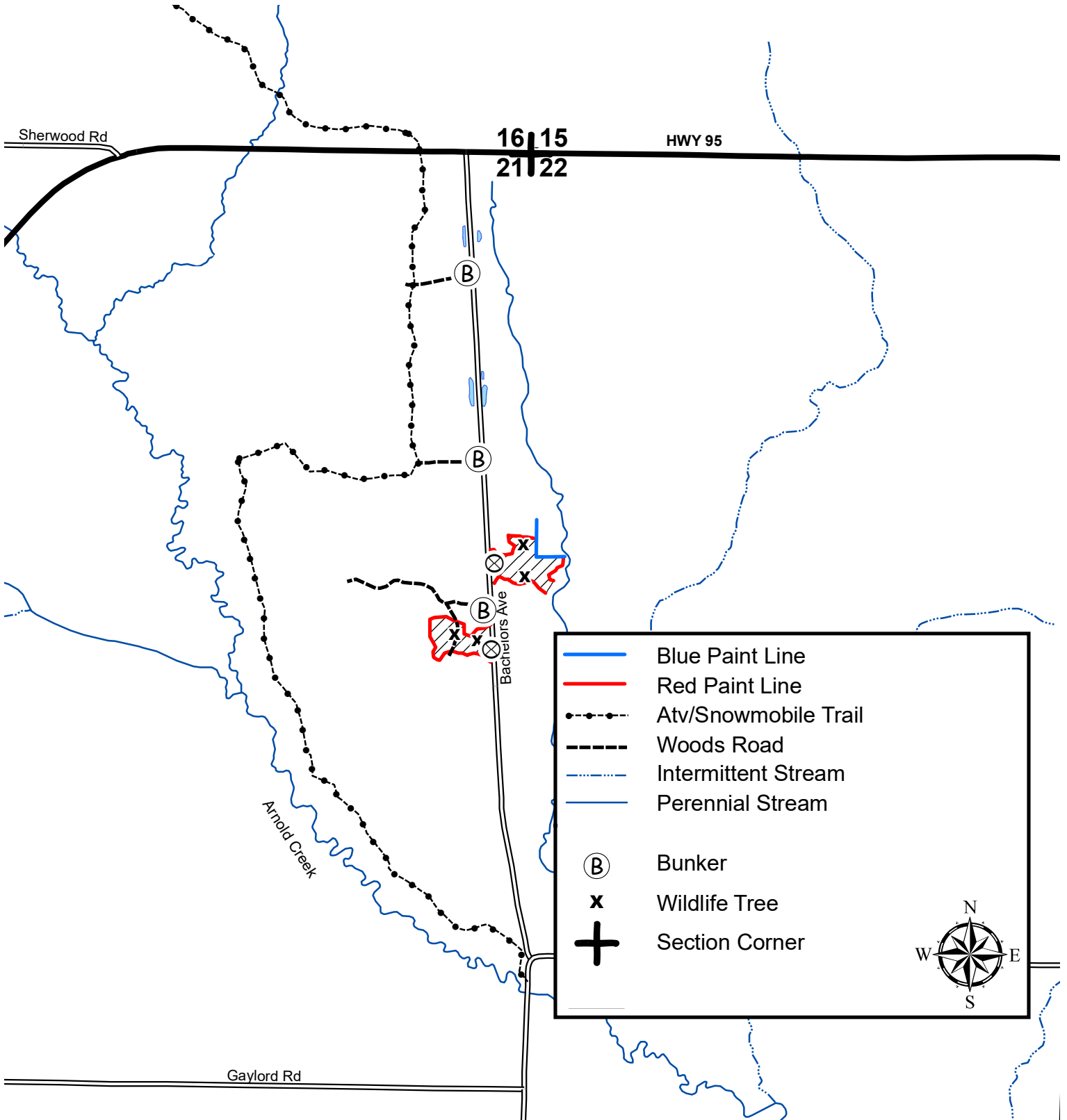

CLARK COUNTY FOREST
Firewood Permit Area 4-24
 Pt. of SE1/4 Section 35,
 N1/2 SW1/4, NWSE Section 36
 Township 25N Range 4W (South Foster)
 NENW, N1/2 NE 1/4 Section 2
 Township 24N Range 4W (Mentor)



Firewood Permit Area. May harvest trim, cull pieces, and non-merchantable logging debris. Do not cut any standing trees (alive or dead), pulpwood, logs, or downed timber 8 feet or longer.

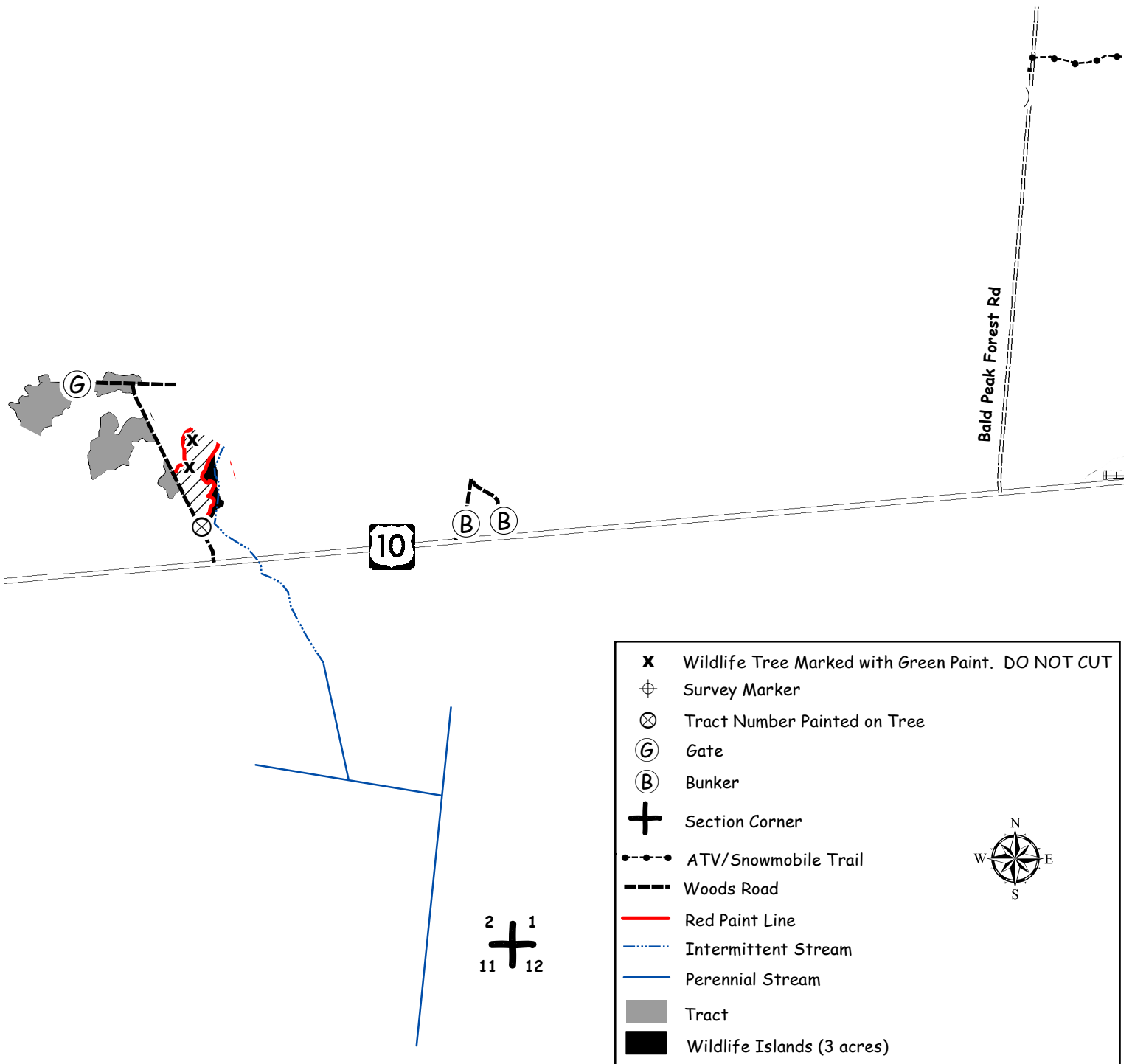

2 1
 11 + 12

CLARK COUNTY FOREST

Firewood Permit Area 6-24

Pt. of NENE, SENE, NESE, SESE Section 8

Pt of NWNW, SWNW, NWSW Section 9

Township 26N Range 4W (N. Foster)



Firewood Permit Area. May harvest trim, cull pieces, and non-merchantable logging debris. Do not cut any standing trees (alive or dead), pulpwood, logs, or downed timber 8 feet or longer.

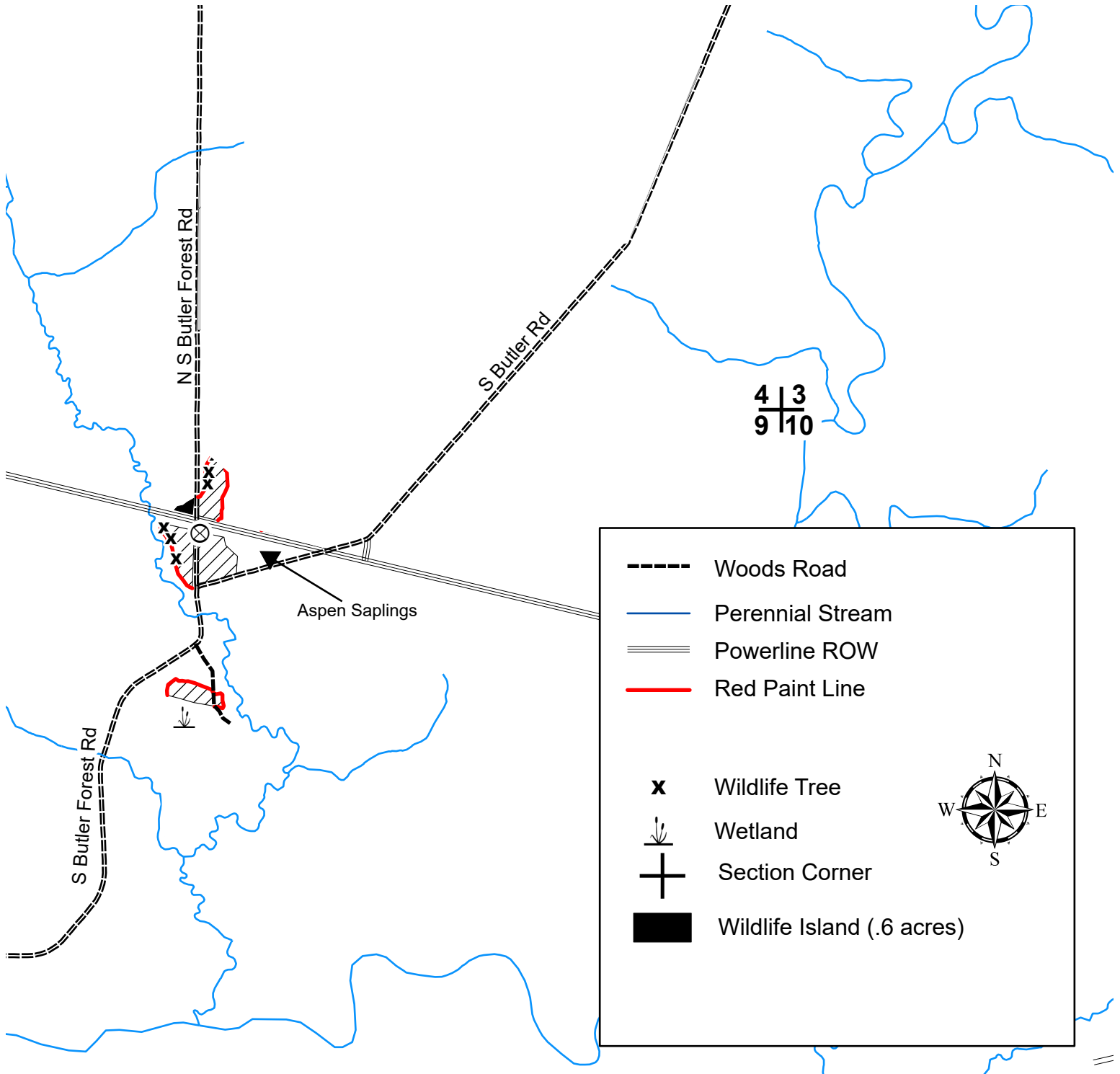

CLARK COUNTY FOREST

Firewood Permit Area 7-24

S1/2 NE1/4, SE1/4 Section 32

Township 27N Range 4W (Butler)





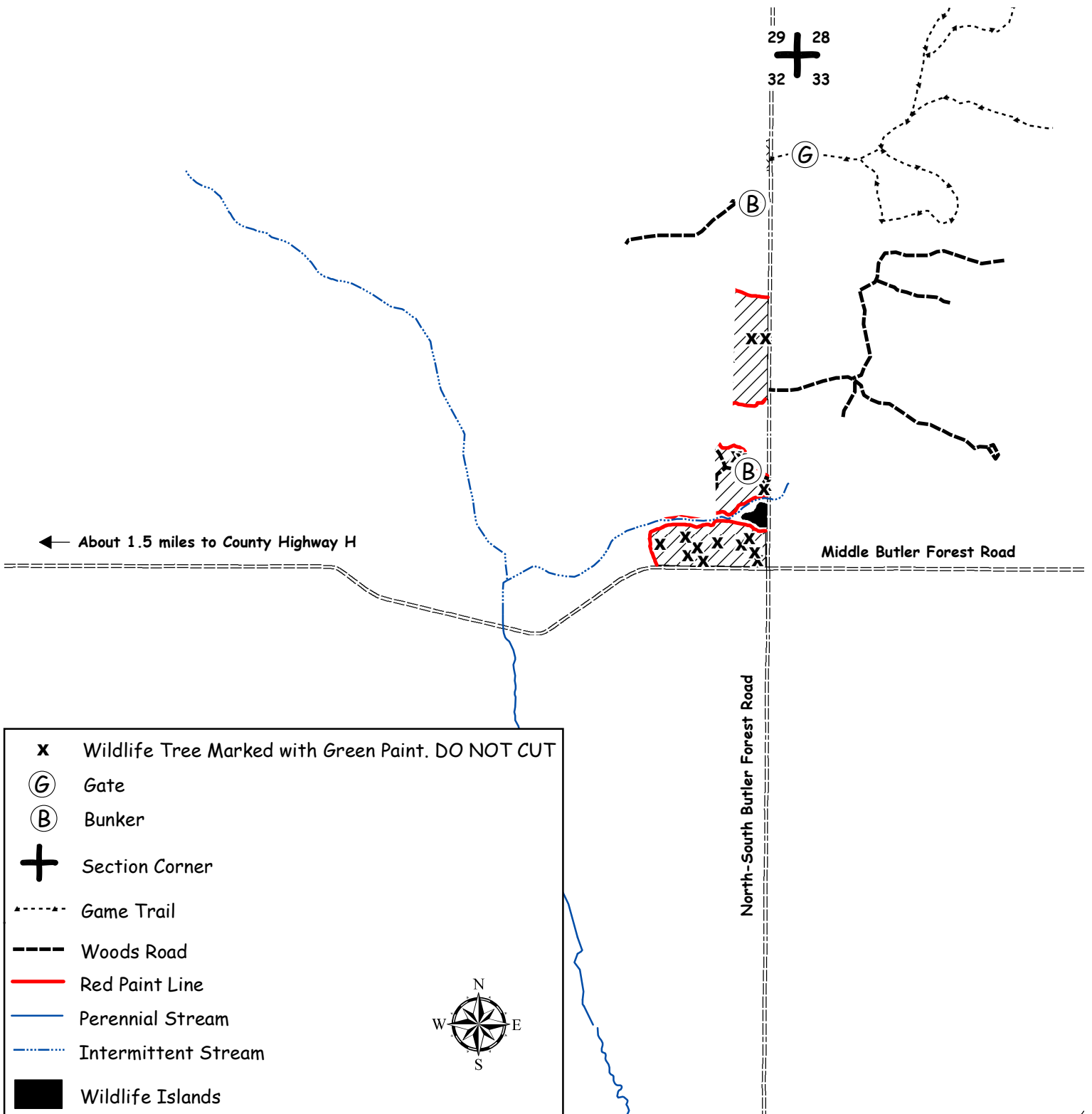





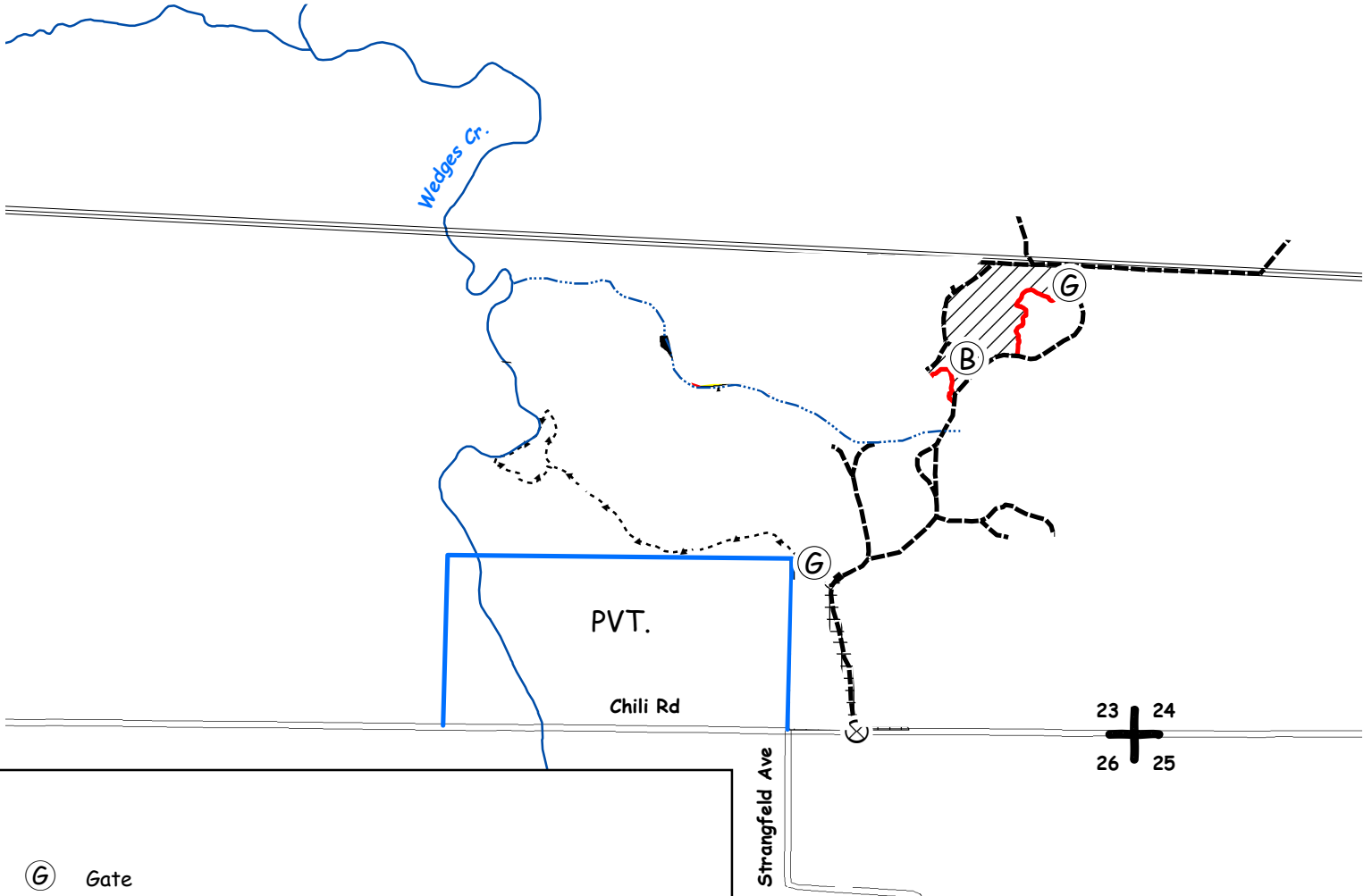

Firewood Permit Area. May harvest trim, cull pieces, and non-merchantable logging debris. Do not cut any standing trees (alive or dead), pulpwood, logs, or downed timber 8 feet or longer.



CLARK COUNTY FOREST
Firewood Permit Area 8-24
S1/2 NE1/4, SENW, E1/2 SE1/4 Section 23
Township 25N Range 3W (Seif)

 Firewood Permit Area. May harvest trim, cull pieces, and non-merchantable logging debris. Do not cut any standing trees (alive or dead), pulpwood, logs, or downed timber 8 feet or longer.



	Gate
	Bunker
	Section Corner
	Woods Road
	Flint Hills Pipeline.
	Game Trail
	Red Paint Line
	Blue Paint Line
	Intermittent Stream
	Perennial Stream





CLARK COUNTY FOREST
Firewood Permit Area 9-24
SWSW Section 25
W1/2 NE1/4, NWSE, S1/2 NW1/4 Section 36
Township 24N Range 04W (Mentor)

 Firewood Permit Area. May harvest trim, cull pieces, and non-merchantable logging debris. Do not cut any standing trees (alive or dead), pulpwood, logs, or downed timber 8 feet or longer.





x Wildlife Tree Marked with Green Paint. DO NOT CUT

 Gate

 Section Corner

 Wildcat Campground

 Woods Road

 ATV/Snowmobile Trail

 Mineral Fire Break

 Red Paint Line

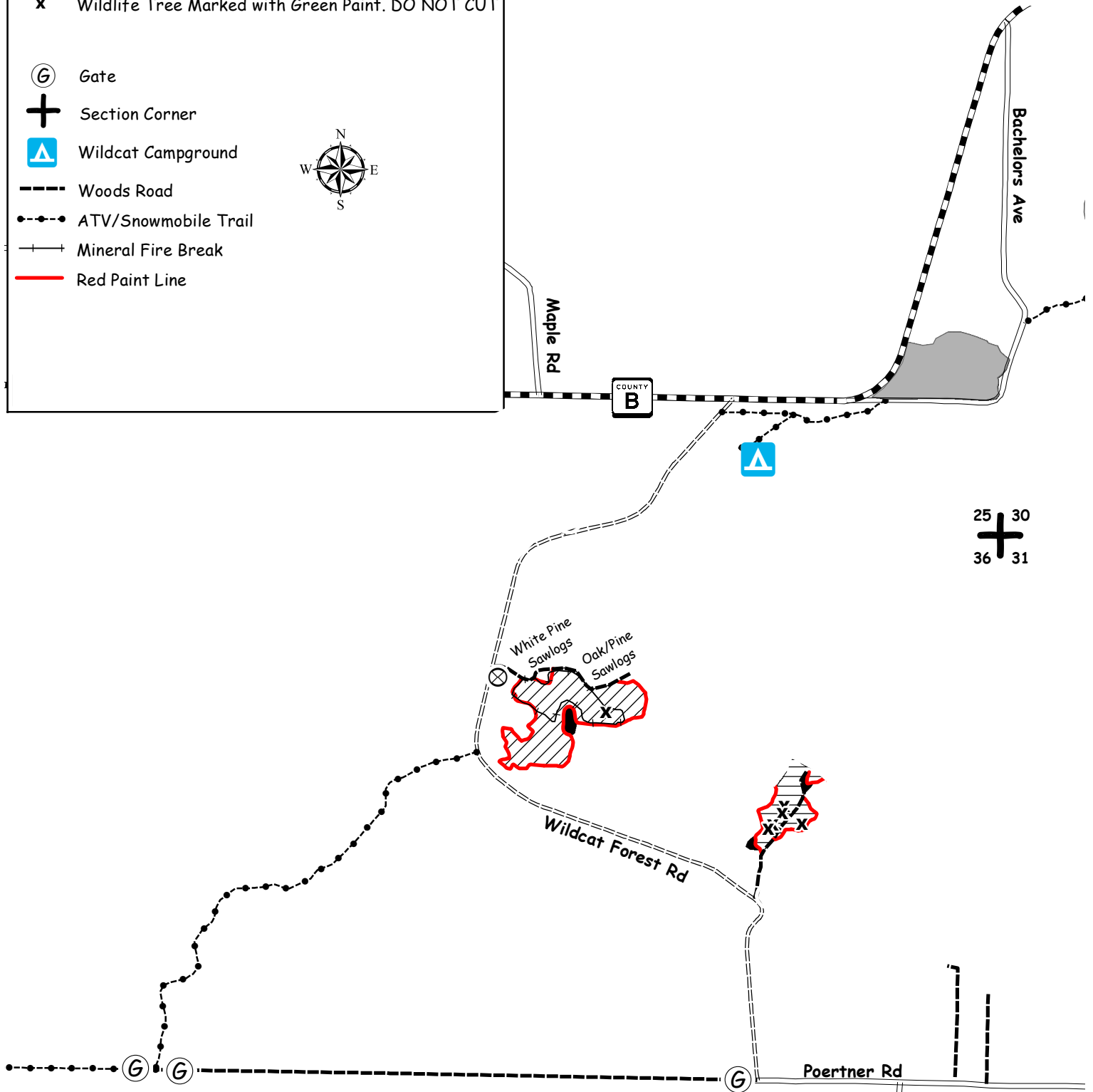
CLARK COUNTY FOREST
Firewood Permit Area 10-24
SWNW Section 30
Township 23N Range 3W (Dewhurst)



Firewood Permit Area. May harvest trim, cull pieces, and non-merchantable logging debris. Do not cut any standing trees (alive or dead), pulpwood, logs, or downed timber 8 feet or longer.

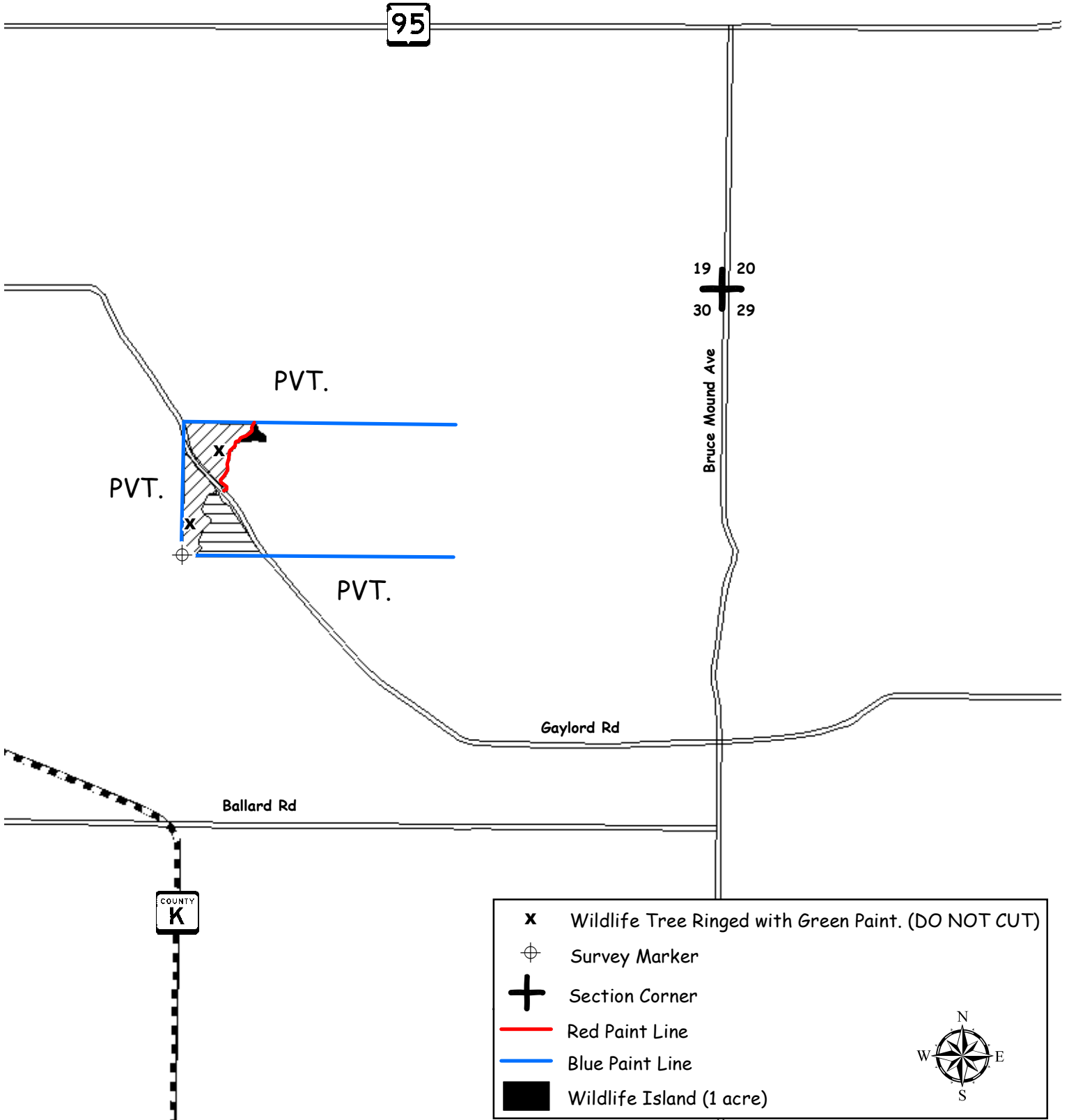

x	Wildlife Tree Ringed with Green Paint. (DO NOT CUT)
⊕	Survey Marker
+	Section Corner
	Red Paint Line
	Blue Paint Line
	Wildlife Island (1 acre)

CLARK COUNTY FOREST
Firewood Permit Area 11-24
S1/2 SW1/4, NESE, Section 27
S1/2 NE1/4, NESE, Section 28
Township 27N Range 03W (Mead)



Firewood Permit Area. May harvest trim, cull pieces, and non-merchantable logging debris. Do not cut any standing trees (alive or dead), pulpwood, logs, or downed timber 8 feet or longer.

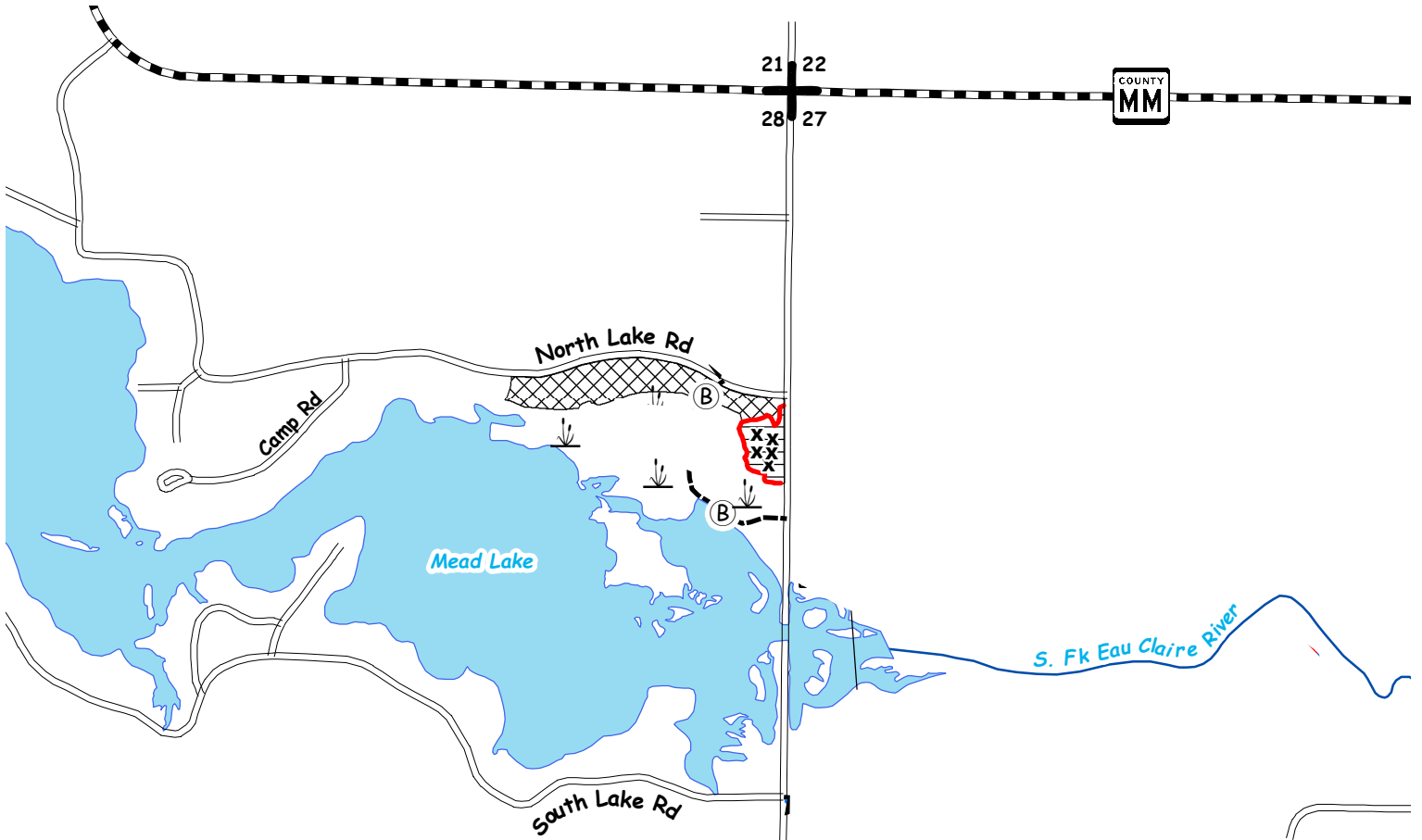

x	Wildlife Tree Marked with Green Paint. DO NOT CUT
(G)	Gate
(B)	Bunker
	Wetland
+	Section Corner
	Woods Road
	Perennial Stream
	Blue Paint Line
	Red Paint Line









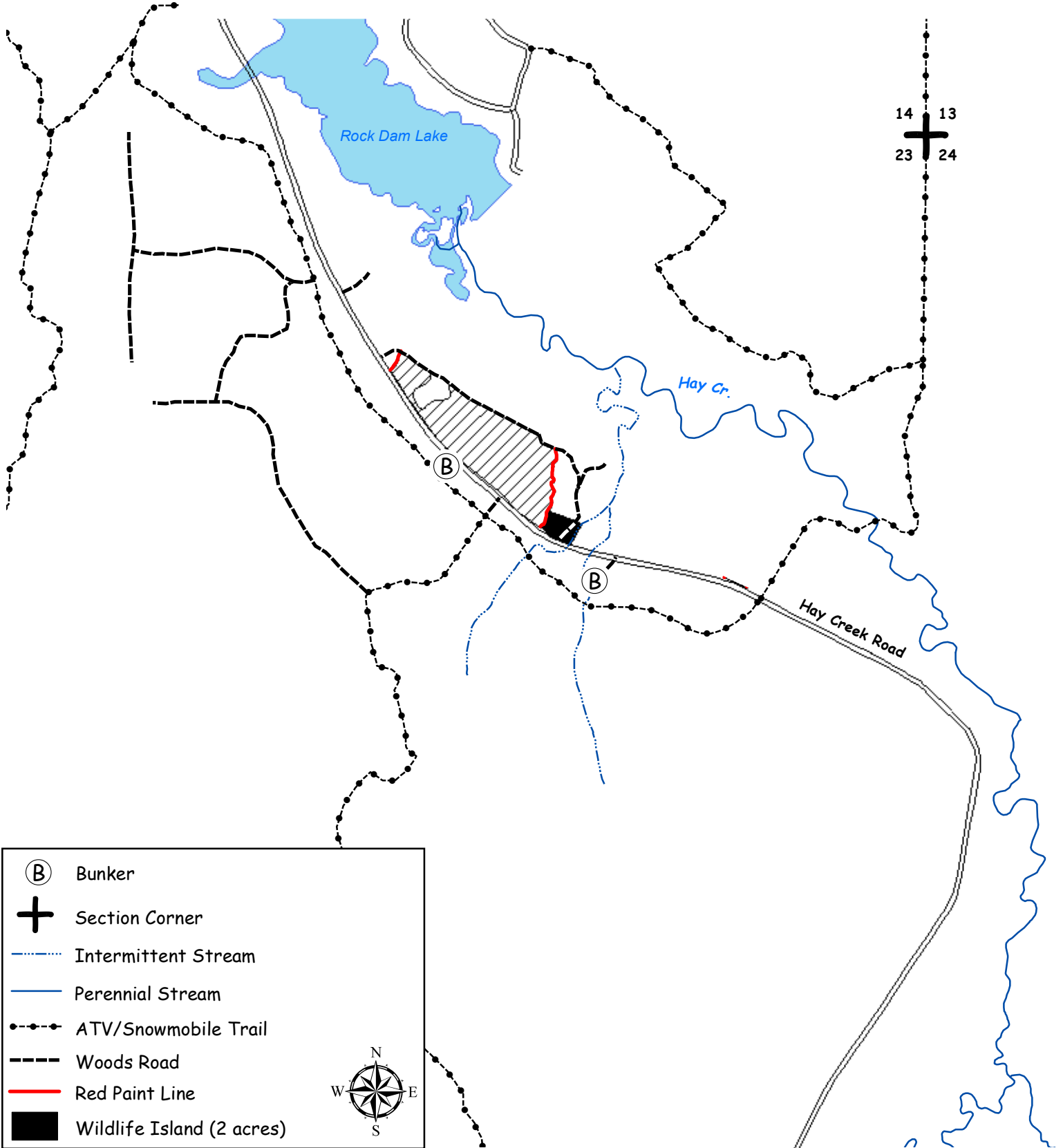

Bachelors Ave



CLARK COUNTY FOREST
Firewood Permit Area 12-24
 SWNW, NWSW, NWSE, SWSE, Section 23,
 Township 26N Range 4W (North Foster)

 Firewood Permit Area. May harvest trim, cull pieces, and non-merchantable logging debris. Do not cut any standing trees (alive or dead), pulpwood, logs, or downed timber 8 feet or longer.



	Bunker
	Section Corner
	Intermittent Stream
	Perennial Stream
	ATV/Snowmobile Trail
	Woods Road
	Red Paint Line
	Wildlife Island (2 acres)

CLARK COUNTY FOREST
Firewood Permit Area 13-24
N 1/2 NW 1/4, W 1/2 NE 1/4 Section 6
Township 24N Range 03W (Hewett)



Firewood Permit Area. May harvest trim, cull pieces, and non-merchantable logging debris. Do not cut any standing trees (alive or dead), pulpwood, logs, or downed timber 8 feet or longer.

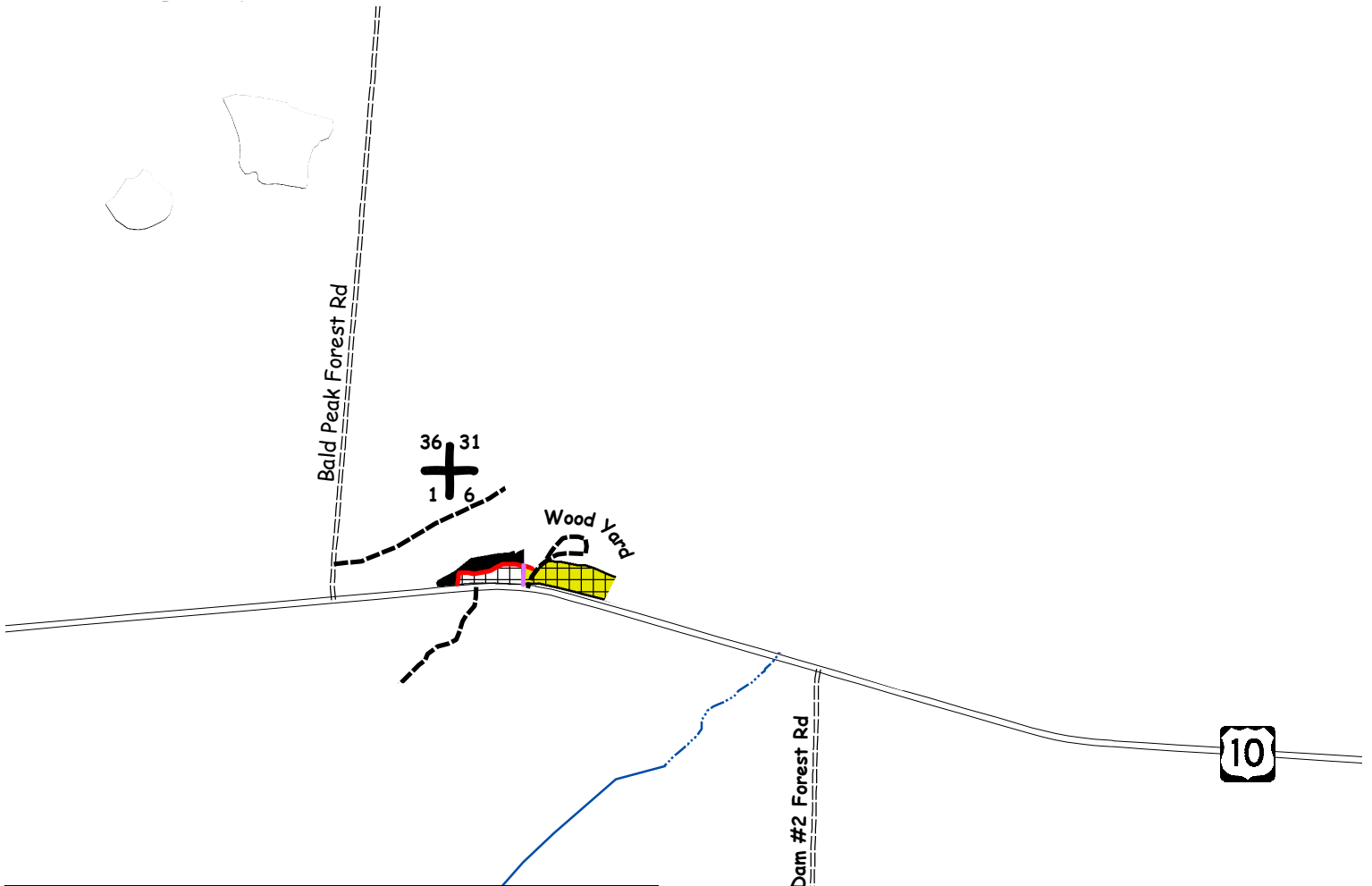

	Section Corner	
	Red Paint Line	
	Purple Paint Line	
	Perennial Stream	
	Intermittent Stream	
	Woods Road	

CLARK COUNTY FOREST

Firewood Permit Area 14-24

Pt. of SESW, SWSE, SESE Section 29
Pt. of NW 1/4, W1/2 NE 1/4 Section 32
Township 27N Range 3W (Mead)



Firewood Permit Area. May harvest trim, cull pieces, and non-merchantable logging debris. Do not cut any standing trees (alive or dead), pulpwood, logs, or downed timber 8 feet or longer.

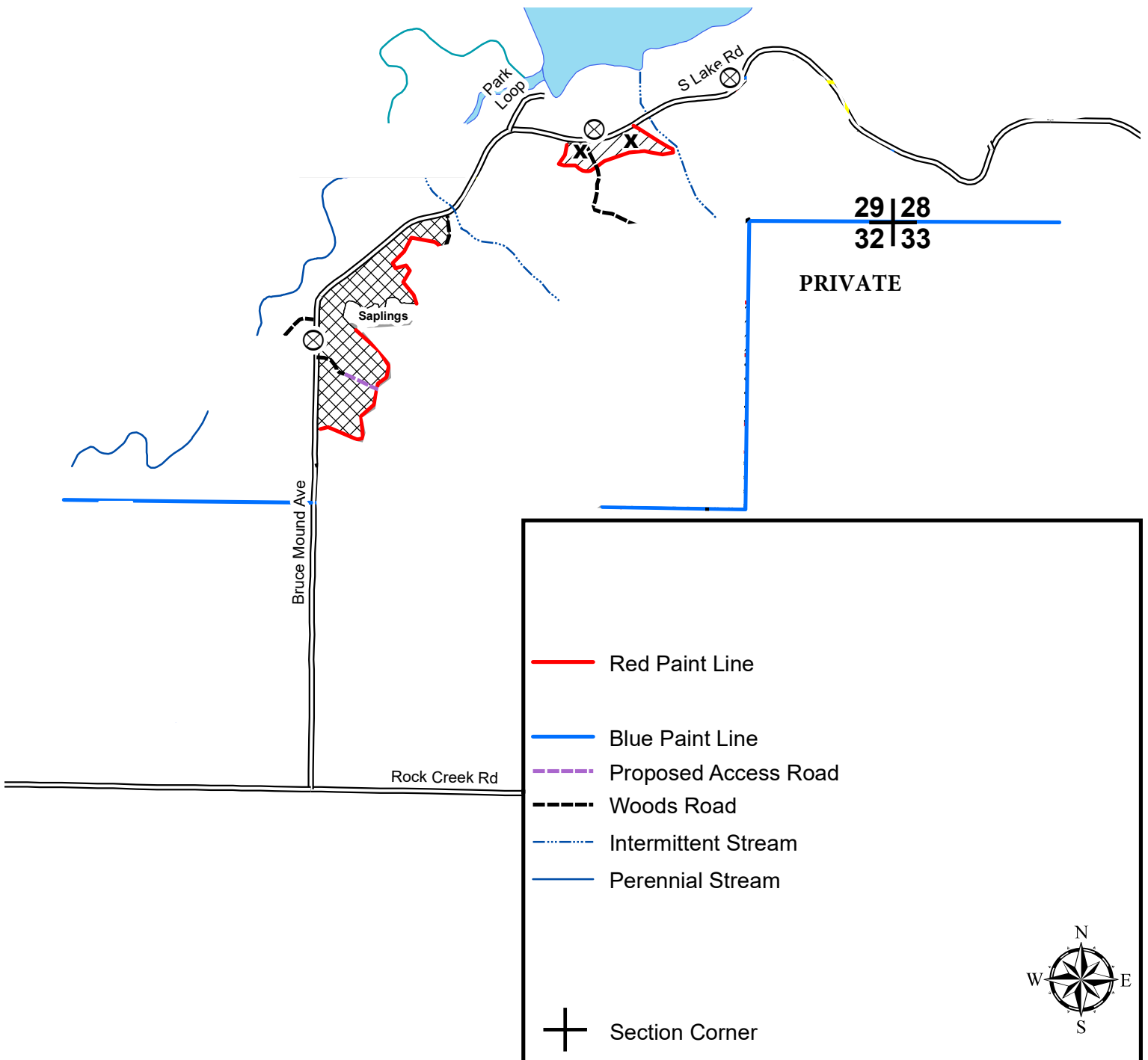

CLARK COUNTY FOREST
Firewood Permit Area 15-24
NWNW Section 16, NENE Section 17,
NWNW Section 18
Township 27N Range 4W (Butler)



Firewood Permit Area. May harvest trim, cull pieces, and non-merchantable logging debris. Do not cut any standing trees (alive or dead), pulpwood, logs, or downed timber 8 feet or longer.

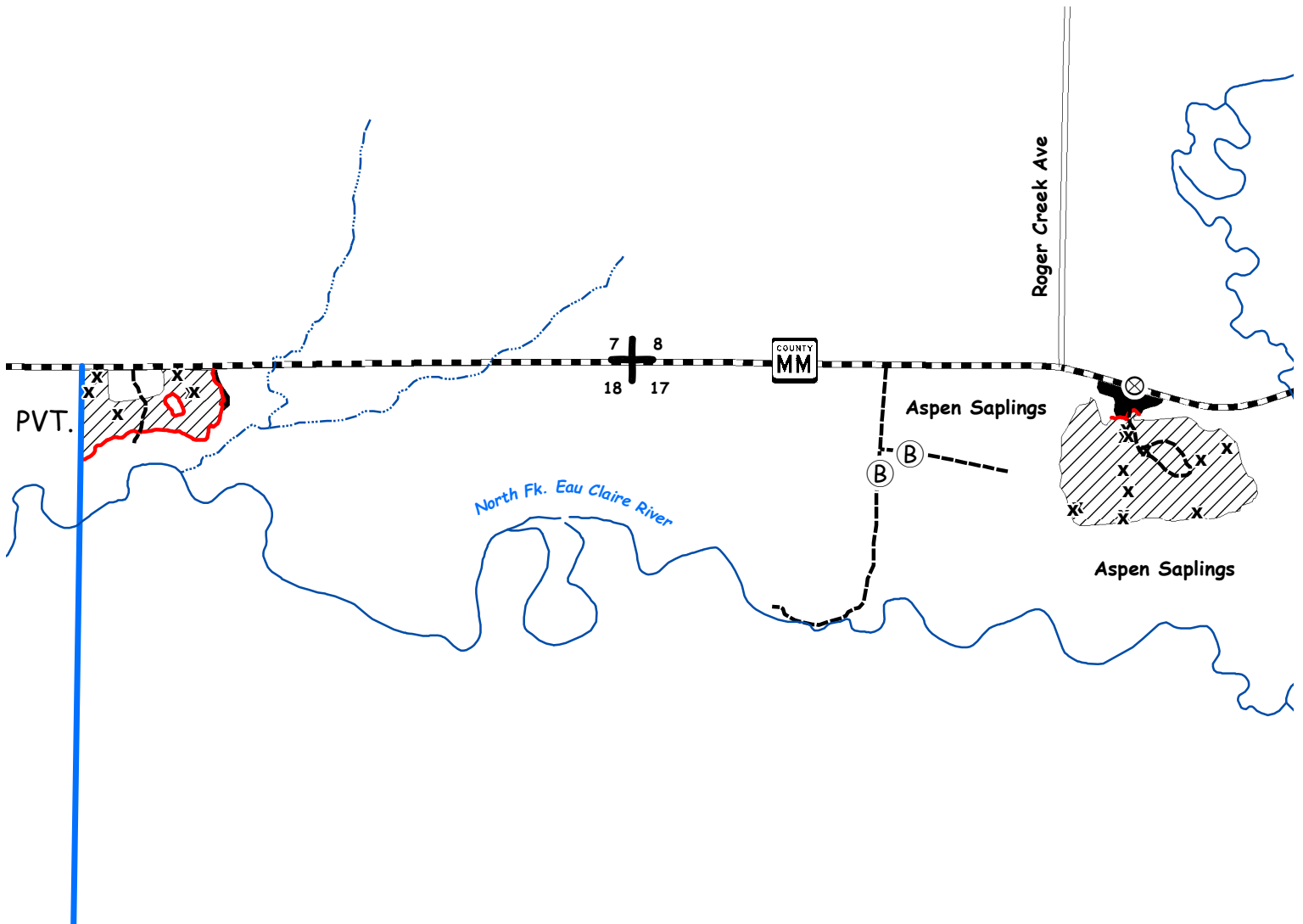

x	Wildlife Tree Marked with Green Paint. DO NOT CUT
(B)	Bunker
+	Section Corner
---	Woods Road
.....	Intermittent Stream
—	Perennial Stream
—	Red Paint Line
—	Blue Paint Line
■	Wildlife Islands (3 acres)



Scale 1:18,000

CLARK COUNTY FOREST
Firewood Permit Area 16-24
E1/2 NE 1/4, Section 34,
W 1/2 NW 1/4 Section 35
Township 27N Range 4W (Butler)
Sale Established By: J. Woodley & S. Neisius



Firewood Permit Area. May harvest trim, cull pieces, and non-merchantable logging debris. Do not cut any standing trees (alive or dead), pulpwood, logs, or downed timber 8 feet or longer.

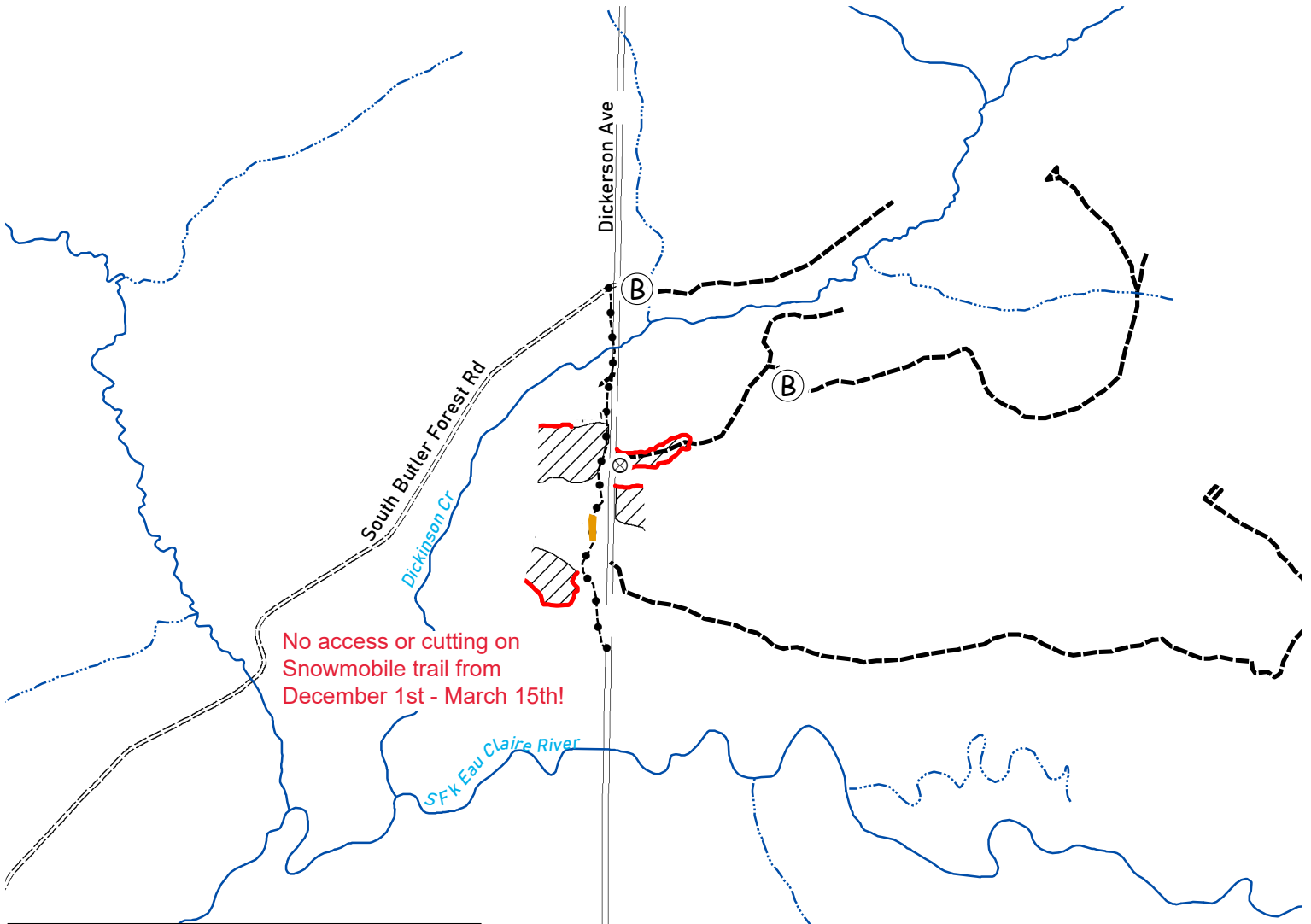

	Tract Number Painted on Tree
	Bunker
	Section Corner
	Snowmobile Trail
	Woods Road
	Red Paint Line
	Perennial Stream
	Intermittent Stream

34 35
 3 2

F
 E

CLARK COUNTY FOREST
Firewood Permit Area 17-24
S1/2 SW 1/4 Section 23
NWNW Section 26
E1/2 NE 1/4 & W1/2 SE 1/4 Sec 27
Township 25N Range 04W (S Foster)



Firewood Permit Area. May harvest trim, cull pieces, and non-merchantable logging debris. Do not cut any standing trees (alive or dead), pulpwood, logs, or downed timber 8 feet or longer.

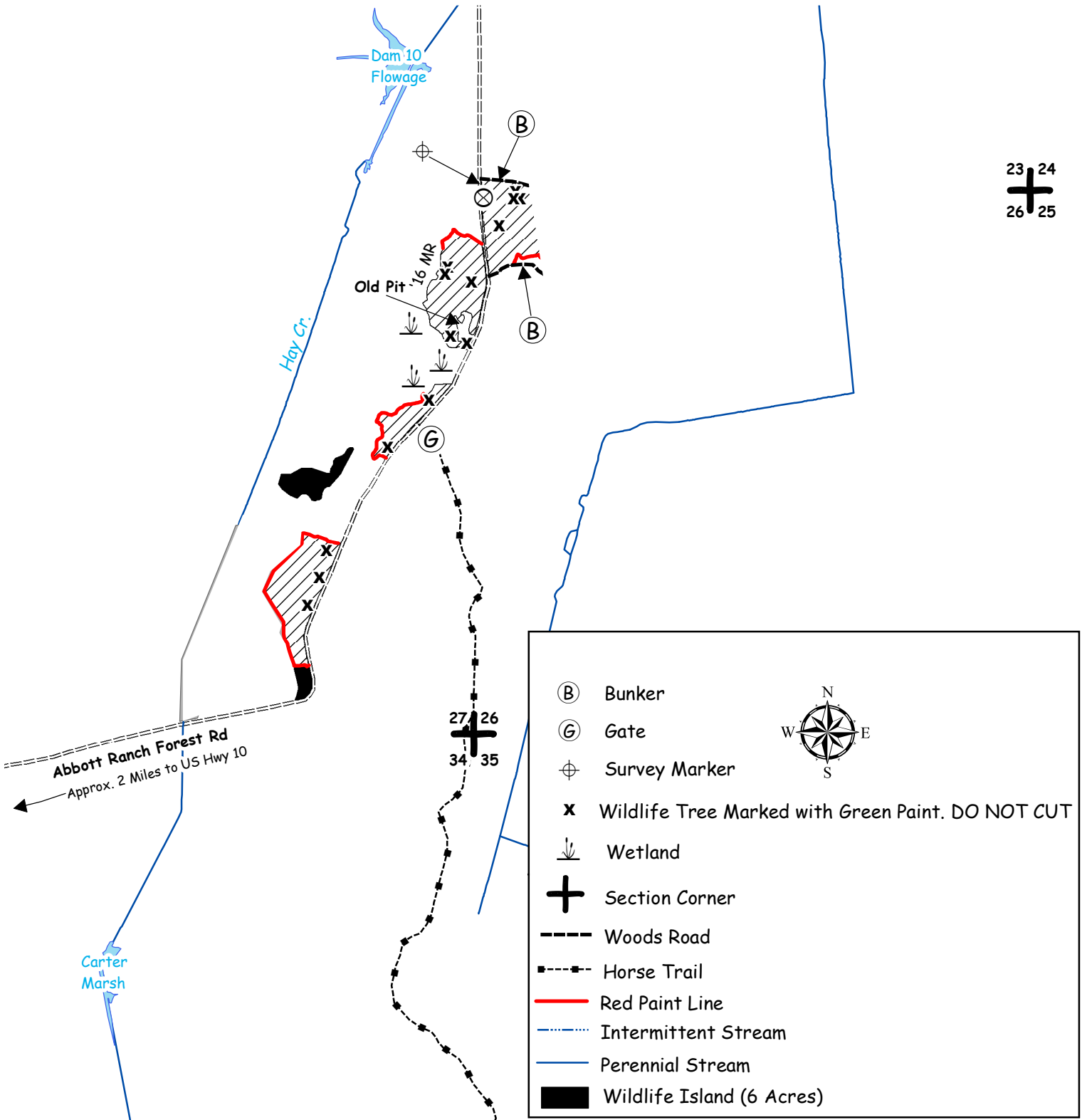

CLARK COUNTY FOREST

Firewood Permit Area 18-24

N1/2 SW1/4 Section 30

Township 25N Range 3W (Seif)



Firewood Permit Area. May harvest trim, cull pieces, and non-merchantable logging debris. Do not cut any standing trees (alive or dead), pulpwood, logs, or downed timber 8 feet or longer.

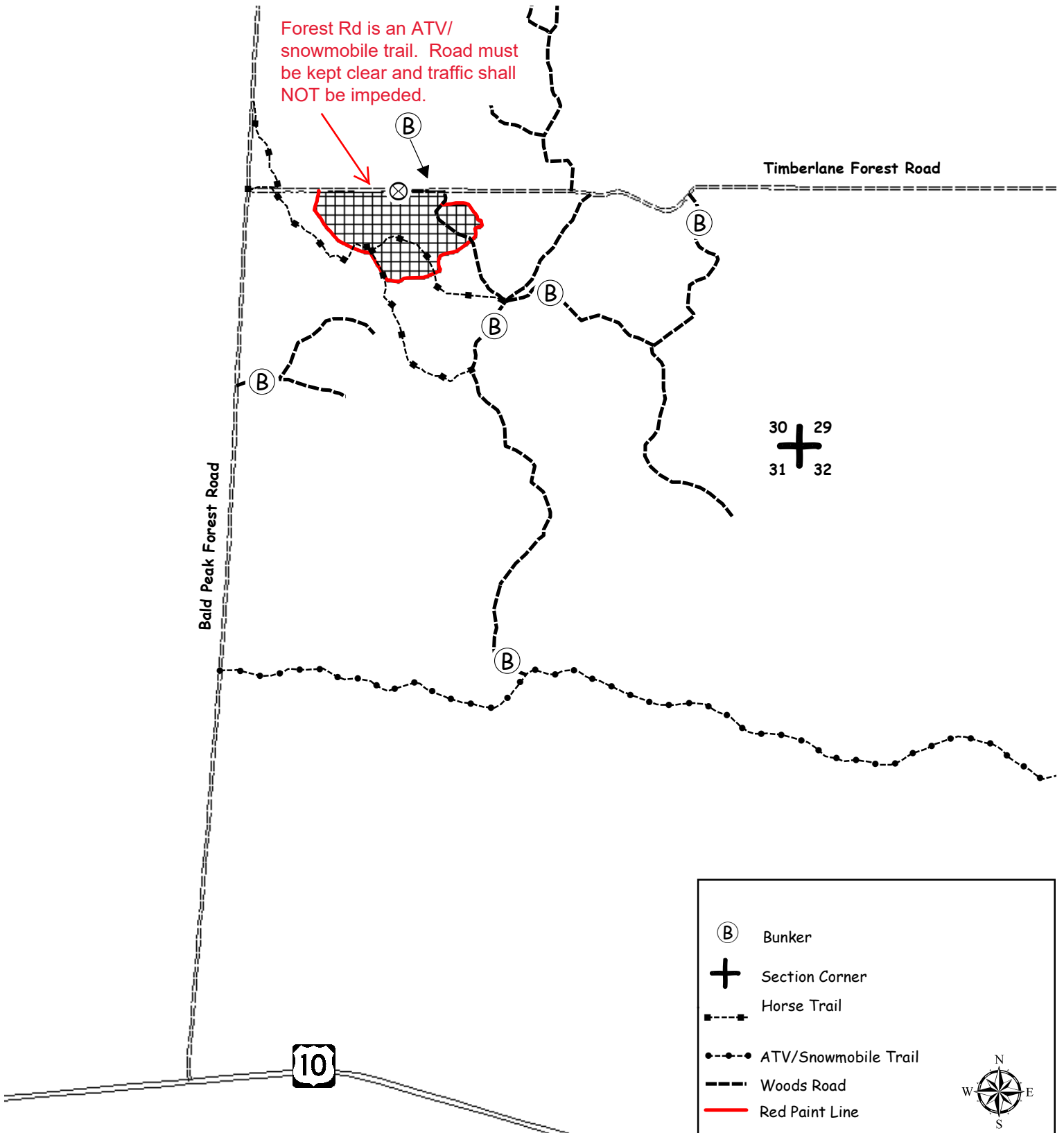

CLARK COUNTY FOREST
Firewood Permit Area 19-24
 N1/2 SE1/4, E1/2 SW1/4, SWSW, Section 28,
 NESE Section 29
 Township 23N Range 3W (Dewhurst)



Firewood Permit Area. May harvest trim, cull pieces, and non-merchantable logging debris. Do not cut any standing trees (alive or dead), pulpwood, logs, or downed timber 8 feet or longer.

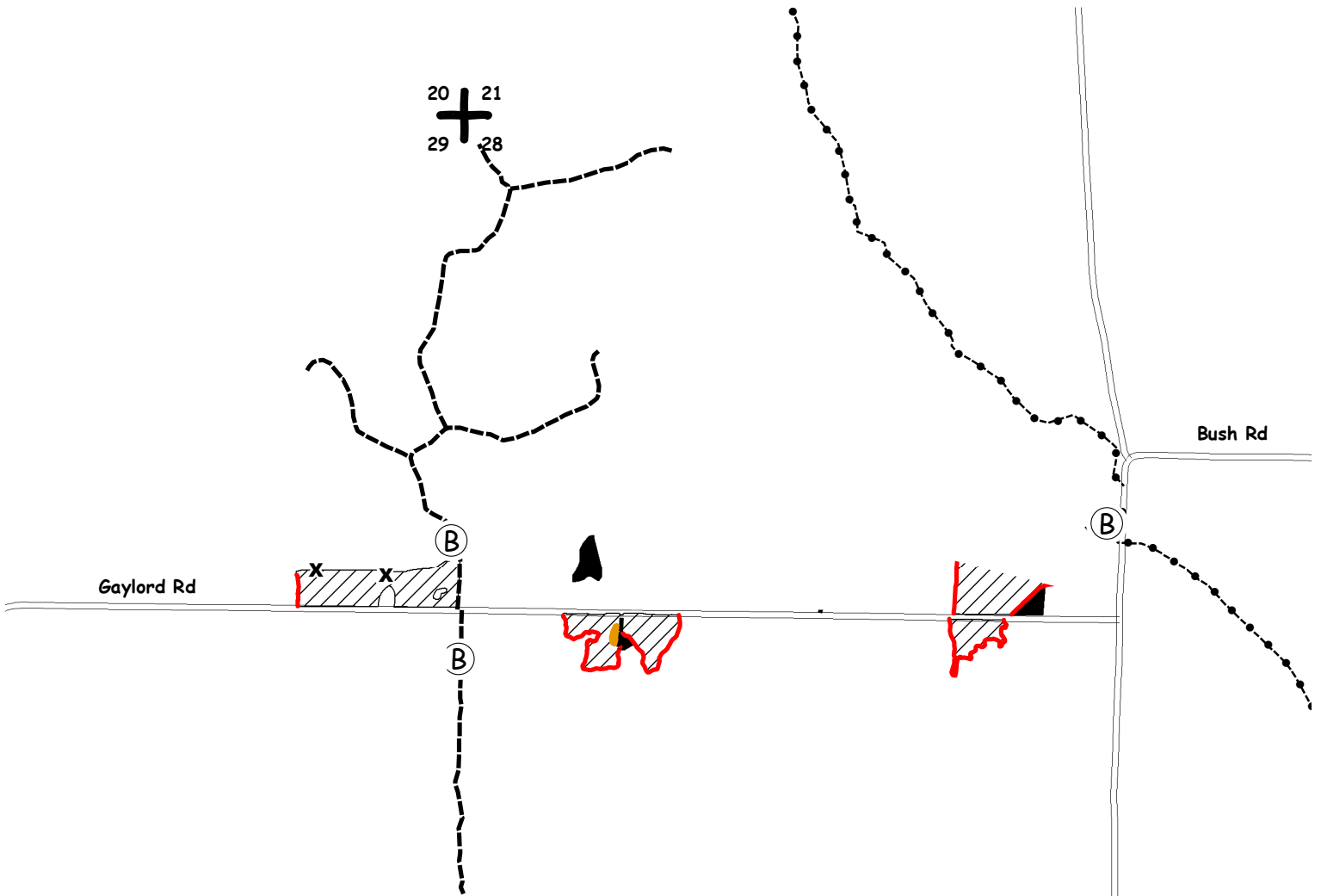

x	Wildlife Tree Marked with Green Paint. (DO NOT CUT)
(B)	Bunker
+	Section Corner
---•---	ATV/Snowmobile Trail
---	Woods Road
---	Red Paint Line
■	Wildlife Island (2 acres)

Bachelors Ave

CLARK COUNTY FOREST
Firewood Permit Area 20-24
Pt. of SESE Section 12
Pt. of SENE & NESE Section 13
Township 24N Range 04W (Mentor)



Firewood Permit Area. May harvest trim, cull pieces, and non-merchantable logging debris. Do not cut any standing trees (alive or dead), pulpwood, logs, or downed timber 8 feet or longer.

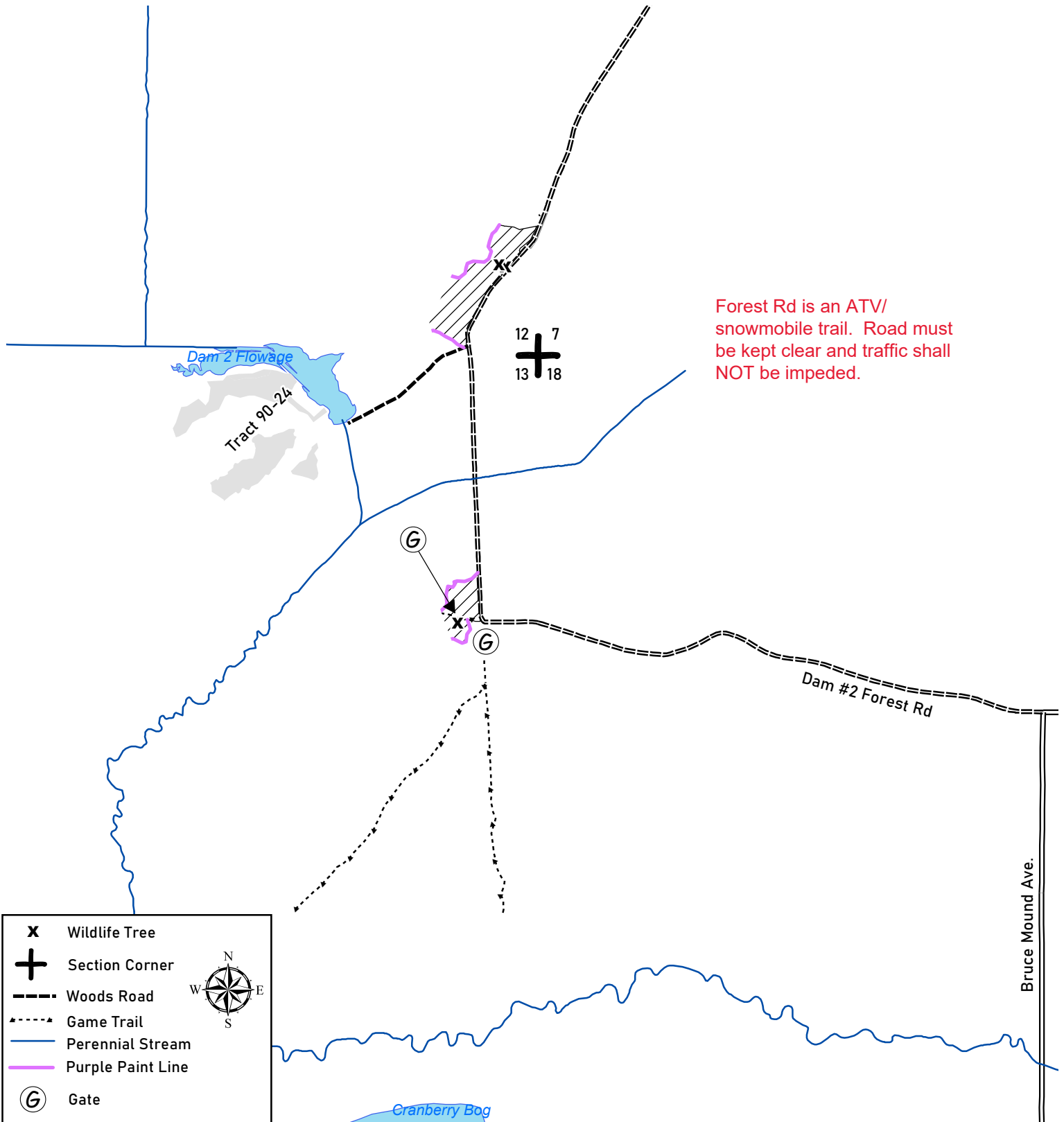

Forest Rd is an ATV/
snowmobile trail. Road must
be kept clear and traffic shall
NOT be impeded.

X	Wildlife Tree	
+	Section Corner	
- - -	Woods Road	
· · · · ·	Game Trail	
—	Perennial Stream	
—	Purple Paint Line	
G	Gate	

CLARK COUNTY FOREST
Firewood Permit Area 21-24
SENE Section 35,
NWNE, S1/2 NW1/4, N1/2 S1/2 Section 36
Township 24N Range 3W (Hewett)



Firewood Permit Area. May harvest trim, cull pieces, and non-merchantable logging debris. Do not cut any standing trees (alive or dead), pulpwood, logs, or downed timber 8 feet or longer.

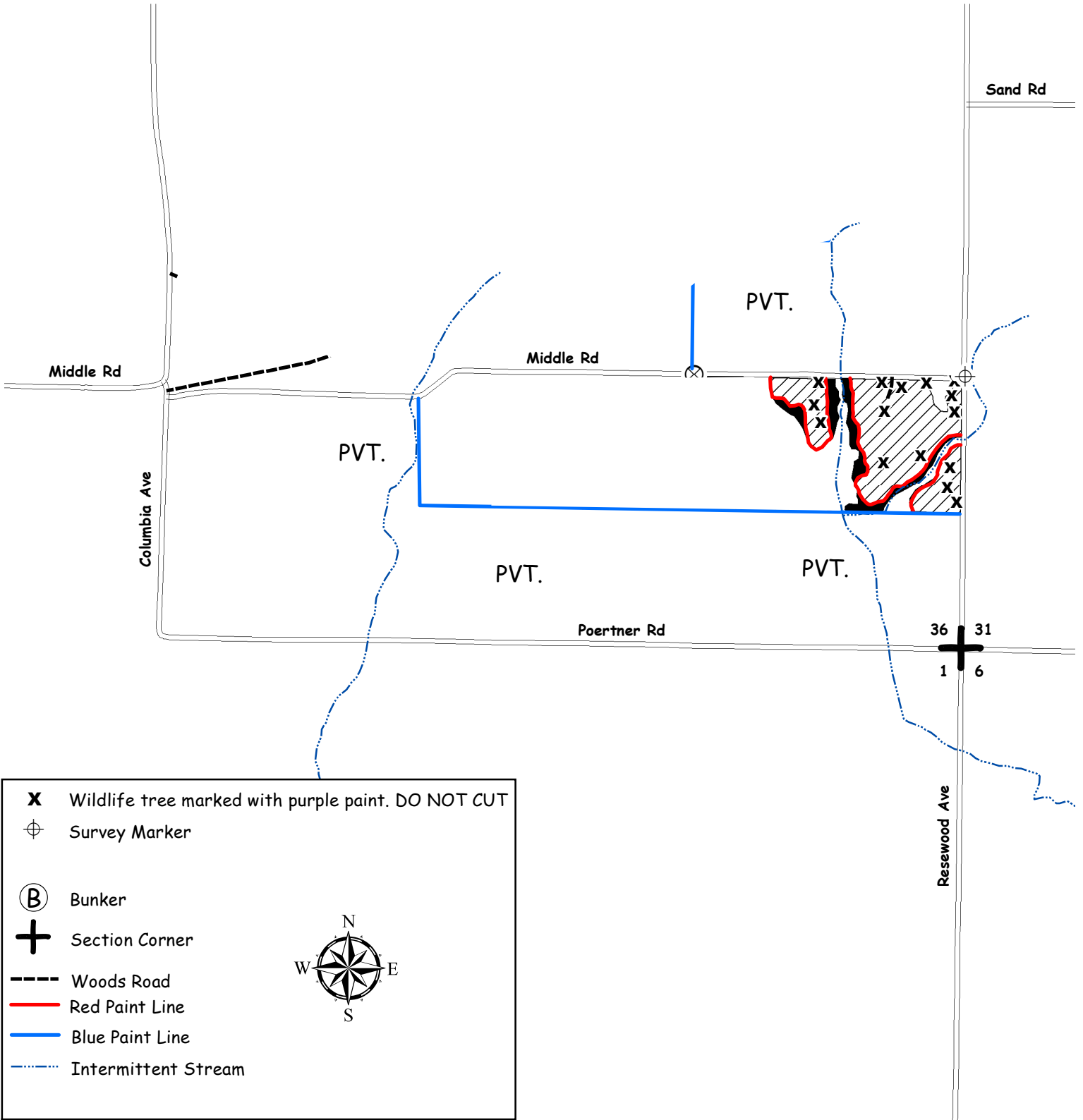

- X** Wildlife tree marked with purple paint. DO NOT CUT
- Survey Marker
- Bunker
- Section Corner
- Woods Road
- Red Paint Line
- Blue Paint Line
- Intermittent Stream



CLARK COUNTY FOREST

Firewood Permit Area 2-23

Pt. of SWNE Section 18, Township 24N Range 3W (Hewett);



Firewood Permit Area. May harvest trim, cull pieces, and non-merchantable logging debris. Do not cut any standing trees (alive or dead), pulpwood, logs, or downed timber 8 feet or longer.

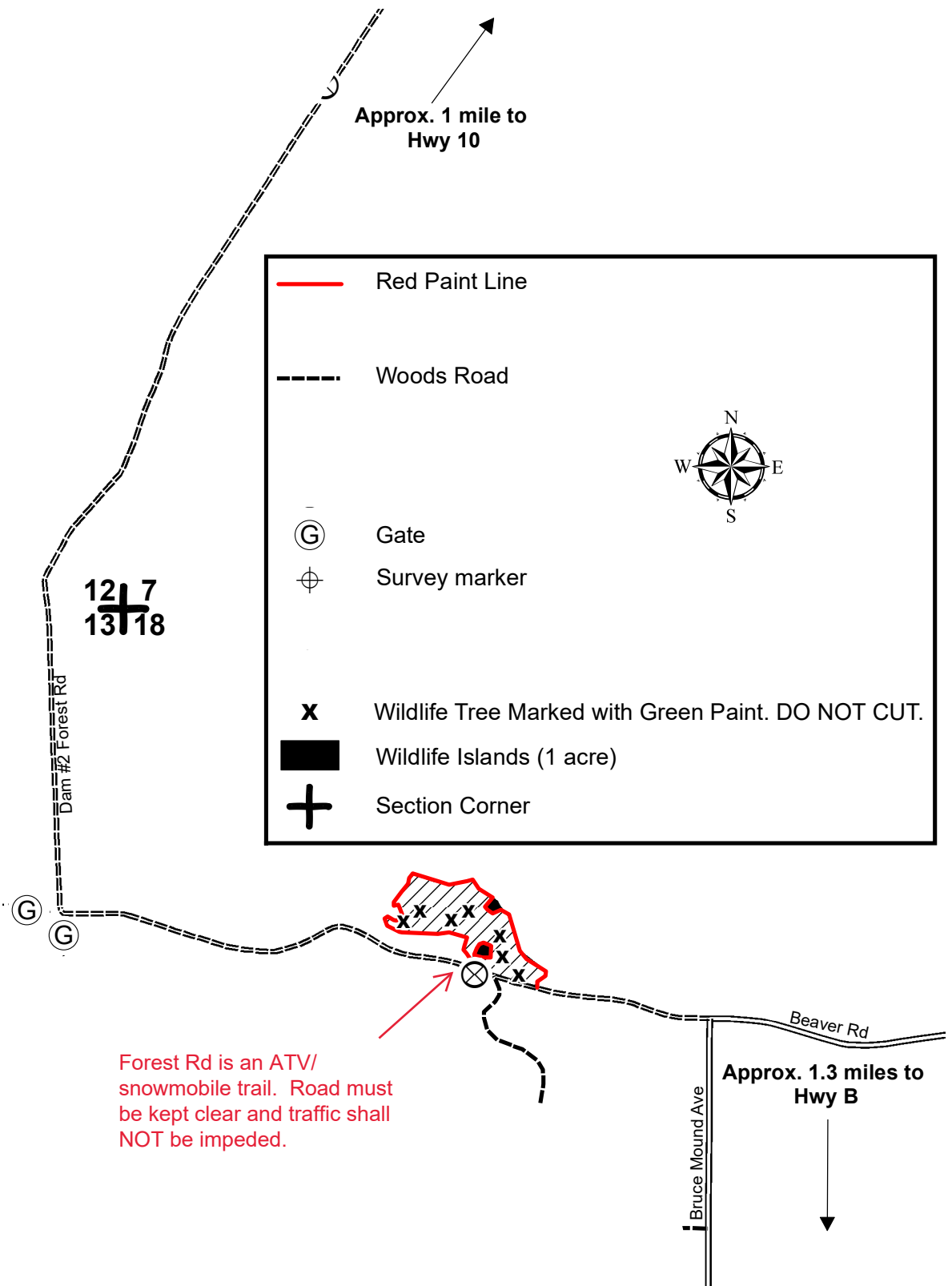

CLARK COUNTY FOREST
Firewood Permit Area 3-23
SENE, E1/2 SE 1/4 Section 28
Township 23N Range 1E (Sherwood)

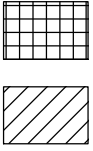

Firewood Permit Area. May harvest trim, cull pieces, and non-merchantable logging debris. Do not cut any standing trees (alive or dead), pulpwood, logs, or downed timber 8 feet or longer.

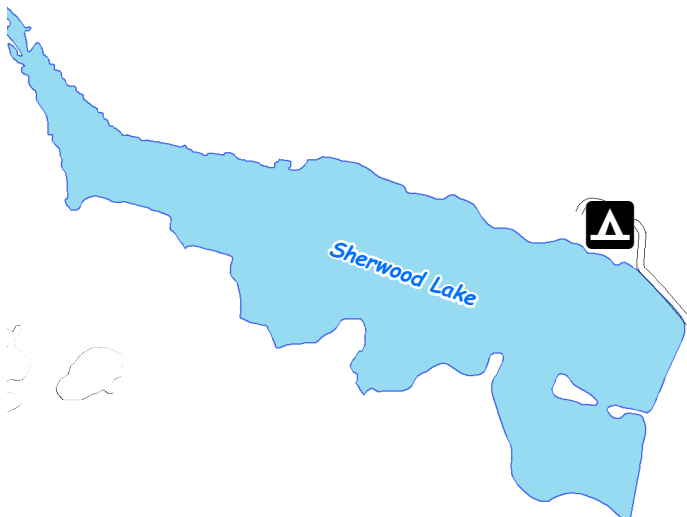
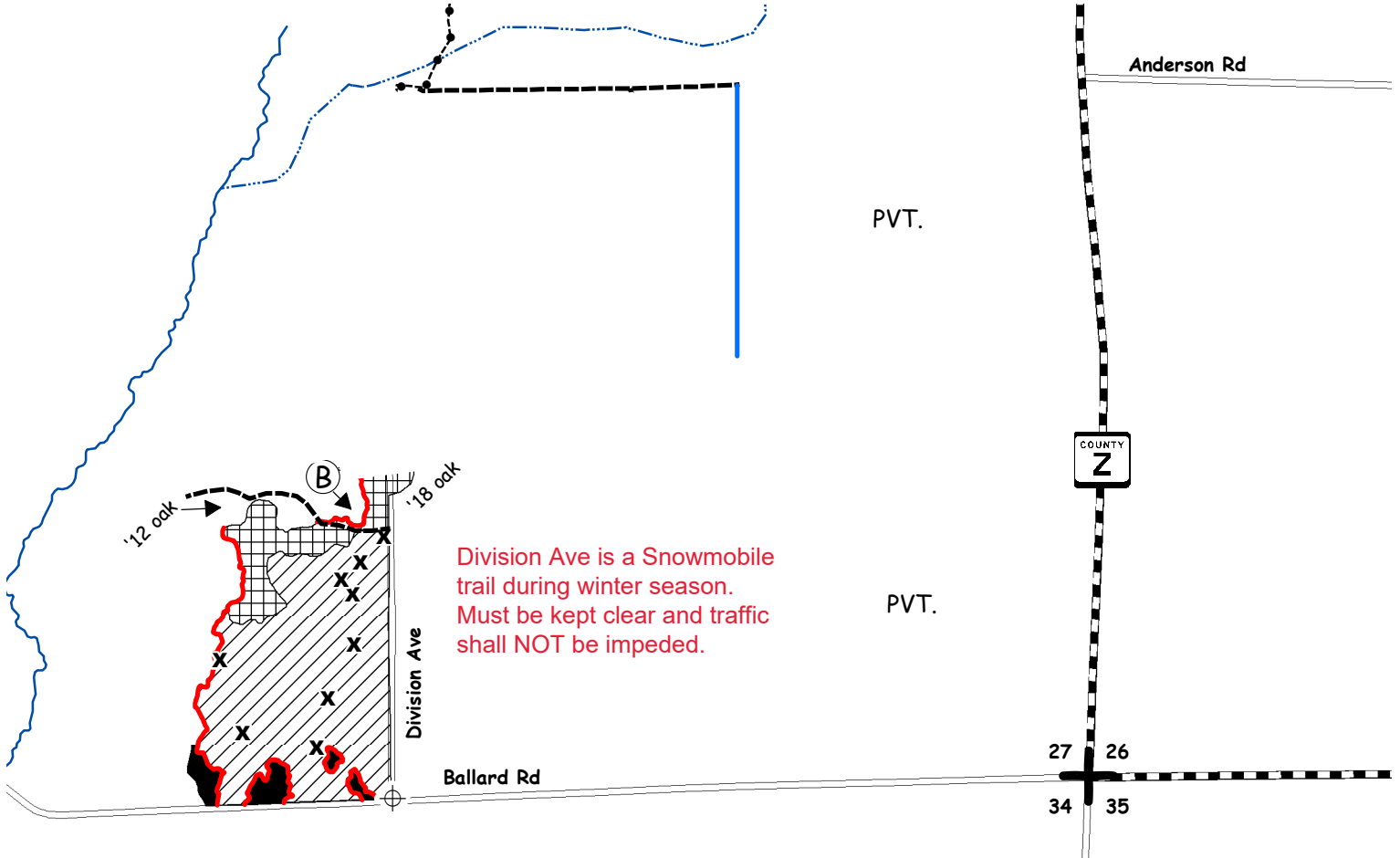

x	Wildlife Tree Marked with Green Paint. DO NOT CUT.
⊕	Survey Marker
(G)	Gate
(B)	Bunker
+	Section Corner
---	Woods Road
⋯	Intermittent Stream
—	Perennial Stream
—	Blue Paint Line
—	Red Paint Line
▲	Sherwood Park Campground
■	Wildlife Islands (5 acres)



CLARK COUNTY FOREST

Firewood Permit Area 6-23

W 1/2 SE 1/4 Sec. 8

E 1/2 NW 1/4 Sec. 17

Township 27N Range 4W (Butler)



Firewood Permit Area. May harvest trim, cull pieces, and non-merchantable logging debris. Do not cut any standing trees (alive or dead), pulpwood, logs, or downed timber 8 feet or longer.

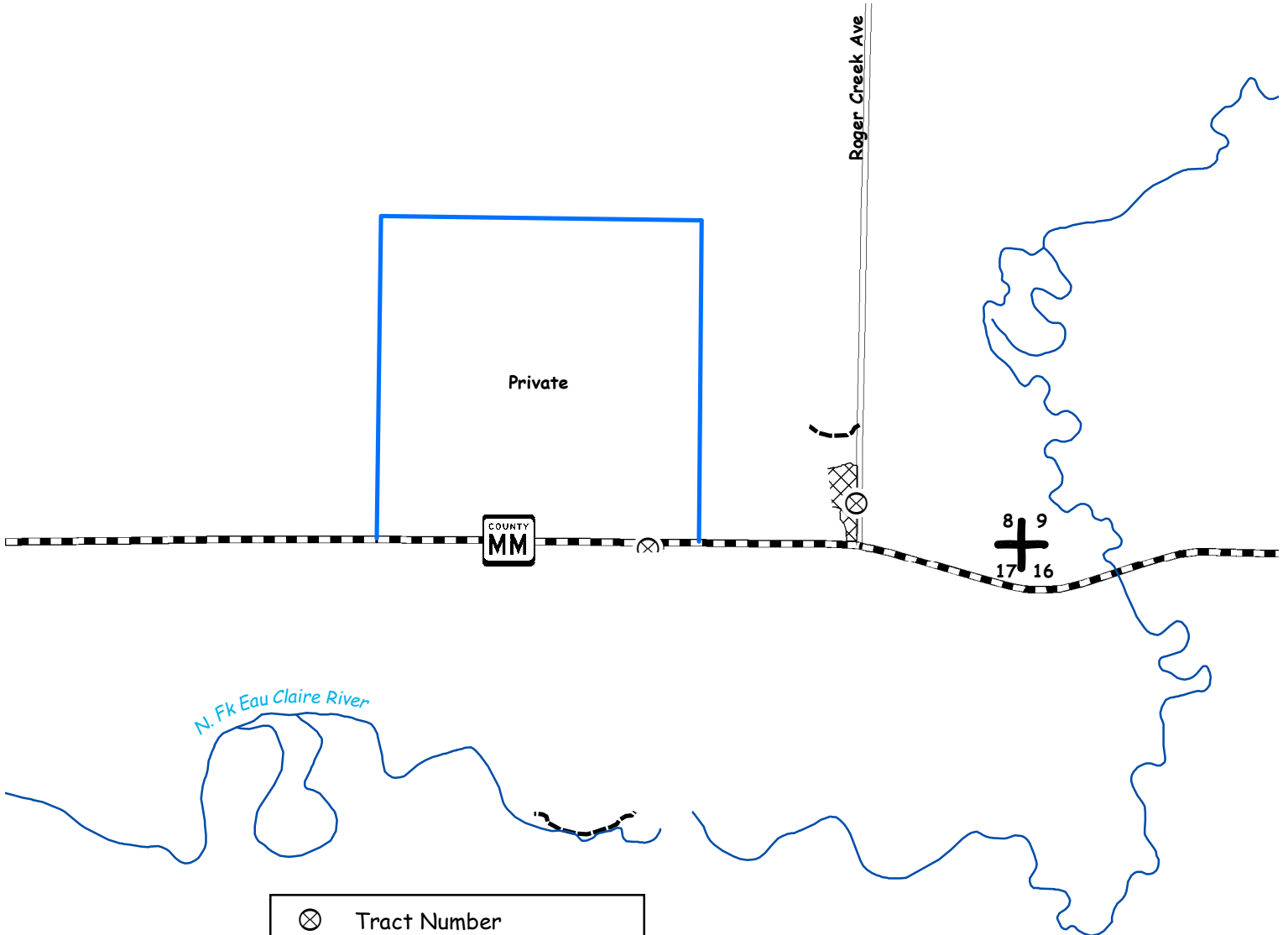

⊗	Tract Number
+	Section Corner
---	Woods Road
—	Perennial Stream
—	Blue Paint Line



CLARK COUNTY FOREST

Firewood Permit Area 7-23

Pt. of S 1/2 Section 11
Township 26N Range 4W (N. Foster)

Firewood Permit Area. May harvest trim, cull pieces, and non-merchantable logging debris.
Do not cut any standing trees (alive or dead), pulpwood, logs, or downed timber 8 feet or longer.

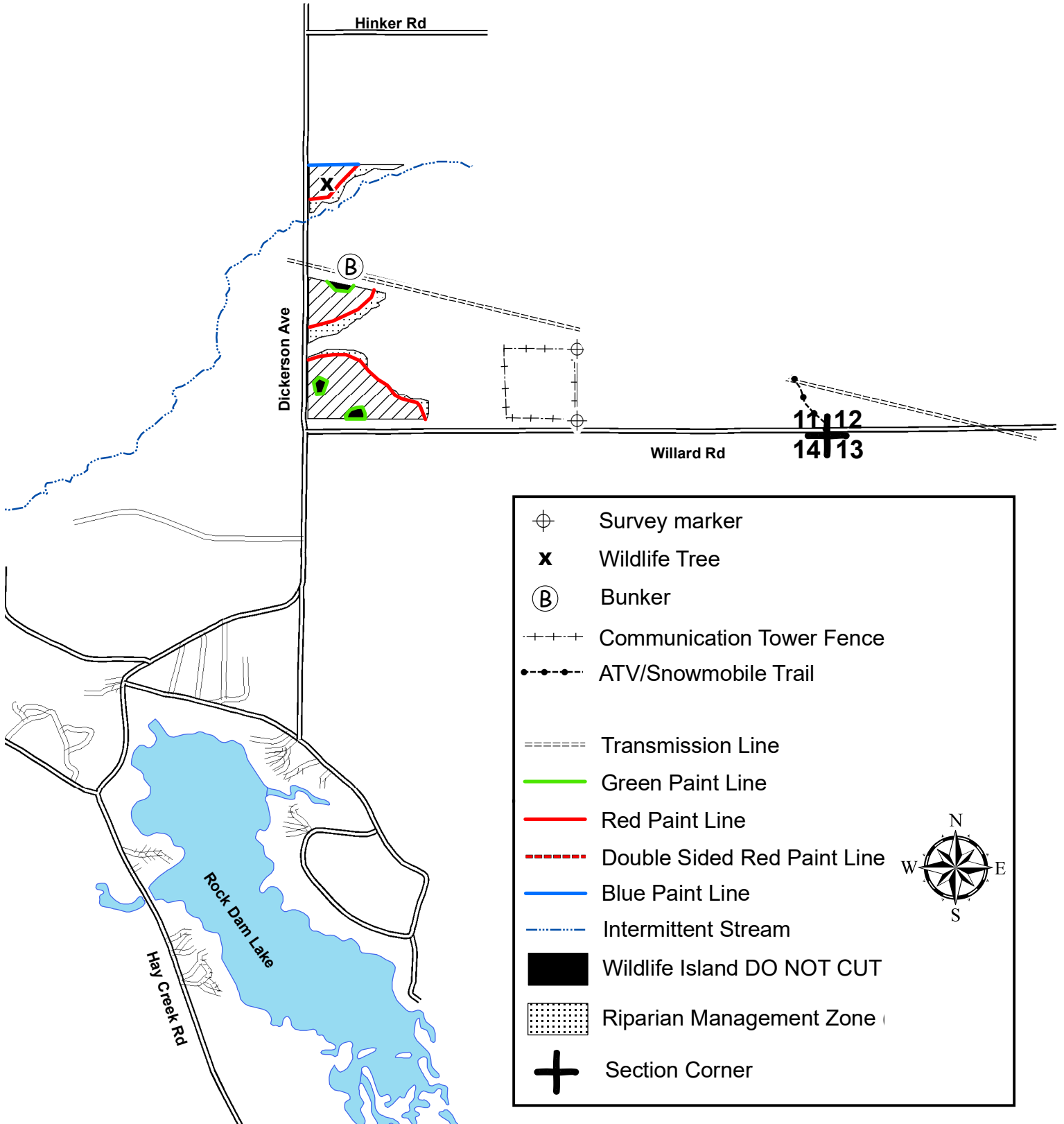

	Survey marker
	Wildlife Tree
	Bunker
	Communication Tower Fence
	ATV/Snowmobile Trail
	Transmission Line
	Green Paint Line
	Red Paint Line
	Double Sided Red Paint Line
	Blue Paint Line
	Intermittent Stream
	Wildlife Island DO NOT CUT
	Riparian Management Zone
	Section Corner



CLARK COUNTY FOREST
Firewood Permit Area 8-23
Pt. of NW 1/4 Section 2
Pt. of E 1/2 NE 1/4 Section 3
Township 24N Range 4W (Mentor)



Firewood Permit Area. May harvest trim, cull pieces, and non-merchantable logging debris. Do not cut any standing trees (alive or dead), pulpwood, logs, or downed timber 8 feet or longer.

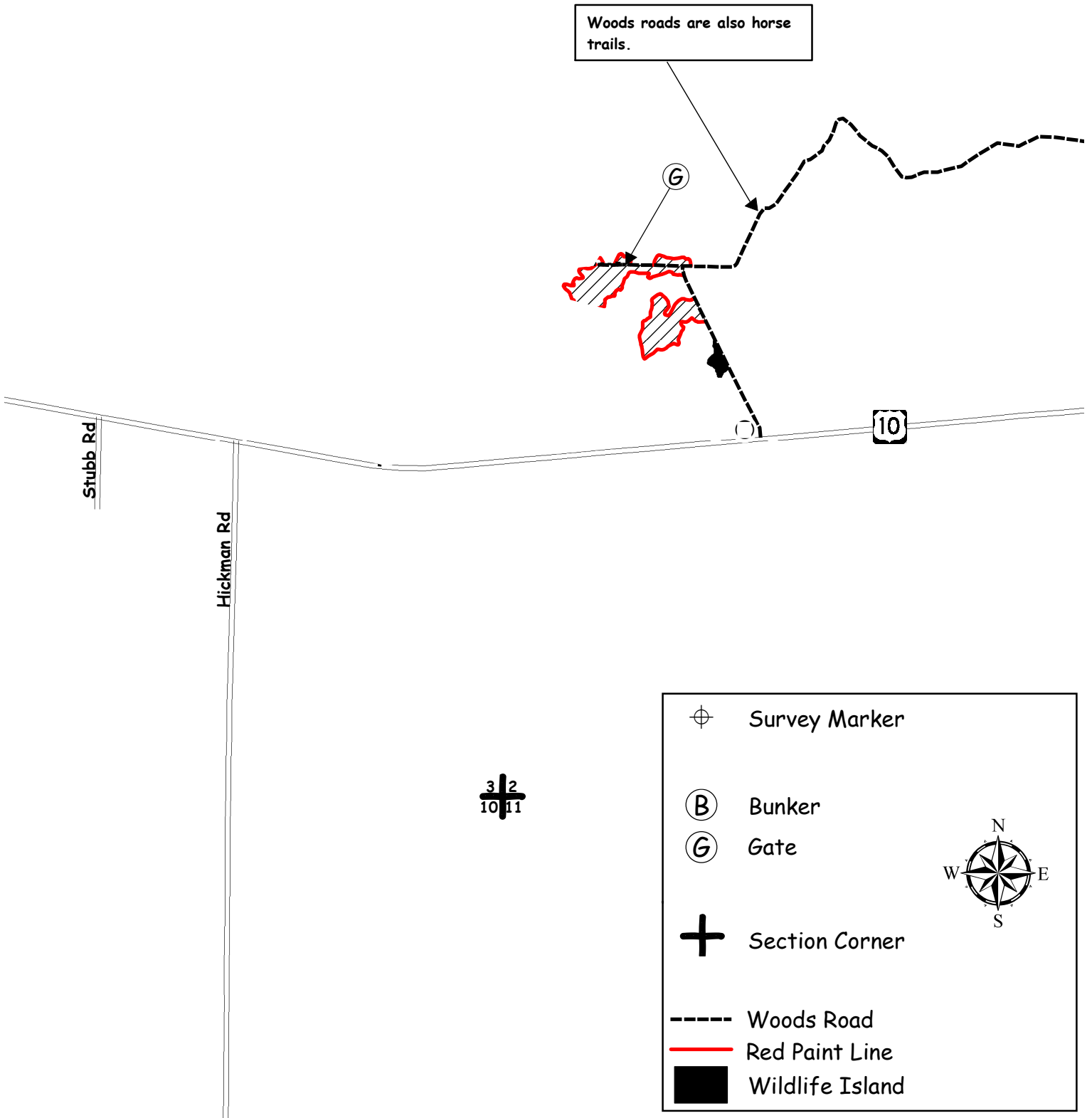

Woods roads are also horse trails.

G

10

Stubb Rd

Hickman Rd

32
1011

	Survey Marker
	Bunker
	Gate
	Section Corner
	Woods Road
	Red Paint Line
	Wildlife Island



CLARK COUNTY FOREST

Firewood Permit Area 9-23

Pt. of SESE Section 33

Township 25N Range 3W (Seif)



Firewood Permit Area. May harvest trim, cull pieces, and non-merchantable logging debris. Do not cut any standing trees (alive or dead), pulpwood, logs, or downed timber 8 feet or longer.



32 34
+
5 4

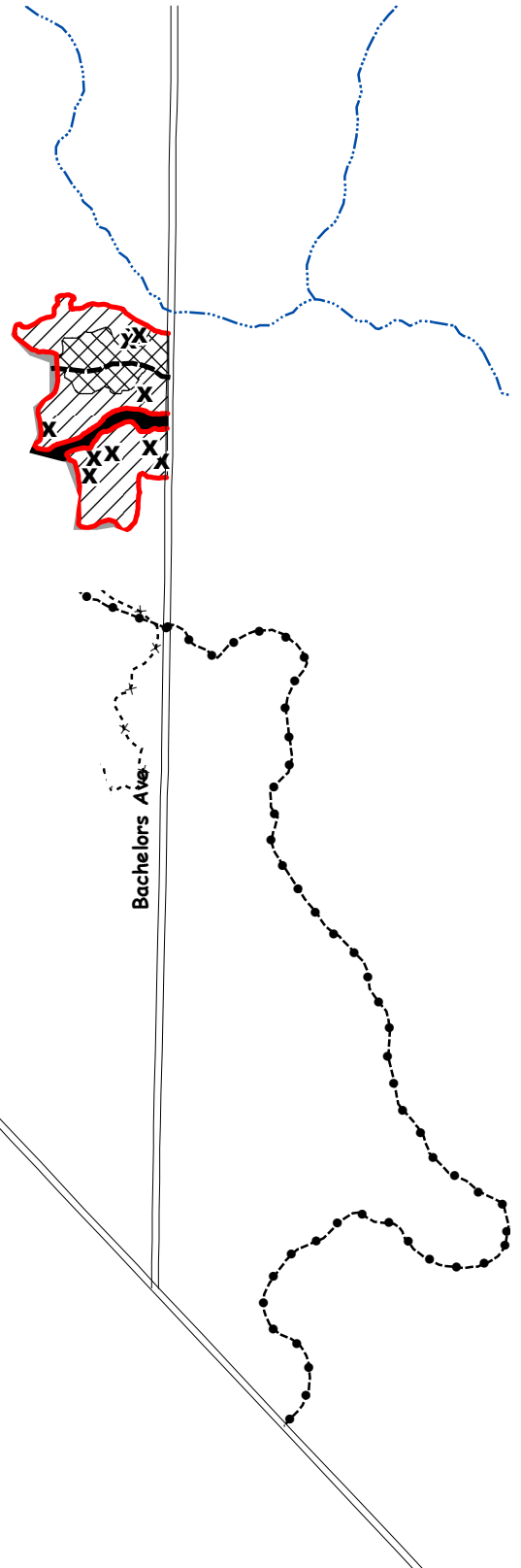

X Wildlife tree marked with green paint. DO NOT CUT

+ Section Corner

--- Intermittent Stream

x---x Motorcycle Trail marked with two rings of green paint.

●---● ATV/Snowmobile Trail

--- Woods Road

— Red Paint Line



■ Wildlife Islands (9 acres)

CLARK COUNTY FOREST

Firewood Permit Area 10-23

Pt. of SWNW, SWSW, SESW Section 14
Pt. of NENW, SWNE, SENE, NESE, SESE Section 23
Township 26N Range 4W (N. Foster)



Firewood Permit Area. May harvest trim, cull pieces, and non-merchantable logging debris. Do not cut any standing trees (alive or dead), pulpwood, logs, or downed timber 8 feet or longer.

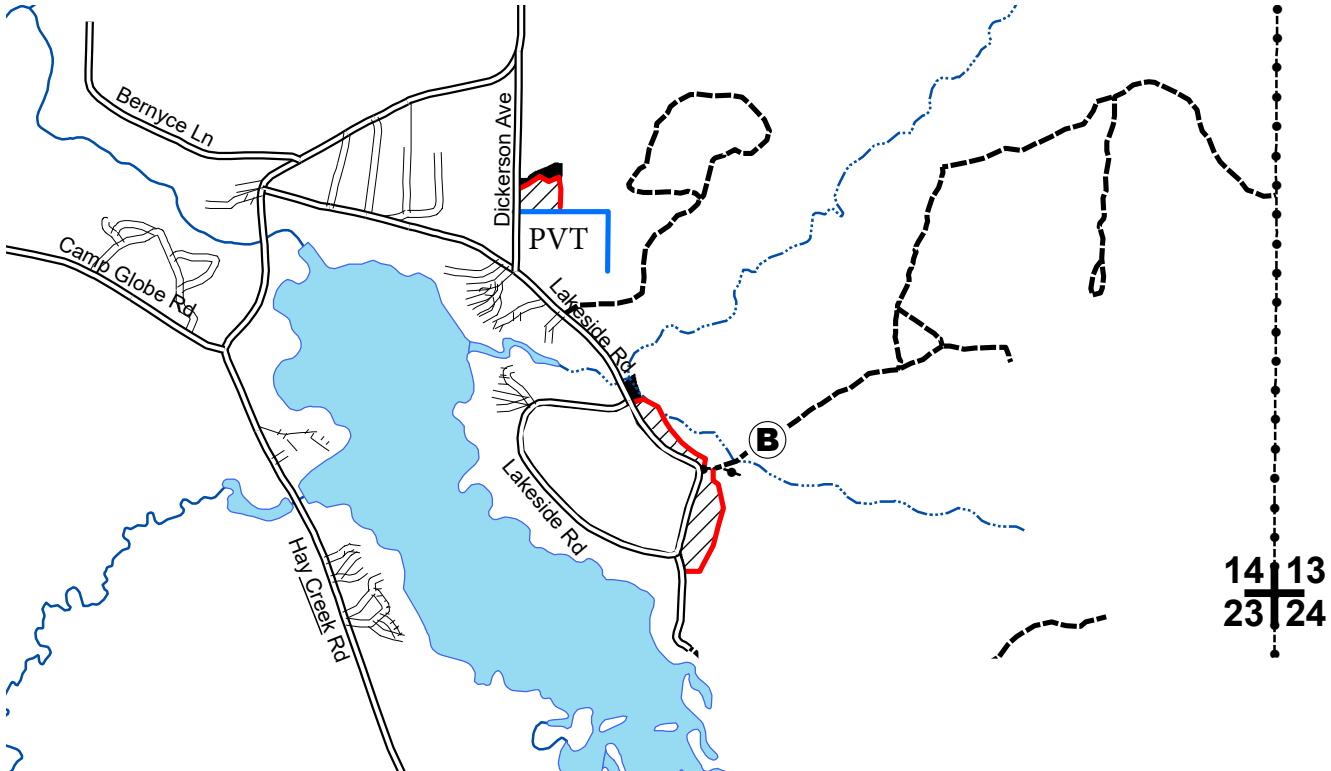

	Atv/Snowmobile Trail
	Woods Road
	Intermittent Stream
	Perennial Stream
	Red Paint Line
	Blue Paint Line
	Bunker
	Wildlife Island
	Section Corner



CLARK COUNTY FOREST
Firewood Permit Area 6-22
Pt. of SESE Section 23
Pt of S 1/2 SW 1/4 Section 24
Township 23N Range 01W (Washburn)

 Firewood Permit Area. May harvest trim, cull pieces, and non-merchantable logging debris. Do not cut any standing trees (alive or dead), pulpwood, logs, or downed timber 8 feet or longer.

